

1 April 2022 12:00:08 - Chick-fil-A\120005-01-049 (ENG) - Tucker, GA (Hugh Howell Rd) 120005A\Engineering\Exhibits\1-2 - CFA, Tucker, GA (Hugh Howell Rd) - Reseal Terrace Exhibit.dwg
THIS DOCUMENT, INCLUDING ALL CONTENTS AND DESIGNS PRESENTED HEREON, IS AN INSTRUMENT OF SERVICE, AS AN INSTRUMENT OF SERVICE, IS LIMITED IN SCOPE AND CANNOT BE REPRODUCED OR TRANSMITTED IN ANY FORM OR BY ANY MEANS, ELECTRONIC OR MECHANICAL, INCLUDING PHOTOCOPYING, RECORDING, OR BY ANY INFORMATION STORAGE AND RETRIEVAL SYSTEM, WITHOUT THE WRITTEN AUTHORIZATION AND APPROVAL OF BOWMAN CONSULTING GROUP, INC. CONSULTING ENGINEERS SHALL BE WITHOUT LIABILITY TO BOWMAN CONSULTING.

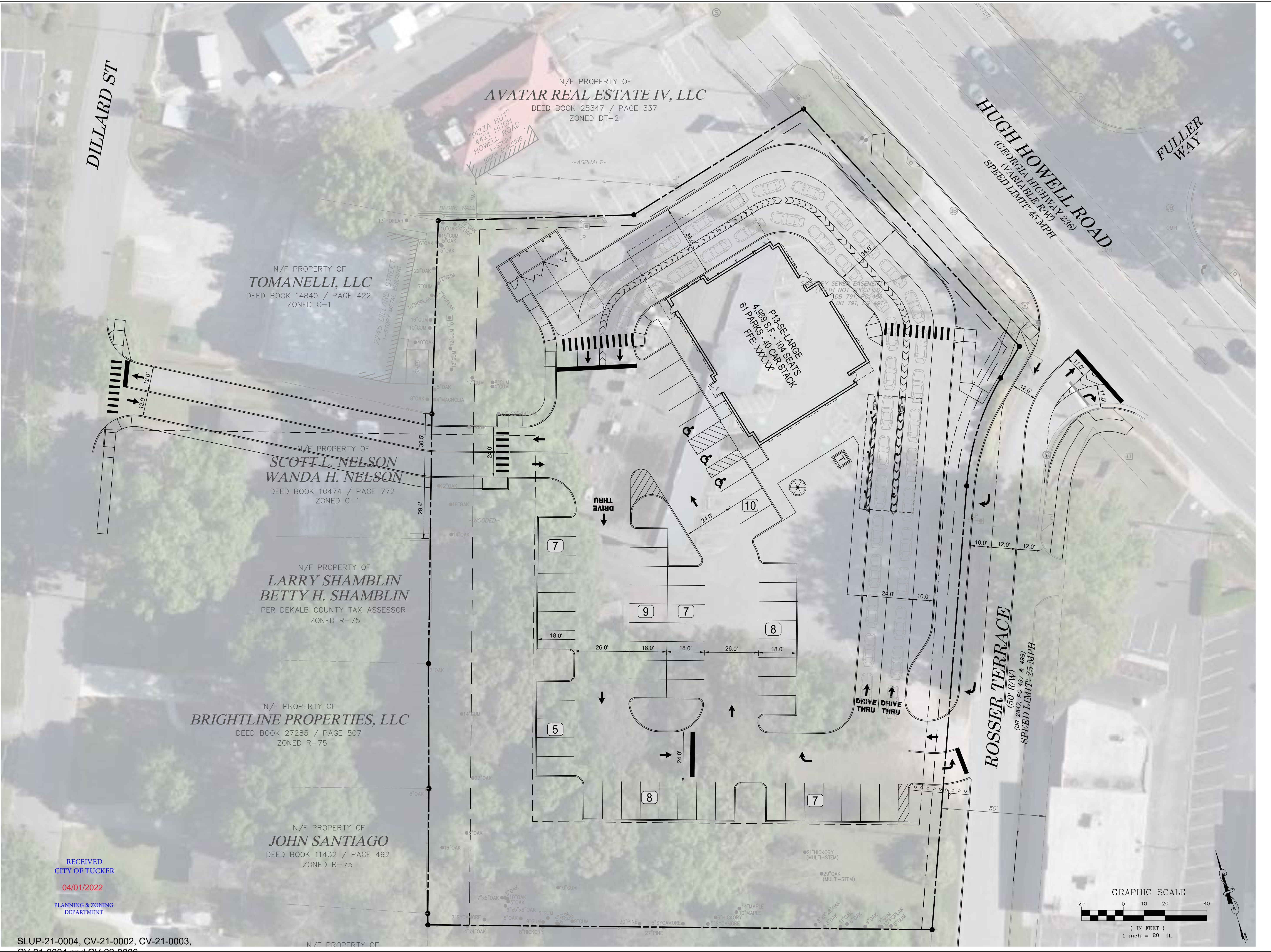

RECEIVED
CITY OF TUCKER
04/01/2022
PLANNING & ZONING
DEPARTMENT

SLUP-21-0004, CV-21-0002, CV-21-0003,
CV-21-0004 and CV-22-0006

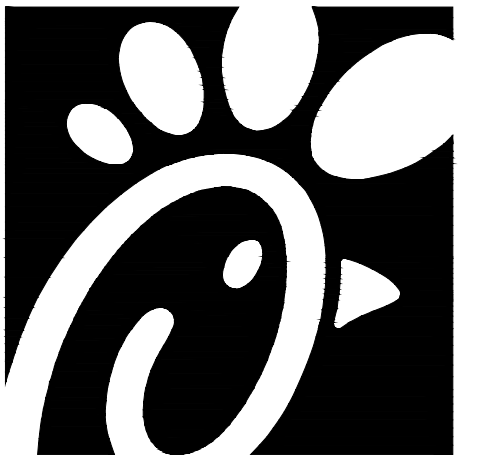

Chick-fil-A

Chick-fil-A
5200 BUFFINGTON RD
Atlanta, Georgia 30349-2998

Bowman
Certificate of Authorization License No. PEE 096735
950 North Point Parkway Suite 200
Atlanta, GA 30005
Phone: (678) 374-6687
www.bowmanconsulting.com
© Bowman Consulting Group, Inc.

CHICK-FIL-A
RELO TUCKER FSU
4435 HUGH HOWELL ROAD
TUCKER, GA 30084

FSU#04959
BUILDING TYPE / SIZE: P13-SE-LRG

REVISION SCHEDULE

NO.	DATE	DESCRIPTION
-----	------	-------------

CONSULTANT PROJECT # 120005-01-049

ISSUED FOR	PERMIT
DATE	April 1, 2022
DRAWN BY	BCG

Information contained on this drawing and in all digital files produced for above named project may not be reproduced in any manner without express written or verbal consent from authorized project representatives.

SHEET DILLARD ST
ACCESS EXHIBIT

SHEET NUMBER
EX-1.2