

CITY OF TUCKER

ACKNOWLEDGE RECEIPT OF ADDENDUM #2 FORM

ITB 2024-010

TUCKER TOWN GREEN CONSTRUCTION

Upon receipt, please print and add to your proposal.

I hereby acknowledge receipt of the supplement pertaining to the above referenced bid.

COMPANY NAME: _____

CONTACT PERSON: _____

ADDRESS: _____

CITY: _____ STATE: _____ ZIP: _____

PHONE: _____ FAX: _____

EMAIL ADDRESS: _____

SIGNATURE

DATE

ITB 2024-010
ADDENDUM #2

This addendum contains the following:

- Clarification about the compactor.
 - Please note: The compactor and the compactor remote power unit will be provided and installed by DeKalb County Sanitation.
- Clarification regarding ATT coordination:
 - Contractor is to install all underground conduit as seen on the concept drawing provided by AT&T (shown in dashed red). Contractor shall retain a design/build entity to finalize the design drawing and obtain formal acceptance from AT&T prior to construction activities. All work must be accepted by AT&T prior to city acceptance.
 - See attached ATT UTLP MARKUP Document
- Responses to Questions
- Revised drawings:
 - C1.01
 - C1.02
 - C7.11
 - L2.01
 - L2.02
 - L7.04

ITB 2024-010
ADDENDUM #2

	QUESTION	ANSWER
1	When referring to “Evaluation” in terms of the bid submittal, Is that an evaluation of form/scoring, or will it include reference and past performance?	Evaluation in terms of the bid submittal refers to reference checks and similar project assessment.
2	Do you have any planned design of fountains?	Yes – Please reference Sheets SB0.01-Sb1.02 AND WF0.1-WF6.0
3	Do we have to have CSX insurance because of the 50’ from middle of railroad?	Yes. Requirements stated in the bid package.
4	Will Railroad Avenue be open during construction?	Railroad Avenue will be closed for the duration of construction from west side of the gravel driveway to 2 nd Avenue and can be used for equipment staging.
5	Are any vibration testing required for the structures on the property?	This is in the geo-tech report. Stakes in the ground under the structures. Look for the Addendum Report under Settlement Monitoring, page 4. Bidders are responsible for this.
6	Will there be a Noise Ordinance that must be observed during construction?	The noise ordinance codes are in the bid manual.
7	On sheet C1.01, there are two (2) areas [8] Recreation Berms on the plan. What is the correct Recreation Berms area and what is the other area supposed to be labeled as?	Both areas are recreational berms. Please reference L2.01, L2.02, L7.04 and L7.05
8	Where are the Swing Pads located on the project plans?	Reference Sheet L2.01 (SF-102), and Detail 5/L7.03
9	Where are the Mountable Curb and Gutters located on the project plans?	Sheet C1.01 & C1.02 have been revised, see attachment within this addendum to address location of Mountable Curb in the southwest on Railroad Ave. & 2 nd St.
10	On sheet C1.01, there is an area labeled “Fall protection to be provided at proposed storm headwalls.” What are the details for this proposed Fall Protection?	Reference Detail #1 / C7.11 for fall protection to be installed in headwall, this was revised in this Addendum and attached.
11	On sheet C1.02, what are the striped hatched lines on the South side of Railroad Avenue supposed to be?	Roadway striping. Refer to GDOT T-14 Detail ‘C’ (White)
12	On sheet C1.02, there is an icon that looks like highway signage on the bottom right side of the page. Is this to	Sheet C1.01 & C1.02 have been revised, see attachment within this addendum to address signage that wasn’t labeled and additional signage added within this addendum.

ITB 2024-010
ADDENDUM #2

	be included in our scope of work? If so, what are its details?	
13	On sheet L2.01, there are two (2) different hatched areas labeled P-101. What are the correct areas for the light duty concrete finish and the correct areas for the light duty exposed aggregate finish?	Sheet L-2.01 & L2.02 have been revised see attachment within this addendum to address incorrect labels.
14	The match lines do not match up on any of the sheets. Can you provide an updated set of plans?	Match lines seem to be in the correct locations, but will work with the awarded bidder prior to construction to make sure.
15	It is unclear where the Brick Paver Band (2/L7.01) ends on the top right section of sheet L2.02. Could you clarify the limits of new construction?	Sheet L-2.01 & L2.02 have been revised see attachment within this addendum. Brick Paver Band should stop at existing path.
16	Under the Paving Materials schedule on plan sheet L7.00, it lists a line item titled "Top-Cast concrete pavement" but this is not on the plans. Also, with its detail not showing the complete page number but only 1/701. Where can we get more information on this item and its details?	Top Cast Concrete Detail – 1 / L7.01 Pavement reference on Sheet L2.01 and L2.02 is < P-102> (See hatch key at bottom of sheet)
17	Please provide details on the following questions. 1. Park Monument details.	1. Park Monument sign has been removed from the project. No details necessary.
18	2. Synthetic Turf under the concrete benches . - Will we be placing the turf under the concrete benches, or do we need to cut around them on L2.02? Please Provide more details on the Mounds and any alternate(Foam Mounds) are acceptable.	Concrete benches shall be placed on top of the synthetic turf. Mounds. See Detail – 3/L7.06 for mounding information.
19	What are the details for SF-105 shown on plan sheet L2.02?	There are no SF-105 Site Furnishings included in this project. Sheet L-2.01 & L2.02 have been revised see attachment within this addendum and callout has been revised to SF-108.
20	Detail #3 shown on plan sheet L7.04 has the perimeter of the climbing mound area as fall safety zone and outside its perimeter it shows it as Synthetic turf play area. However, the	The entire area is to be synthetic turf. Detail #3 Sheet L7.04 has been revised to add a 1" thick pad 6'x6'. Fall safety zone is an offset area (Min 6'-0") around all play equipment in which no hard fall surfaces are to be located.

ITB 2024-010
ADDENDUM #2

	details 3/L7.06 and 4/L7.05 have both these areas as synthetic turf. Is there to be any fall safety equipment or surfaces for these areas or is it all synthetic turf? If there is to be fall safety surfacing, what are the details?	
21	Is the site grading balanced?	The site is not balanced due to poor existing soil that will need to be removed. Refer to both Geotech reports in Addendum #1.
22	What are the milling limits?	Refer to Sheet C2.04, from Station 6+00 to the east.
23	Where does the bioretention and infiltration details occur? Details on 7.04?	Reference Sheet C2.00 for locations and C7.04 for details.
24	Where does the CXT R/W occur? Property line?	Assume CSX R/W from property line south of Railroad Ave.

DRAWING SUPPLIED BY AT&T FOR REFERENCE ONLY

C2.01

C2.02

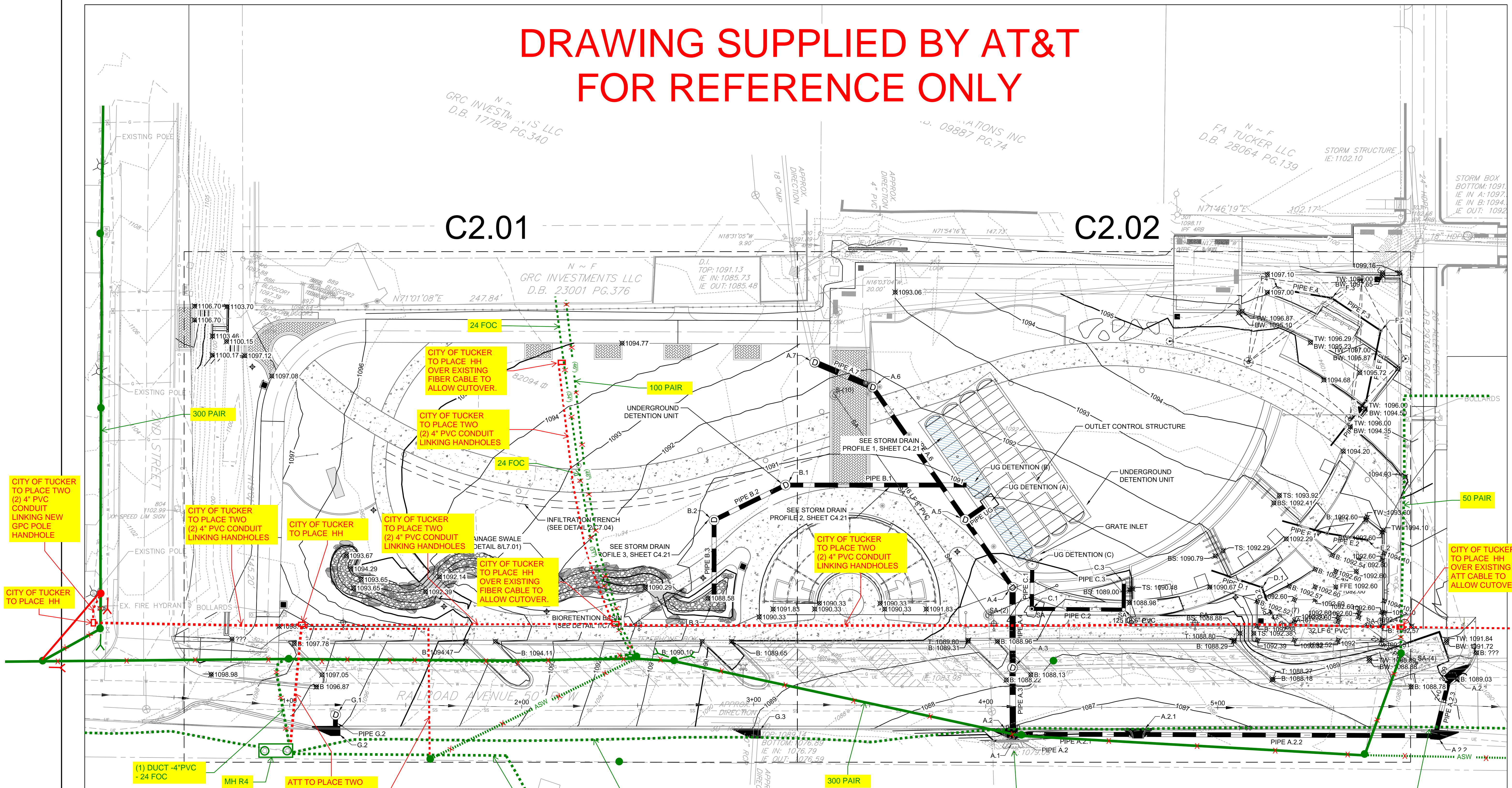

GRADING AND DRAINAGE NOTES

1. SEE SHEET C0.01 FOR ADDITIONAL GRADING AND DRAINAGE NOTES.
2. CONTRACTOR TO FIELD VERIFY LOCATIONS OF EXISTING UTILITIES PRIOR TO START OF CONSTRUCTION.
3. CONTRACTOR TO INSTALL STRUCTURE CASTINGS FLUSH WITH FINISHED GRADE.
4. ROOF DRAIN DOWNSPOUTS SPLASH ON GRADE. SEE ARCHITECTURAL PLANS FOR LOCATION AND ADDITIONAL INFORMATION.
5. STORM STRUCTURES SHALL COMPLY WITH DEKALB COUNTY DEVELOPMENT SPECIFICATIONS

ABBREVIATIONS

FFE	FINISHED FLOOR ELEVATION
HP	HIGH POINT
IE	INVERT ELEVATION
G	GUTTER
T	TOP OF CURB
B	BOTTOM OF CURB
TW	TOP OF WALL
BW	BOTTOM OF WALL
TS	TOP OF STAIRS
BS	BOTTOM OF STAIRS

CITY OF TUCKER TO PLACE ONE (1) 4" PVC CONDUIT LINKING HANDHOLE AND SERVICE POLE.

(1) DUCT -4" PVC -24 FOC

(15) DUCT -4" PVC -72 FOC
-216 FOC
-1800 PAIR
-432 FOC
-1500 PAIR
-144 FOC
-32 FOC
-24 FOC

ATT REQUESTS CITY OF TUCKER TO ADJUST PROPOSED STORM DRAIN AS NECESSARY TO PREVENT CONFLICT WITH ATT DUCT.

ATT REQUESTS CITY OF TUCKER TO ADJUST PROPOSED STORM DRAIN AS NECESSARY TO PREVENT CONFLICT WITH ATT DUCT.

LEGEND

- 465 — PROPOSED MINOR CONTOUR
- 465 — PROPOSED MAJOR CONTOUR
- ▲ 464 PROPOSED SPOT ELEVATION
- 465 — EXISTING MINOR CONTOUR
- 465 — EXISTING MAJOR CONTOUR

DASHED IS UNDERGROUND
SOLID IS OVERHEAD
GREEN IS ABANDONED
RED IS PROPOSED

811 Know what's below
Call before you dig.
811
www.call811.com

PRELIMINARY NOT FOR CONSTRUCTION	DATE
--	------

OVERALL GRADING & DRAINAGE PLAN
 CITY OF TUCKER
 TUCKER TOWN GREEN PARK
 4226 RAILROAD AVENUE, TUCKER, GEORGIA 30084

CITY OF TUCKER TO PLACE TWO (2) 4" PVC CONDUIT FROM HANDHOLE AND TURN ONE UP AT BASE OF EACH PROPOSED POWER POLE.

REV.	DR.	CHK.	DATE	DESCRIPTION

AT&T

Line #	Length	Direction
L1	54.651	N53° 49' 42.46"E
L2	58.542	S53° 49' 42.46"W
L3	1.995	N65° 37' 08.61"W
L4	412.834	N71° 14' 19.05"E
L5	9.001	N71° 14' 25.40"E
L8	53.527	N71° 14' 19.18"E

Line #/Curve #	Length	Direction/Delta	Radius
C1	184.947	060.5525	175.000
C2	200.106	071.6577	160.000
C3	39.231	033.5490	67.000
C4	64.904	055.5051	66.998
C5	44.607	038.1460	67.000
C6	50.053	022.4052	127.999
C7	33.445	014.9709	128.000
C8	109.512	087.1467	72.000
C9	35.436	015.8621	128.000
C10	15.266	011.2140	78.000
C11	8.756	006.4317	78.000
C12	20.002	011.1266	103.000
C13	76.608	042.6149	103.000
C14	8.241	004.5840	103.000
C15	37.366	020.7857	103.000

Line #/Curve #	Length	Direction/Delta	Radius
C16	5.277	030.8476	9.801
C17	8.754	025.1168	19.968

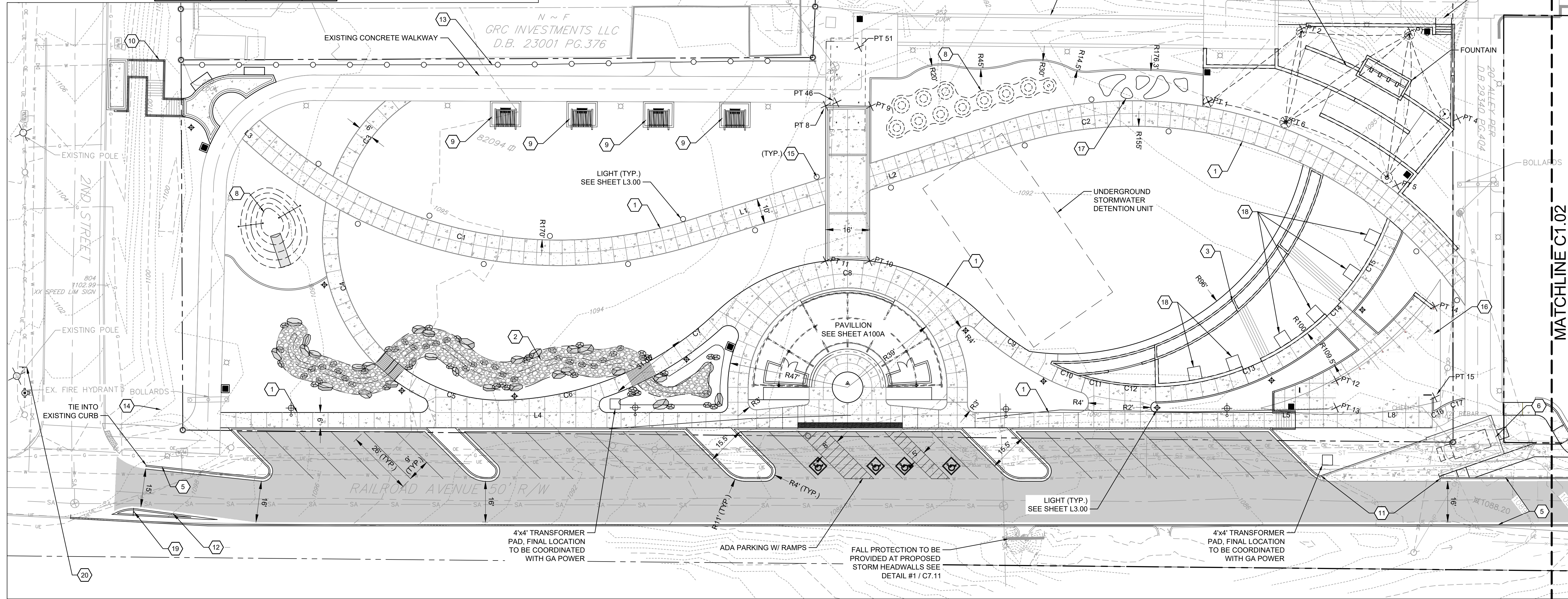

SITE KEYNOTES	
1	CONCRETE WALKWAY (SEE DETAIL 1/L7.01)
2	RIVER ROCK DRY STREAM (SEE DETAIL 8/L7.01)
3	WATER FEATURE (SEE SHEETS WF-0.1 - WF-6.0)
4	TERRACED ENTRY / DINING PLAZA WITH SHADE SAIL
5	CURB & GUTTER (SEE DETAIL 3/C7.04)
6	DUMPSTER PAD (SEE DETAIL 4/C7.03)
7	ADA CURB RAMP W/ DETECTIBLE WARNINGS (SEE DETAIL 5/C7.03)
8	RECREATION BERMS
9	SWING PAD
10	CONCRETE STAIRWAY (SEE DETAIL 1/L7.02)
11	CURB AND GUTTER TRANSITION (SEE DETAIL 2/C7.02)
12	MOUNTABLE CURB AND GUTTER (SEE DETAIL 4/C7.04)
13	WOODEN PRIVACY FENCE (SEE DETAIL 3/L7.06)
15	SITE LIGHTING (SEE SHEET E100)
16	RESTROOM FACILITY (SEE ARCHITECTURAL SHEETS)
17	MODERN CONCRETE BENCHES
18	TREE PIT
19	DO NOT ENTER SIGN
20	NO LEFT TURN SIGN MUTCD R3-2

Point #	Northing	Easting
1	1401466.1428	2281772.2648
2	1401504.9769	2281797.7021
3	1401517.7308	2281838.2984
4	1401491.4157	2281867.1862
5	1401459.0554	2281852.7940
6	1401468.3028	2281803.5405
8	1401416.3951	2281630.5539
9	1401421.9580	2281647.4623
10	1401364.2278	2281666.5438
11	1401358.6639	2281650.1637
12	1401378.6977	2281854.8941
13	1401368.7063	2281858.2879
14	1401418.6336	2281882.2093
15	1401384.9321	2281893.6569

Point #	Northing	Easting
16	1401335.2452	2281419.7987
17	1401334.4215	2281421.6161
18	1401352.5458	2281597.1422
19	1401384.8012	2281641.2596
20	1401395.5167	2281655.9157
21	1401430.0685	2281703.1740
22	1401431.1889	2281890.4876
23	1401223.2196	2281445.3279
24	1401355.9982	2281836.2262
25	1401358.8932	2281844.7499
26	1401376.1086	2281895.4319
27	1401379.5008	2281899.3905
28	1401385.0086	2281906.1039
29	1401316.9824	2281460.2211

Point #	Northing	Easting
30	1401266.5185	2281496.9180
31	1401262.7811	2281506.1933
32	1401263.8574	2281549.9676
33	1401289.9799	2281592.2899
34	1401297.0663	2281599.3456
35	1401324.3348	2281618.5462
36	1401356.2584	2281712.5290
37	1401346.0011	2281746.3302
38	1401345.1123	2281761.5462
39	1401345.9480	2281770.2574
40	1401350.8670	2281789.6130
41	1401400.1041	2281845.9951
42	1401407.5540	2281849.5120
43	1401443.8228	2281857.6096

Point #	Northing	Easting
44	1401327.3166	2281459.5276
45	1401364.2265	2281471.0722

SITE NOTES

- CONTRACTOR TO FIELD VERIFY LOCATIONS OF EXISTING UTILITIES PRIOR TO START OF CONSTRUCTION.
- CONTRACTOR TO PROVIDE SMOOTH, STRAIGHT SAW-CUT LINES ALONG ALL AREAS OF CURB AND PAVEMENT REMOVAL.
- CONTRACTOR TO PROTECT EXISTING IMPROVEMENTS WITHIN PROJECT AREA. ANY AREAS THAT BECOME DAMAGED DURING CONSTRUCTION ARE THE RESPONSIBILITY OF THE CONTRACTOR TO REPAIR.
- CONTRACTOR TO FIELD LOCATE ATT LINE. CONTACT UTILITY PROVIDER IF RELOCATION IS REQUIRED.
- CONTRACTOR IS TO REFERENCE UNITED CONSULTING GEOTECHNICAL EXPLORATION REPORT (10.23.2023) AND ADDENDUM #1 (03.18.2024) FOR THE TUCKER TOWN
- REFER TO GDOT T-3A FOR ALL SIGN HEIGHTS AND POSTS.

LEGEND

- CONCRETE SIDEWALK
- ASPHALT PAVEMENT
- CONCRETE PAVERS



SITE LAYOUT PLAN
CITY OF TUCKER
TUCKER TOWN GREEN PARK
 4236 RAILROAD AVENUE, TUCKER, GEORGIA 30084

REV.	OR.	CHK.	DATE	DESCRIPTION
0	RAH	RAH	05/21/2024	ISSUED FOR BID
1	RAH	RAH	06/14/2024	ADDENDUM #2

C1.01
 PROJ. NO. : 3808805

USER: GHEMCKE
 FILE: F:\3808805\3808805004_CAD\CIVIL\LOT\3808805_C1.01 - Site Layout Plan-Addendum 02.dwg
 SAVED: 05/14/2024
 PLOTTED: 05/14/2024

USER: C:\GHEMCKE
 FILE: 381808805_380880504_CAD\CIVIL\PL\LOT3808805_C1.01 - Site Layout Plan-Addendum 02.dwg
 SAVER: 05/14/2024
 PLOTTED: 05/14/2024

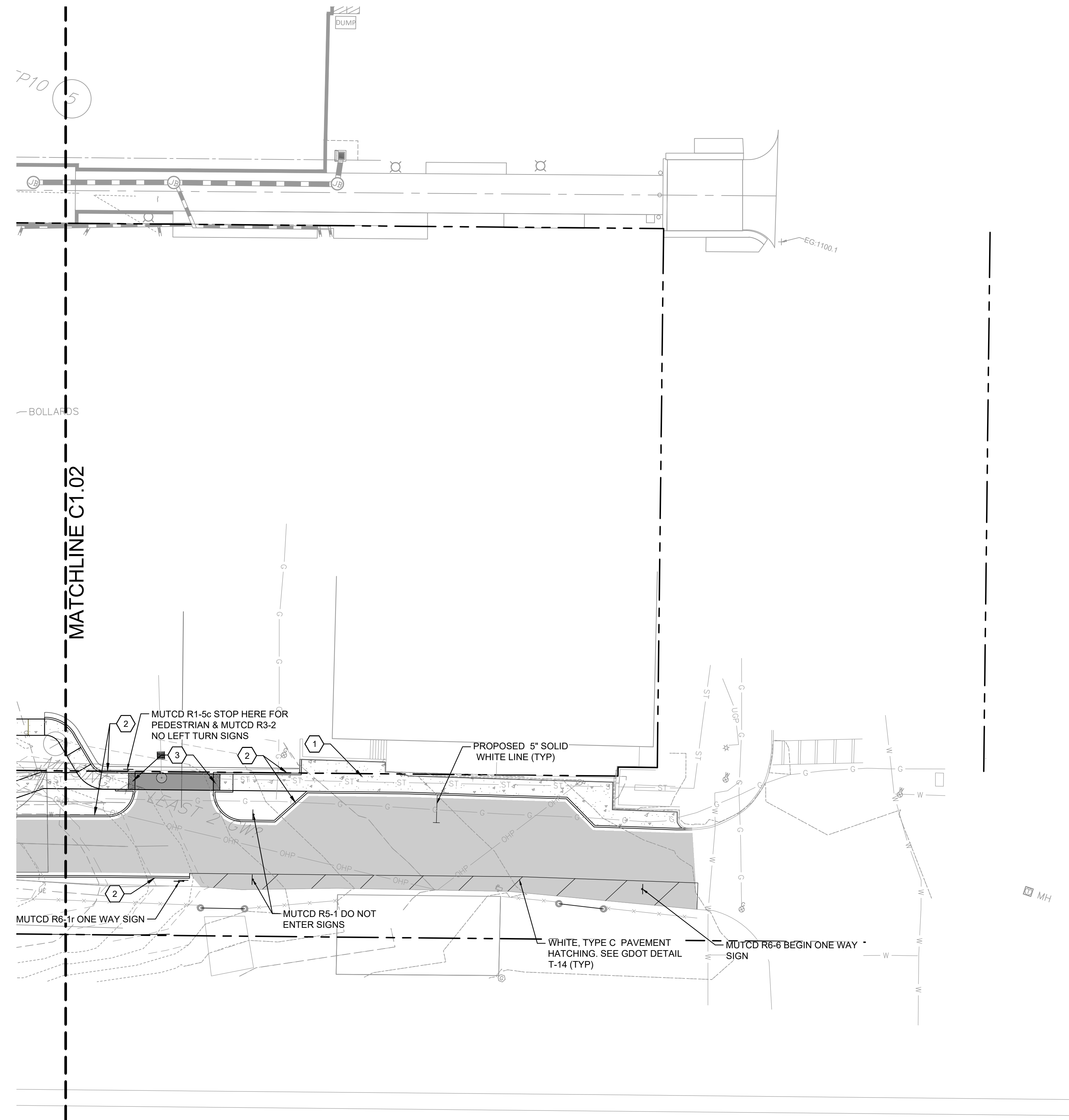

SITE KEYNOTES

1	CONCRETE WALKWAY (SEE DETAIL 1/L7.01)
2	CURB & GUTTER
3	ADA CURB RAMP W/ DETECTIBLE WARNINGS (SEE DETAIL 5/C7.03)

SITE NOTES

- CONTRACTOR TO FIELD VERIFY LOCATIONS OF EXISTING UTILITIES PRIOR TO START OF CONSTRUCTION.
- CONTRACTOR TO PROVIDE SMOOTH, STRAIGHT SAW-CUT LINES ALONG ALL AREAS OF CURB AND PAVEMENT REMOVAL.
- CONTRACTOR TO PROTECT EXISTING IMPROVEMENTS WITHIN PROJECT AREA. ANY AREAS THAT BECOME DAMAGED DURING CONSTRUCTION ARE THE RESPONSIBILITY OF THE CONTRACTOR TO REPAIR.
- CONTRACTOR TO FIELD LOCATE ATT LINE, CONTACT UTILITY PROVIDER IF RELOCATION IS REQUIRED.
- CONTRACTOR IS TO REFERENCE UNITED CONSULTING GEOTECHNICAL EXPLORATION REPORT (10.23.2023) AND ADDENDUM #1 (03.18.2024) FOR THE TUCKER TOWN.
- REFER TO GDOT T-3A FOR ALL SIGN HEIGHTS AND POSTS.

LEGEND

	CONCRETE SIDEWALK
	ASPHALT PAVEMENT
	CONCRETE PAVERS

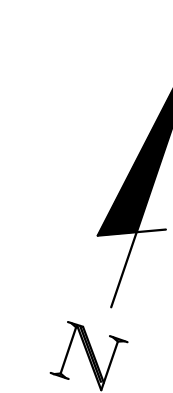

811 Know what's below
 Call before you dig.
 811
 www.call811.com



REV.	DR.	CHK.	DATE	DESCRIPTION
0	CVE	RC	06/14/2024	ISSUED FOR BID ADDENDUM #2

C1.02

PROJ. NO. : 3808805

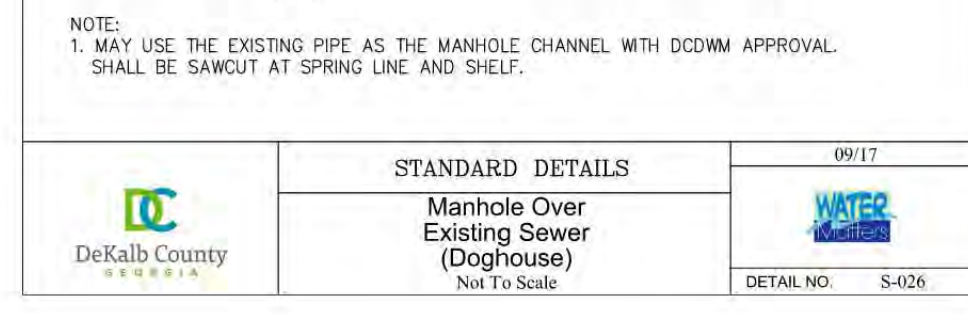
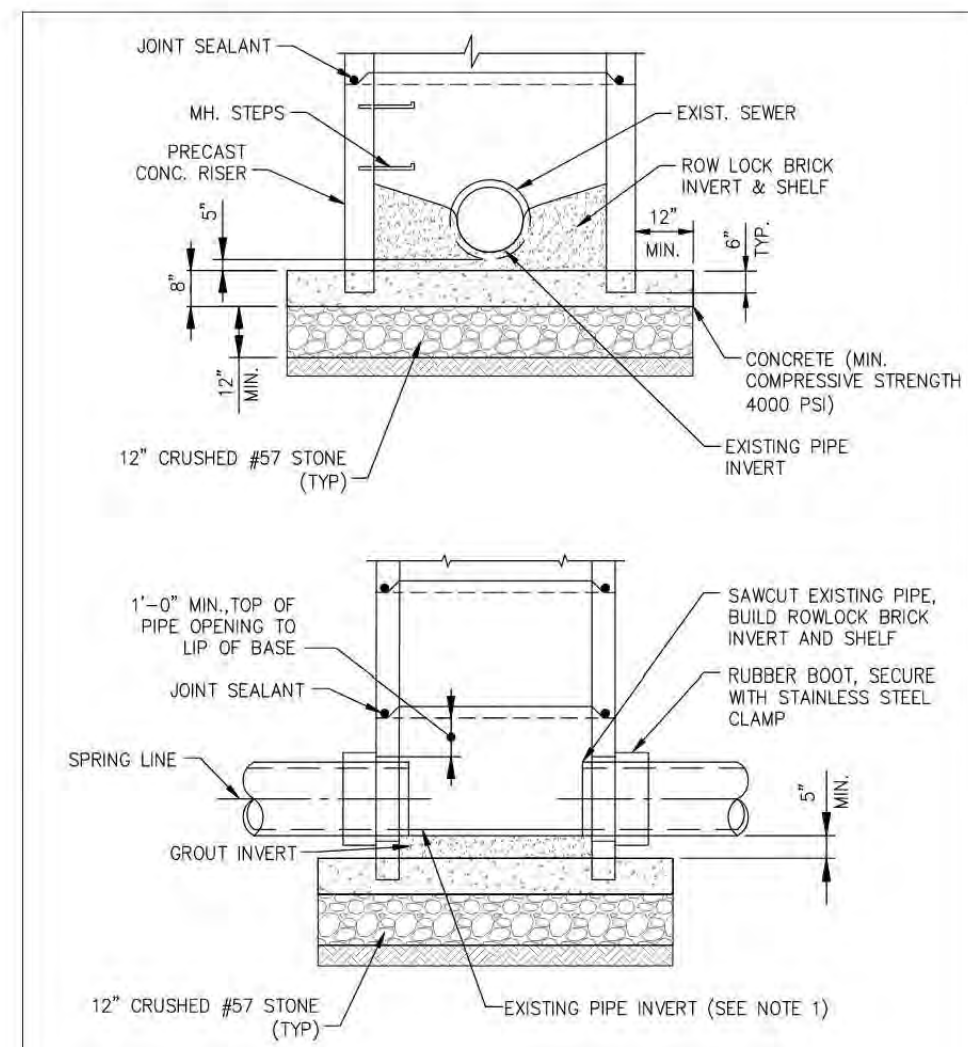

NOTE:
1. MAY USE THE EXISTING PIPE AS THE MANHOLE CHANNEL WITH DCDMM APPROVAL. SHALL BE SAWCUT AT SPRING LINE AND SHELF.

	STANDARD DETAILS	09/17
	Manhole Over Existing Sewer (Doghouse) Not To Scale	
DETAIL NO. S-026		

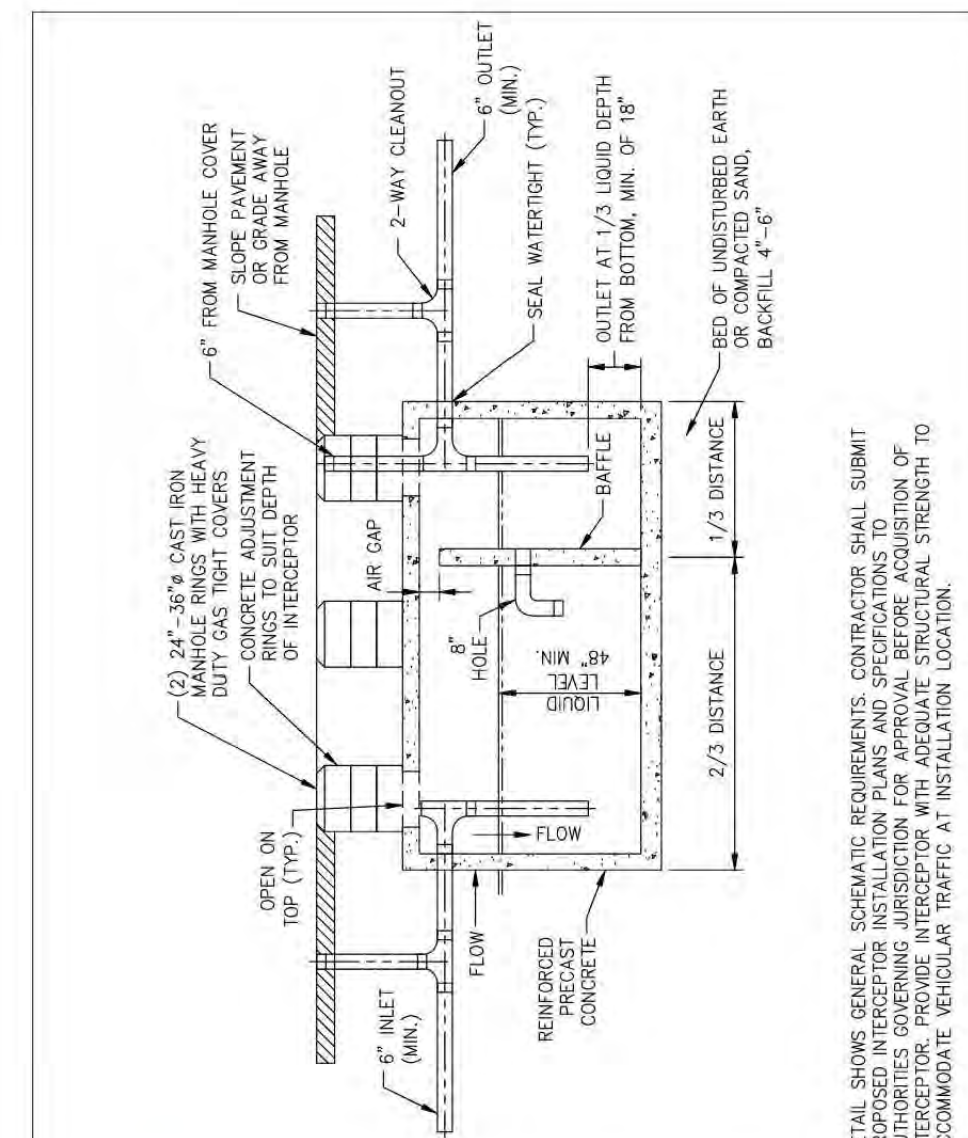

	STANDARD DETAILS	09/17
	Precast Concrete Fat, Oil & Grease Interceptor 1000, 1500 & 2000 GAL. CAPACITY Not To Scale	
DETAIL NO. S-021		

DETAIL SHOWS GENERAL SCHEMATIC REQUIREMENTS. CONTRACTORS SHALL SUBMIT PROPOSED INTERCEPTOR INSTALLATION PLANS AND SPECIFICATIONS TO THE MANHOLE MANUFACTURER FOR APPROVAL. THE MANHOLE MANUFACTURER SHALL PROVIDE INTERCEPTOR WITH ADEQUATE STRUCTURAL STRENGTH TO ACCOMMODATE VEHICULAR TRAFFIC AT INSTALLATION LOCATION.

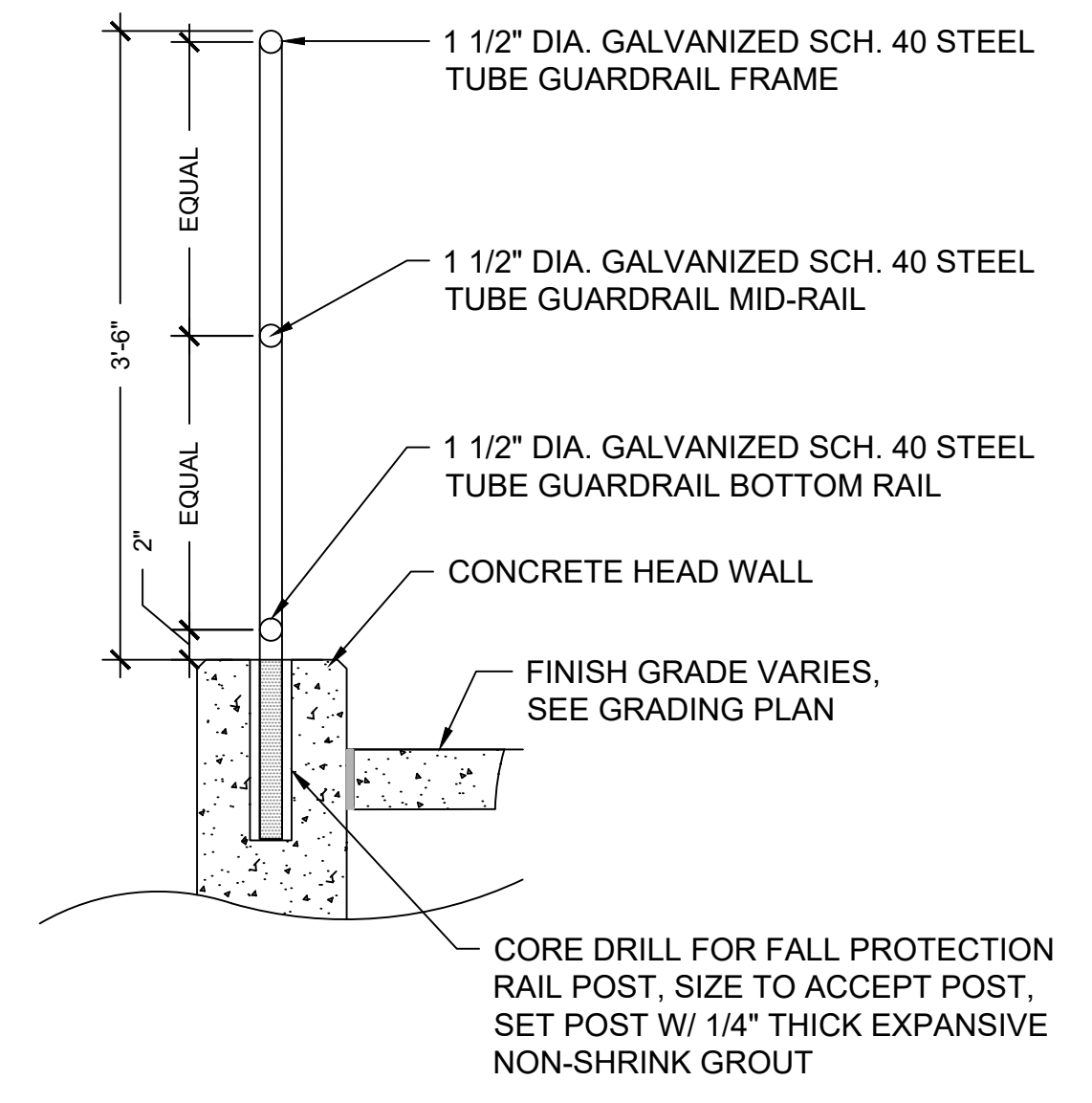

FALL PROTECTION RAIL NOTES:

- CONTRACTOR SHALL SUPPLY SHOP DRAWINGS FOR OWNER'S REPRESENTATIVE'S APPROVAL
- ALL CORNERS TO HAVE MIN. 4" RADIUS
- RAILS SHALL BE 1 1/2" DIAMETER SCHEDULE 40
- GRIND ALL WELDS SMOOTH W/ NO BARBS
- RAILS SHALL BE SHOP PRIMED WITH 1 COAT OF SHERWIN WILLIAMS KEM KROMIK UNIVERSAL METAL PRIMER B50NZ6. PRIME PER THE MANUFACTURER'S MAXIMUM RECOMMENDED SPREAD RATE PER COAT.
- RAILS SHALL BE PAINTED BLACK WITH 2 COATS OF SHERWIN WILLIAMS INDUSTRIAL ENAMEL PAINT B54B11. PAINT PER THE MANUFACTURER'S MAXIMUM RECOMMENDED SPREAD RATE PER COAT.
- INTERMEDIATE SUPPORT POSTS SHALL BE 5' O.C. MAX, AND UNIFORMLY SPACED.
- TOP OF GROUT FOR POST SHALL BE ABOVE PAVEMENT LEVEL AND SLOPED TO SHED WATER AWAY FROM POST. GROUT SHALL MATCH THE FINISH GRADE COLOR.

1 FALL ZONE PROTECTION RAIL
SCALE: N.T.S.

DEKALB STANDARD DETAILS
CITY OF TUCKER
TUCKER TOWN GREEN PARK
4236 RAILROAD AVENUE, TUCKER, GEORGIA 30084

REV.	OR	CHK.	DATE	DESCRIPTION
0	RAH	RAH	05/21/2024	ISSUED FOR BID
	CVE	RC	06/14/2024	ADDENDUM #2

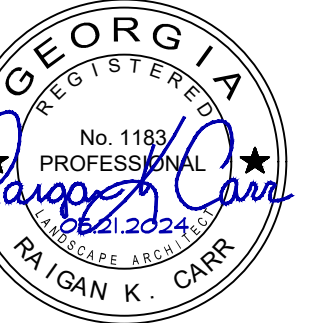

SITE MATERIALS AND FURNISHING PLAN

CITY OF TUCKER
TUCKER TOWN GREEN PARK
4236 RAILROAD AVENUE, TUCKER, GEORGIA 30084

REV.	OR.	CHK.	DATE	DESCRIPTION
0	ND	JS	05/21/2024	ISSUED FOR BID
	CV	PC	06/14/2024	ADDENDUM #2

L2.01

PROJ. NO. : 3808805

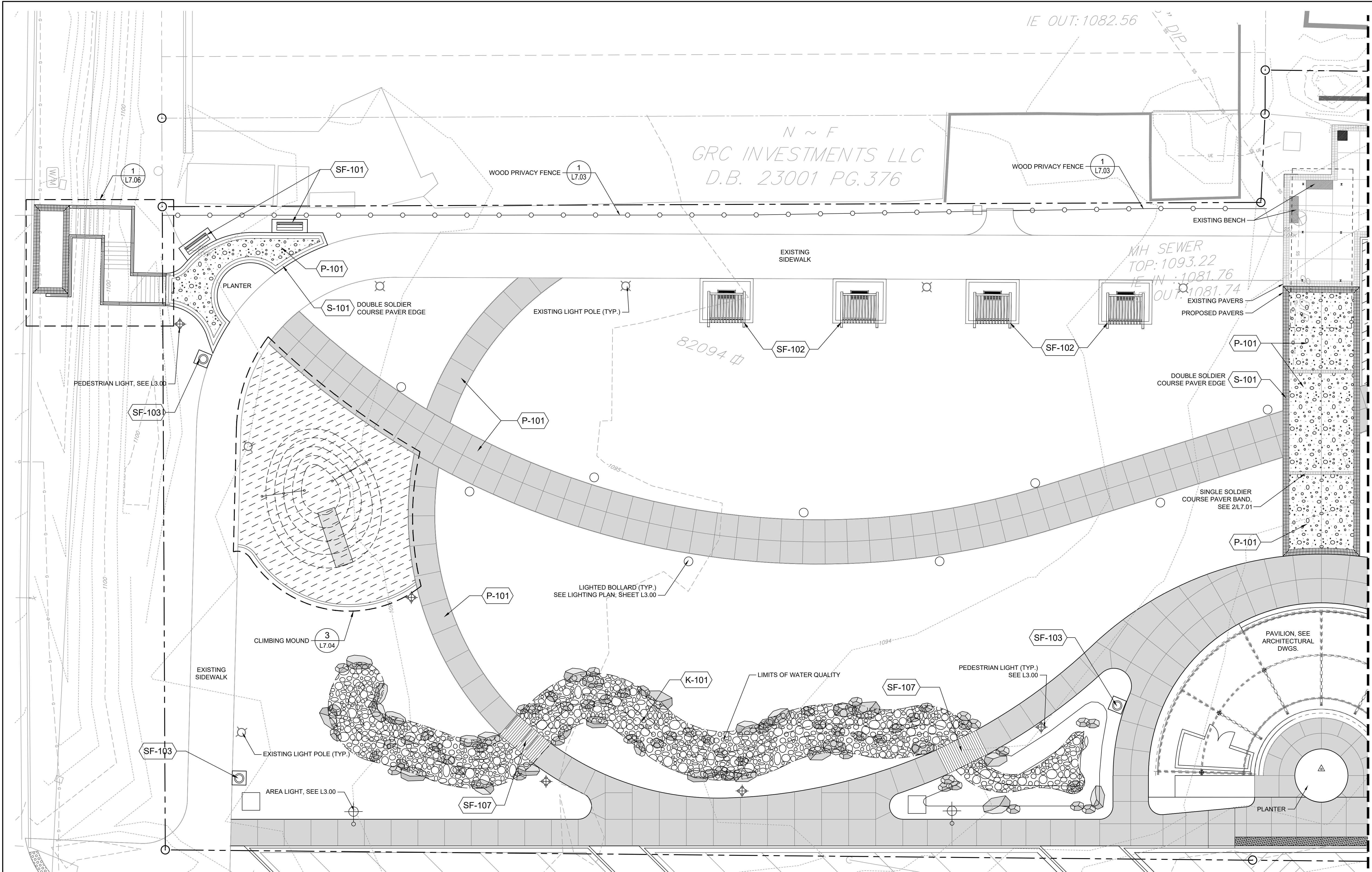

SITE MATERIALS LEGEND

SYMBOL	ROCK DESCRIPTION	DETAIL
(K-101)	DRY STREAM BED	8/L7.01
SYMBOL	CONCRETE DESCRIPTION	DETAIL
(P-101)	LIGHT DUTY CONCRETE LIGHT BROOM FINISH	1/L7.01
(P-102)	LIGHT DUTY CONCRETE EXPOSED AGGREGATE FINISH	

SITE FURNISHING LEGEND

SYMBOL	SURFACE MATERIALS DESCRIPTION	DETAIL
(S-101)	BRICK PAVER BAND	2/L7.01 OR 3/L7.01
(S-102)	PERVIOUS PAVERS	2/L7.03
SYMBOL	SYNTHETIC SURFACE DESCRIPTION	DETAIL
(T-101)	SYNTHETIC TURF	3/L7.05

SITE FURNISHING LEGEND

(SF-101)	STANDARD BENCH	1/L7.02
(SF-102)	ARBOR SWING	5/L7.03
(SF-103)	WASTE RECEPTACLE	3/L7.02
(SF-104)	BIKE RACK	2/L7.02
(SF-106)	SHADE SAILS	1/L7.04
(SF-107)	BOARDWALK	4/L7.02
(SF-108)	MODERN CONCRETE BENCH	

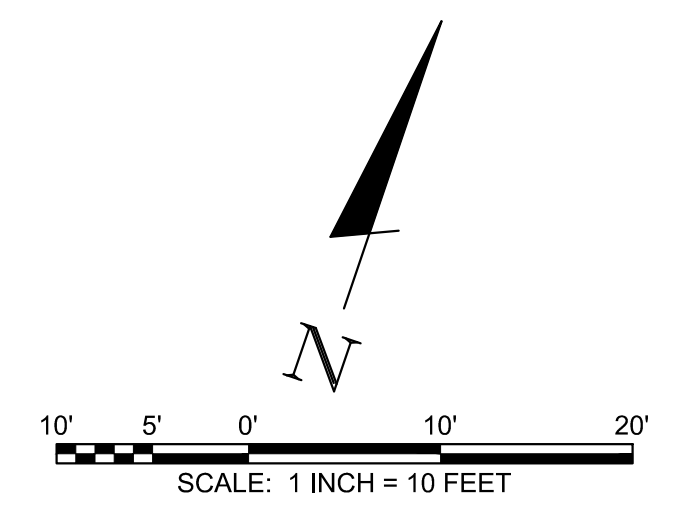

811 Know what's below
Call before you dig.
811
www.call811.com

USER: OVERMCKE
FILE: F:\3808805\380880504_CAD\LANDPLOT\L2.01_MATERIALS AND FURNISHINGS.dwg
SAVED: 05/12/2024
PLOTTED: 05/14/2024

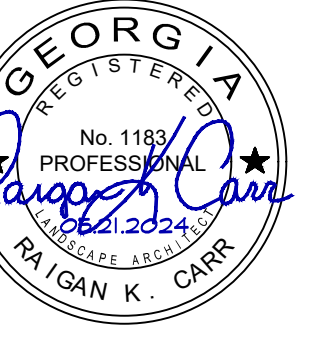

SITE MATERIALS AND FURNISHING PLAN

CITY OF TUCKER
TUCKER TOWN GREEN PARK
4236 RAILROAD AVENUE, TUCKER, GEORGIA 30084

REV.	OR.	CHK.	DATE	DESCRIPTION
0	ND	JS	05/21/2024	ISSUED FOR BID
	CV	PC	06/14/2024	ADDENDUM #2

L2.02

PROJ. NO. : 3808805

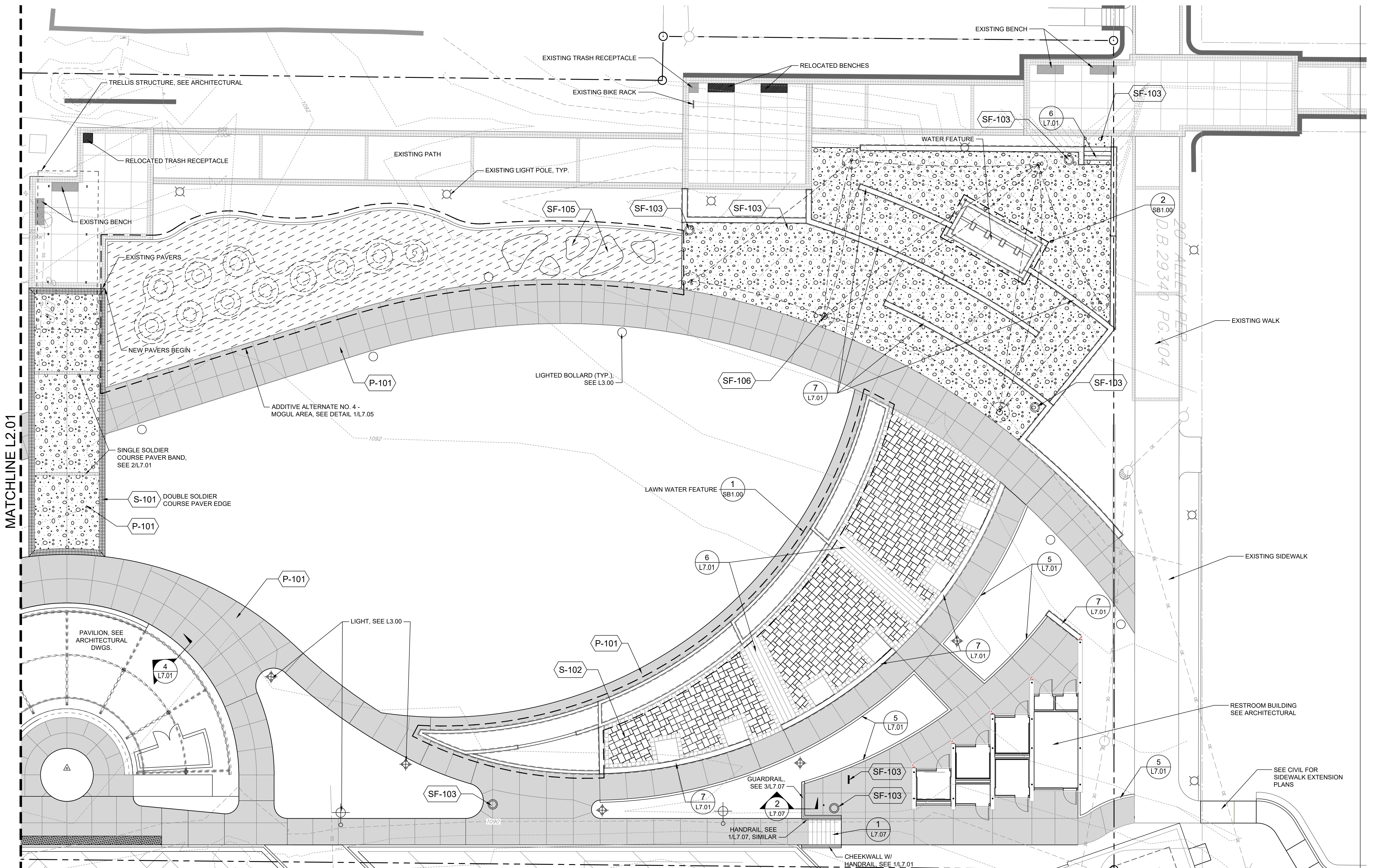

SITE MATERIALS LEGEND

SYMBOL	ROCK DESCRIPTION	DETAIL
	DRY STREAM BED	8/L7.01
SYMBOL	CONCRETE DESCRIPTION	DETAIL
	LIGHT DUTY CONCRETE LIGHT BROOM FINISH	1/L7.01
	LIGHT DUTY CONCRETE EXPOSED AGGREGATE FINISH	

SITE FURNISHING LEGEND

SYMBOL	SURFACE MATERIALS DESCRIPTION	DETAIL
	BRICK PAVER BAND	2/L7.01 OR 3/L7.01
	PERVIOUS PAVERS	2/L7.03
SYMBOL	SYNTHETIC SURFACE DESCRIPTION	DETAIL
	SYNTHETIC TURF	3/L7.05

	STANDARD BENCH	1/L7.02
	ARBOR SWING	5/L7.03
	WASTE RECEPTACLE	3/L7.02
	BIKE RACK	2/L7.02
	SHADE SAILES	1/L7.04
	BOARDWALK	4/L7.02
	MODERN CONCRETE BENCH	

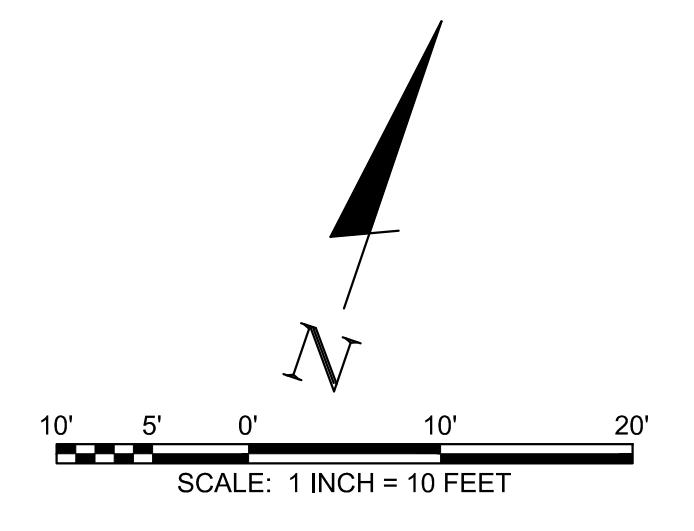

IMPORTANT: The footings sizes provided are estimated only. Depending on local conditions, actual engineered concrete footings may be substantially larger than estimates provided herein. Shade Systems is not responsible for actual engineered footings sizes differing from the estimates given or for any additional concrete installation costs which may be incurred by you as a result thereof.

GENERAL NOTES:

- THE SHADE SYSTEM SHALL BE INSTALLED IN ACCORDANCE WITH THE SH-1000 CODE WITH AN APPROVED SH-1000 COORDINATOR AND SHALL BE TO THE FOLLOWING SPECIFICATIONS:
- THE CONTRACTOR SHALL BE RESPONSIBLE FOR OBTAINING ALL NECESSARY PERMITS AND APPROVALS FROM ALL APPLICABLE AGENCIES.
- ALL PARTS SHALL BE NEW UNLESS OTHERWISE SPECIFIED.
- ALL WELDS SHALL BE MADE BY A WELDER WHO IS LICENSED IN THE STATE OF FLORIDA AND SHALL BE WELDED TO THE MANUFACTURER'S SPECIFICATIONS.
- ALL WELDS SHALL BE MADE WITH A MINIMUM PENETRATION THROUGH THE JOINTS AND SHALL BE WELDED TO THE MANUFACTURER'S SPECIFICATIONS.
- ALL WELDS SHALL BE MADE WITH A MINIMUM PENETRATION THROUGH THE JOINTS AND SHALL BE WELDED TO THE MANUFACTURER'S SPECIFICATIONS.
- ALL WELDS SHALL BE MADE WITH A MINIMUM PENETRATION THROUGH THE JOINTS AND SHALL BE WELDED TO THE MANUFACTURER'S SPECIFICATIONS.
- ALL WELDS SHALL BE MADE WITH A MINIMUM PENETRATION THROUGH THE JOINTS AND SHALL BE WELDED TO THE MANUFACTURER'S SPECIFICATIONS.
- ALL WELDS SHALL BE MADE WITH A MINIMUM PENETRATION THROUGH THE JOINTS AND SHALL BE WELDED TO THE MANUFACTURER'S SPECIFICATIONS.
- ALL WELDS SHALL BE MADE WITH A MINIMUM PENETRATION THROUGH THE JOINTS AND SHALL BE WELDED TO THE MANUFACTURER'S SPECIFICATIONS.

STEEL COLUMN	FOOTER	ANCHOR BOLT SIZE	ANCHOR BOLT LENGTH	NUMBER OF ANCHOR BOLTS
C1/F1	20" DIA. X 37.5" WALL	5/8"	1-1/2'	36"
C2/F2	8-5/8" DIA. X 32.2" WALL	48" Ø	84"	1"Ø
C3/F3	8-5/8" DIA. X 32.2" WALL	48" Ø	90"	1"Ø
C4/F4	10-3/4" DIA. X 36.5" WALL	48" Ø	126"	1"Ø
C5/F5	8-5/8" DIA. X 32.2" WALL	48" Ø	78"	1"Ø
C6/F6	16" DIA. X 37.5" WALL	5/8"	1-1/2'	36"

NOTE TO OWNER:
OWNER ACCEPTS FULL RESPONSIBILITY FOR REMOVING THE FABRIC SHADE MATERIAL FROM THE STEEL FRAME WHEN SEVERE WEATHER CONDITIONS ARE PREDICTED. UNDER CONDITIONS EXCESSIVE WIND SPEEDS IN EXCESS OF 60 MPH, AS STRUCTURE IS NOT DESIGNED FOR ANY SNOW LOAD, IT IS RECOMMENDED THAT FABRIC BE REMOVED WHEN SNOWFALL IS EXPECTED.

Shade Systems
4150 S.W. 19 Street
Ocala, FL 34474
Tel: 1-800-409-8088

**Tucker Town Green Park
Tucker, GA**

Model Name: CUSTOM SAIL SHADE SYSTEM STRUCTURE
Model No.: SAIL

Approved: JRB
Checked: MP
Drawn: JRB
Date: 12/19/2023
NOT TO SCALE

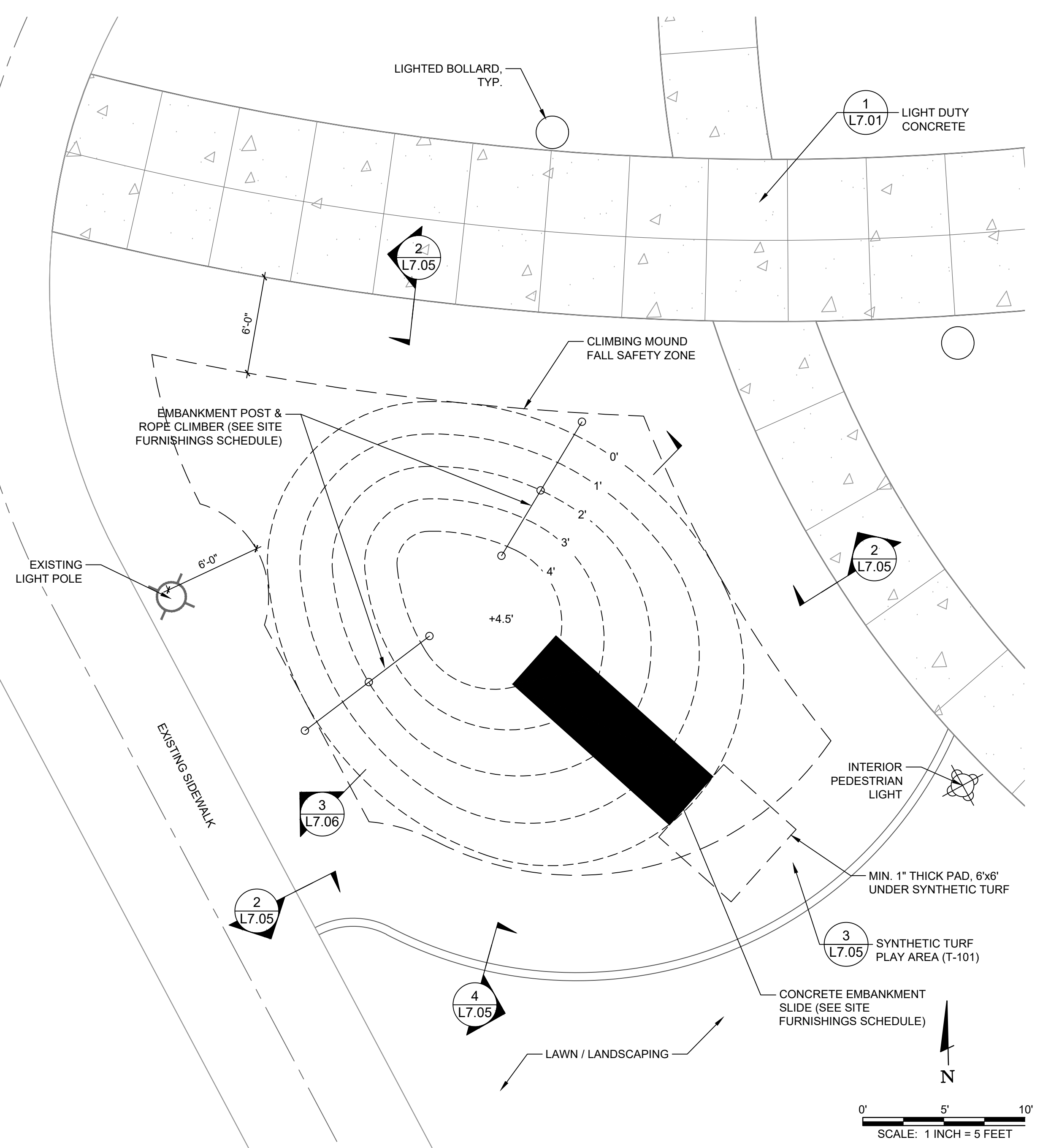

1 ADDITIVE ALTERNATE NO. 1 - SHADE SAILS
SCALE: N.T.S.

ADDITIVE ALTERNATE NO. 1 NOTES:

- ADDITIVE ALTERNATE NO. 1 SHALL INCLUDE ALL WORK AND MATERIALS ASSOCIATED WITH THE ABOVE GROUND IMPROVEMENTS FOR THE SHADE SAIL STRUCTURES, INCLUDING, BUT NOT LIMITED TO SUPPORT POSTS, SAILS, HARDWARE & FASTENERS, AND LIGHTING.
- SHADE SAIL FOUNDATIONS AND ELECTRICAL CONDUIT SHALL BE INCLUDED IN THE BASE BID.

3 ADDITIVE ALTERNATE NO. 3 - CLIMBING MOUND
1" = 5'-0"

ADDITIVE ALTERNATE NO. 3 NOTES:

- ADDITIVE ALTERNATE NO. 3 SHALL INCLUDE ALL WORK AND MATERIALS ASSOCIATED WITH THE CLIMBING MOUND CONSTRUCTION, INCLUDING BUT NOT LIMITED TO THE MOUND STRUCTURE, SYNTHETIC TURF & BASE, CONCRETE CURB/EDGE, CONCRETE SLIDE, AND CLIMBING ROPES.
- CLIMBING MOUND LAYOUT AND ASSOCIATED EQUIPMENTS ARE SHOWN FOR INTENT ONLY. CLIMBING MOUND SHALL BE APPROX. 5' HIGH WITH A CONCRETE EMBANKMENT SLIDE AND (2) POST & ROPE CLIMBING LADDERS. CONTRACTOR SHALL SUBMIT SHOP DRAWINGS OF CLIMBING MOUND AND EQUIPMENT WITH SPECIFIED MATERIALS, SIZES, SPACING AND LAYOUT, AND SIZING AND LOCATIONS FOR ALL STRUCTURAL ELEMENTS FOR REVIEW.
- INSTALL PRE-ENGINEERED STRUCTURES TO COMPLY WITH MANUFACTURER'S INSTALLATION DETAILS TO MAINTAIN WARRANTY AS SPECIFIED.
- SYNTHETIC TURF SYSTEM SHALL BE SUITABLE FOR OR DESIGNED FOR PLAYGROUND USE AND SHALL PROVIDE NECESSARY FALL SAFETY REQUIREMENTS.

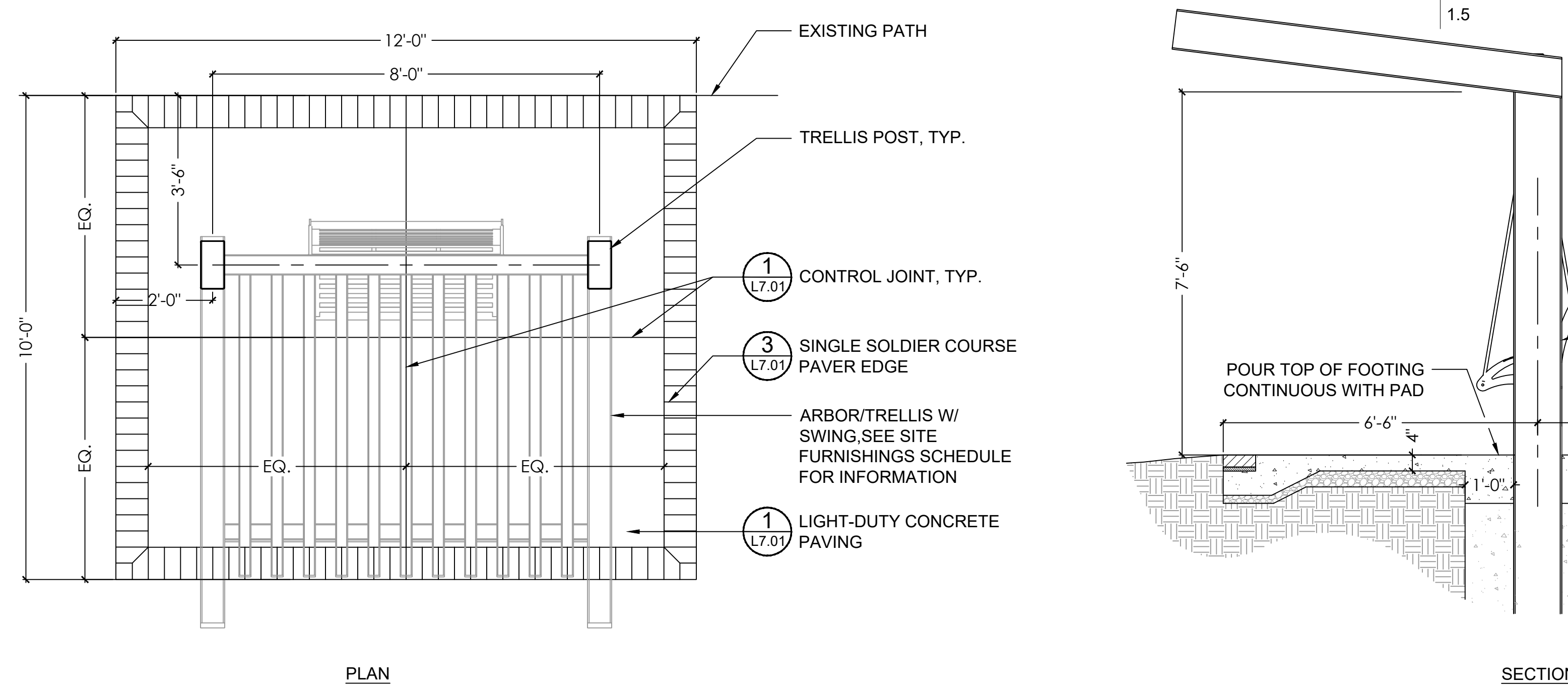

2 ADDITIVE ALTERNATE NO. 2 - ARBOR SWINGS
SCALE: N.T.S.

ADDITIVE ALTERNATE NO. 2 NOTES:

- ADDITIVE ALTERNATE NO. 2 SHALL INCLUDE ALL WORK AND MATERIALS ASSOCIATED WITH THE ARBOR/TRELLIS SUPPORT STRUCTURES, BENCH SWINGS, AND PAVING SHOWN ON THIS DETAIL.

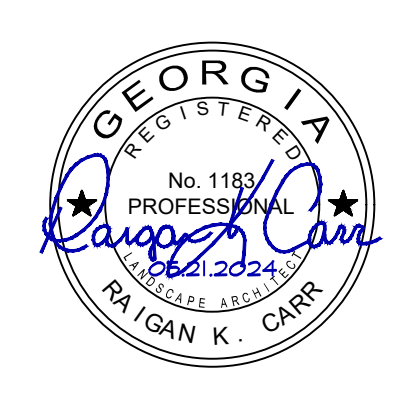

REV.	OR.	DR.	DATE	DESCRIPTION
0	CE	MP	05/21/2024	ISSUED FOR BID
1	CE	MP	06/14/2024	ADDENDUM #2

