

City of Tucker

Invitation to Bid  
ITB # 2024-011

## FELLOWSHIP ROAD SAFETY IMPROVEMENTS

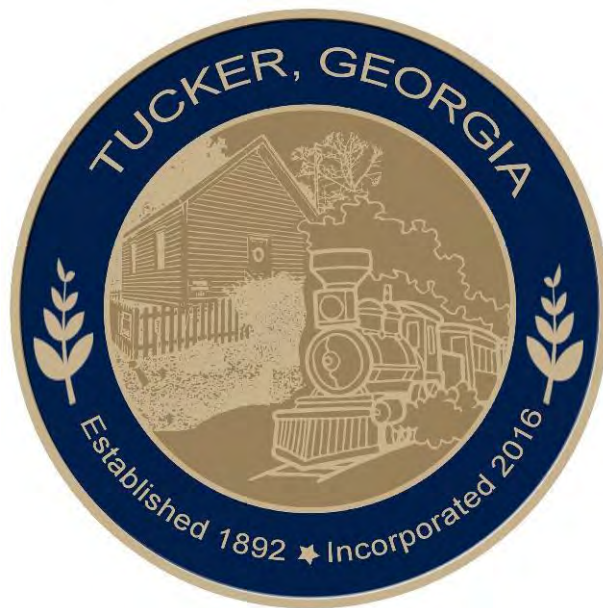

## BID MANUAL

City of Tucker  
1975 Lakeside Parkway, Suite 350  
Tucker, Georgia 30084

**City of Tucker Invitation to Bid  
ITB #2024-011  
FELLOWSHIP ROAD SAFETY IMPROVEMENTS**

**INVITATION:** The City of Tucker, Georgia requests that interested parties submit proposals for the Fellowship Road Safety Improvements Project. Proposals will be accepted until the date and time listed below and will be awarded to the responsive and responsible bidder whose bid, conforming with all the material terms and conditions of the ITB, is the lowest in price. Addenda and updates to this bid manual will be posted on the City of Tucker website <http://tuckerga.gov> or may be requested by email [procurement@tuckerga.gov](mailto:procurement@tuckerga.gov).

<b>BID ACTIVITY SCHEDULE</b>	
Invitation to Bid Issued	May 7, 2024
Pre-Bid Conference	N/A
Deadline for Questions	May 21, 2024, at 2:00 p.m. (EST)
Responses to Questions Posted (Addenda)	May 23, 2024
<b>Bid Deadline</b>	<b>June 6, 2024, at 2:00 p.m. (EST)</b>
Award at Council Meeting (Tentative)	June 26, 2024 (Tentative)
Completion from Notice to Proceed	120 calendar days

**SCOPE OF WORK:** Refer to Exhibit A and attached plans.

**QUESTIONS:** Submit all questions in writing to [procurement@tuckerga.gov](mailto:procurement@tuckerga.gov) with the subject line “Questions: ITB #2024-011”.

**PRE-BID CONFERENCE:** A pre-bid conference will not be scheduled for this project.

**ADDENDA:** Responses to questions received will be by addenda and will be posted on the City website [www.tuckerga.gov/bids](http://www.tuckerga.gov/bids). The signed acknowledgement issued with each addendum must be submitted with the proposal. It is the vendor’s responsibility to verify if any addenda were created.

**SUBMITTAL REQUIREMENTS:** Vendor shall submit ITB Response no later than June 6, 2024 at 2:00 p.m. electronically to [procurement@tuckerga.gov](mailto:procurement@tuckerga.gov) with the subject line “Submittal: ITB #2024-011”. The email must contain the vendor’s contact information. Bid Submittal should be one PDF file and named <Company Name>.ITB 2024-011.Bid Submittal.pdf

**BID TABULATION:** Preliminary Bid results will be posted on the City’s website, <http://tuckerga.gov/bids> following the bid deadline.

**City of Tucker Invitation to Bid  
ITB #2024-011  
FELLOWSHIP ROAD SAFETY IMPROVEMENTS**

**BID DOCUMENT SUBMITTAL REQUIREMENTS:**

1. Unit Price Bid Proposal Form – Exhibit B (Provided)
2. W-9 Form (Provided)
3. Certificate of Insurance
4. Contractor Affidavit (Provided)
5. Subcontractor Affidavit (Provided)
6. Proposed List of Subcontractors
7. Bid Bond Form (Provided)
8. Related Experience and References
9. Contact Form (Provided)
10. Acknowledgement of Addendum issued with each Addendum.

All responses must be received electronically by the Bid Deadline. (Addenda will show any schedule updates). No bids will be received orally or by phone. Late bids will not be considered. Bids received after the deadline will be filed unopened. The City of Tucker reserves the right to reject any and all bids or any part, to waive any formalities to make an award and to re-advertise in the best interest of the City.

The city reserves the right to negotiate pricing and may, in its discretion, award a contract to the lowest responsible and responsive bidder submitting the proposal.

**City of Tucker Invitation to Bid  
ITB #2024-011  
FELLOWSHIP ROAD SAFETY IMPROVEMENTS**

**EXHIBIT A:**

**PURPOSE, INTENT AND PROJECT DESCRIPTION**

The City of Tucker (City), requests that interested parties submit formal electronic bids for the construction of the Fellowship Road Safety Improvements Project.

This project includes the milling, patching, resurfacing, striping, installation of multiple landscaped medians, and traffic signal work along Fellowship Road from Lawrenceville Highway to Lavista Road per the attached plans and specifications. This document in its entirety for ITB 2024-011 is available for download on the City of Tucker website: <http://tuckerga.gov/bids> or request via email to [procurement@tuckerga.gov](mailto:procurement@tuckerga.gov). All future communications and supporting documents for ITB 2024-011 will be posted on the website.

**GENERAL CONDITIONS**

The contractor shall execute the work according to and meet the requirements of the following:

- Georgia Department of Transportation (GDOT) Specifications, Standards, and Details;
- The Contract Documents including but not limited to the scope of work, plans, and specifications;
- City of Tucker ordinances and regulations;
- OSHA standards and guidelines;
- MUTCD Traffic Control;
- Any other applicable codes, laws and regulations including but not limited to Section 45-10-20 through 45-10-28 of the Official Code of Georgia Annotated, Title VI of the Civil Rights Act, Drug-Free Workplace Act, and all applicable requirements of the Americans with Disabilities Act of 1990.

The contractor will be responsible for providing all labor, materials, and equipment necessary to perform the work. This is a unit price bid. Payment will be made based on actual work completed.

The contractor is responsible for inspecting the jobsite prior to submitting a bid. No change orders will be issued for differing site conditions.

The successful bidder must have verifiable experience with construction of similar projects in accordance with these specifications. Bidder shall provide at least three examples and reference information (including company name, project name, contact name, phone number and email address) demonstrating experience successfully completing projects of similar scope.

10% retainage will be withheld from the total amount due the contractor until Final Acceptance of work is issued by the City. The City will inspect the work as it progresses.

**PROSECUTION AND PROGRESS**

The Contractor will mobilize with sufficient forces such that all construction identified as part of this contract shall be substantially completed within 120 days of Notice to Proceed. The contractor will be considered substantially complete when all work required by this contract has been completed (excluding final punch list work).



**City of Tucker Invitation to Bid  
ITB #2024-011  
FELLOWSHIP ROAD SAFETY IMPROVEMENTS**

Upon Notice of Award, the Contractor will be required to submit a Progress Schedule. This schedule should accurately represent the intended work and cannot be vague or broad. The contractor shall submit a two-week advance schedule every **Friday by 2:00PM**, detailing scheduled activities for the following week.

The normal workday for this project shall be 7:00AM to 7:00PM and the normal workweek shall be Monday through Friday. Lane closures on Fellowship Road are limited to the hours of 9:00AM to 4:00PM. The City will consider extended workdays or workweeks upon written request by the Contractor on a case-by-case basis. No work will be allowed on national holidays (i.e. Memorial Day, July 4th, Labor Day, etc.).

The work will require bidder to provide all labor, administrative forces, equipment, materials, and other incidental items to complete all required work. A one (1) year Maintenance Bond will be required. The selected contractor will be responsible for the maintenance of materials for one (1) year including watering and replacement of dead materials. The City will conduct an inspection at the end of the warranty period.

The City shall perform a Final Inspection upon substantial completion of the work. The contractor will be allowed to participate in the Final Inspection. The contractor shall be assessed liquidated damages in the amount of \$200.00 per calendar day for any contract work (excluding punch list items) that is not completed by 120 calendar days from Notice to Proceed. Liquidated damages shall be deducted from the 10% retainage held by the City.

The contractor shall complete any Punch List work within 45 calendar days of the Final Inspection. All repairs shall be completed by the contractor at the contractor's expense prior to issuance of Final Acceptance. The contractor will also be assessed liquidated damages in the amount of \$200.00 per calendar day for not completing any required Punch List work within 45 calendar days of the Final Inspection.

**PERMITS AND LICENSES**

The contractor shall procure all permits and licenses, pay all charges, taxes and fees, and give all notices necessary and incidental to the due and lawful prosecution of the work.

**BONDING AND INSURANCE REQUIREMENTS**

No bid may be withdrawn for a period of forty-five (45) days after the bid deadline.

All bids must be accompanied by a Bid Bond of a reputable bonding company authorized to do business in the State of Georgia, in an amount equal to at least five percent (5%) of the total amount of the bid.

Upon Notice of Award, the successful contractor shall submit a Performance Bond payable to the City of Tucker in the amount of 100% of the total contract price. The successful contractor shall also submit a Payment Bond in the amount of 100% pursuant to O.C.G.A. § 36- 91-70 and 90.

Upon Notice of Award, the successful contractor shall procure and maintain a General Liability Insurance Policy with minimum limits of \$1,000,000 per person and \$3,000,000 per occurrence.

**City of Tucker Invitation to Bid**  
**ITB #2024-011**  
**FELLOWSHIP ROAD SAFETY IMPROVEMENTS**  
**PUBLIC NOTIFICATION**

The contractor shall be responsible for installing variable message signs at each end of the project one week prior to commencement of work requiring lane closure. Payment for this will be included in the item for Traffic Control. The contractor shall be responsible for installing lane closure and construction signage per MUTCD guidelines. Payment for this will be included in the item for Traffic Control. Properties requiring driveway closures be notified no less than one week prior to said closures.

**EXISTING CONDITIONS / DEVIATION OF QUANTITIES**

All information given in this ITB concerning quantities, scope of work, existing conditions, etc. is for information purposes only. It is the Contractor's responsibility to inspect the project site to verify existing conditions and quantities prior to submitting their bid. This is a Unit Price bid and no payment will be made for additional work without prior written approval from the City. At no time will Contractor proceed with work outside the prescribed scope of services for which additional payment will be requested without the written authorization of the City.

The City reserves the right to add, modify, or delete quantities. The City may also elect to add or eliminate certain parts of the project at its discretion. The Contractor will not be entitled to any adjustment of unit prices or any other form of additional compensation because of adjustments made to quantities and/or work locations. Contractor will be paid for actual in-place quantities completed and accepted for pay items listed in the Bid Schedule. All other work required by this ITB, plans, specs, standards, etc. but not specifically listed in the Bid Schedule shall be considered "incidental work" and included in the bid prices for items on the Bid Schedule.

**TRAFFIC CONTROL**

The contractor shall, at all times, conduct their work so as to ensure the least possible obstruction of traffic. The safety and convenience of the general public and the residents along the roadway and the protection of persons and property shall be provided for by the contractor as specified in the State of Georgia, Department of Transportation Standard Specifications Sections 104.05, 107.09 and 150.

Traffic whose origin and destination are within the limits of the project shall be provided ingress and egress at all times unless otherwise specified by the City. The ingress and egress includes entrances and exits via driveways at various properties, and access to the intersecting roads and streets. The contractor shall maintain sufficient personnel and equipment (including flaggers and traffic control signing) on the project at all times, particularly during inclement weather, to ensure that ingress and egress are safely provided when and where needed.

Two-way traffic shall be maintained at all times, unless otherwise specified or approved by the City. In the event of an emergency situation, the Contractor shall provide access to emergency vehicles and/or emergency personnel through or around the construction area. Any pavement damaged by such an occurrence will be repaired by the Contractor at no additional cost to the City.

The contractor shall furnish, install, and maintain all necessary and required barricades, signs and other traffic control devices in accordance with the MUTCD and DOT specifications, and take all necessary precautions for the protection of the workers and safety of the public.

**City of Tucker Invitation to Bid**

**ITB #2024-011**

**FELLOWSHIP ROAD SAFETY IMPROVEMENTS**

All existing signs, markers and other traffic control devices removed or damaged during construction operations will be reinstalled or replaced at the contractor's expense, except as otherwise called for in the plans. At no time will contractor remove regulatory signing which may cause a hazard to the public.

**PROTECTION AND RESTORATION OF PROPERTY AND LANDSCAPE**

The contractor shall be responsible for the preservation of all public and private property, crops, fishponds, trees, monuments, highway signs and markers, fences, grassed and sodded areas, etc. along and adjacent to the highway, road or street, and shall use every precaution necessary to prevent damage or injury thereto, unless the removal, alteration, or destruction of such property is provided for under the contract.

When or where any direct or indirect damage or injury is done to public or private property by or on account of any act, omission, neglect or misconduct in the execution of the work, or in consequence of the non-execution thereof by the contractor, he shall restore, at his/her own expense, such property to a condition similar or equal to that existing before such damage or injury was done, by repairing, rebuilding or otherwise restoring as may be directed, or she/he shall make good such damage or injury in an acceptable manner. The contractor shall correct all disturbed areas before retainage will be released.

**ADJUSTING UTILITY STRUCTURES TO GRADE**

All sewer manholes and water valves are to be adjusted by the DeKalb County Department of Watershed Management. The contractor shall coordinate required utility adjustments with the CEI inspector and Dekalb County.

**THERMOPLASTIC PAVEMENT MARKINGS**

This work shall include Thermoplastic Pavement Markings. Final (thermoplastic) pavement markings shall be placed at least 15 calendar days but no more than 60 calendar days after placement of final asphalt lift. These final pavement markings shall match the signing & marking plans including center lines, lane lines, turn arrows, crosswalks, stop bars, etc. unless specifically directed otherwise by the City. Final pedestrian crosswalk markings shall adhere to the latest standards. Pavement marking materials shall meet GDOT standard specifications and be on the qualified products list. Temporary pavement markings, where required, shall be included in the pay item for thermoplastic pavement markings. There is no separate pay item for temporary pavement markings.

**CLEANUP**

All restoration and clean-up work shall be performed daily. Operations shall be suspended if the contractor fails to accomplish restoration and clean-up within an acceptable period of time. Asphalt and other debris shall be removed from gutters, sidewalks, yards, driveways, etc. Failure to perform clean-up activities may result in suspension of the work.

**SAFETY**

Beginning with mobilization and ending with acceptance of work, the contractor shall be responsible for providing a clean and safe work environment at the project site. The contractor shall comply with all OSHA regulations as they pertain to this project.

**City of Tucker Invitation to Bid**  
**ITB #2024-011**  
**FELLOWSHIP ROAD SAFETY IMPROVEMENTS**  
**SPECIAL CONDITIONS**

1. All signage and signposts shall match the existing decorative selection to maintain the downtown aesthetic.
2. All disturbed or damaged grassing, landscaping beyond the project limits is to match existing conditions.
3. Contractor shall be required to meet all GDOT lane closure requirements. Signage and all other forms of traffic control shall be included in the “TRAFFIC CONTROL” quantity for the project.
4. Yellow ADA detectable warning surfaces should be included in “CONC SIDEWALK, 4 IN” for all ADA ramp construction.
5. “CONCRETE MEDIAN” Includes all labor, materials and equipment costs to install concrete median with planting beds, planting soil, landscaping materials and mulch as called for in the plans.
6. “STORM DRAIN PIPE, 18 IN, CLASS III” Includes all labor, materials and equipment costs to excavate, install pipe, backfill with GAB, cap trench with 8" Class B concrete and 2" 12.5 mm asphalt.
7. Removal of any existing thermoplastic shall be done with water blasting/hydro blasting method only.
8. RRFBs to match the image below of existing fixtures on Main Street including technical details and decorative pole selection.



**City of Tucker Invitation to Bid  
ITB #2024-011  
FELLOWSHIP ROAD SAFETY IMPROVEMENTS**

**Exhibit B: Cost Proposal**

<b>ITEM NO.</b>	<b>UNITS</b>	<b>ITEM DESCRIPTION</b>	<b>QTY</b>	<b>PRICE</b>	<b>AMOUNT</b>
150-1000	LS	TRAFFIC CONTROL	1		
210-0100	LS	GRADING COMPLETE	1		
441-0104	SY	CONC SIDEWALK, 4 IN	39		
441-0748	SY	CONCRETE MEDIAN, 6 IN (Includes all labor, materials and equipment costs to install concrete median with planting beds, planting soil, landscaping materials and mulch as called for in the plans)	375		
550-5180	LF	STORM DRAIN PIPE, 18 IN, CLASS III (Includes all labor, materials and equipment costs to excavate, install pipe, backfill with GAB, cap trench with 8" Class B concrete and 2" 12.5 mm asphalt)	28		
668-1100	EA	CATCH BASIN, GP 1	1		
611-3000	EA	RECONSTR CATCH BASIN, GROUP 1	1		
636-1033	SF	HIGHWAY SIGNS, TP 1 MATL, REFL SHEETING, TP 9	46		
636-1036	SF	HIGHWAY SIGNS, TP 1 MATL, REFL SHEETING, TP 11	20		
636-2070	LF	GALV STEEL POSTS, TP 7	106		
636-2090	LF	GALV STEEL POSTS, TP 9	31		
636-4104	EA	PLASTIC FLEXIBLE DELINEATOR, TP 2B	24		
647-1000	LS	TRAFFIC SIGNAL INSTALLATION NO - 1 - FELLOWSHIP ROAD AT LAVISTA ROAD	1		
636-1033	SF	HIGHWAY SIGNS, TP 1 MATL, REFL SHEETING, TP 9	5		
647-1030	EA	RRFB INSTALLATION - DOUBLE SIDED RRFB, HIGH CAPACITY SOLAR POWERED	2		
653-0110	EA	THERMOPLASTIC PVMT MARKING, ARROW, TP 1	4		
653-0120	EA	THERMOPLASTIC PVMT MARKING, ARROW, TP 2	16		
653-0210	EA	THERMOPLASTIC PVMT MARKING, WORD, TP 1	3		
653-1501	LF	THERMOPLASTIC SOLID TRAF STRIPE, 5 IN, WHITE	760		
653-1502	LF	THERMOPLASTIC SOLID TRAF STRIPE, 5 IN, YELLOW	2,816		
653-1704	LF	THERMOPLASTIC SOLID TRAF STRIPE, 24 IN, WHITE	48		
653-1804	LF	THERMOPLASTIC SOLID TRAF STRIPE, 8 IN, WHITE	553		

**City of Tucker Invitation to Bid  
ITB #2024-011  
FELLOWSHIP ROAD SAFETY IMPROVEMENTS**

653-3501	GLF	THERMOPLASTIC SKIP TRAF STRIPE, 5 IN, WHITE	2,022		
653-3502	GLF	THERMOPLASTIC SKIP TRAF STRIPE, 5 IN, YELLOW	1,120		
653-6004	SY	THERMOPLASTIC TRAF STRIPING, WHITE	9		
653-6006	SY	THERMOPLASTIC TRAF STRIPING, YELLOW	209		
654-1001	EA	RAISED PVMT MARKERS TP 1	112		
654-1003	EA	RAISED PVMT MARKERS TP 3	77		
656-0050	LF	REMOVE EXIST SOLID TRAF STRIPE, 5 IN, THERMOPLASTIC (Water blasting/hydroblasting method only)	2,746		
656-0080	LF	REMOVE EXIST SOLID TRAF STRIPE, 8 IN, THERMOPLASTIC (Water blasting/hydroblasting method only)	40		
656-1050	LF	REMOVE EXIST SKIP TRAF STRIPE, 5 IN, THERMOPLASTIC (Water blasting/hydroblasting method only)	1,675		
<b>PROJECT TOTAL:</b>					

**Company Name:** \_\_\_\_\_

**Address:** \_\_\_\_\_

**Contact Person:** \_\_\_\_\_

**Phone Number:** \_\_\_\_\_

**Email Address:** \_\_\_\_\_

**Signature:** \_\_\_\_\_

\*In case of discrepancy between the unit price and the total price on the completed Bid Schedule, the unit price will prevail, and the total price will be corrected.

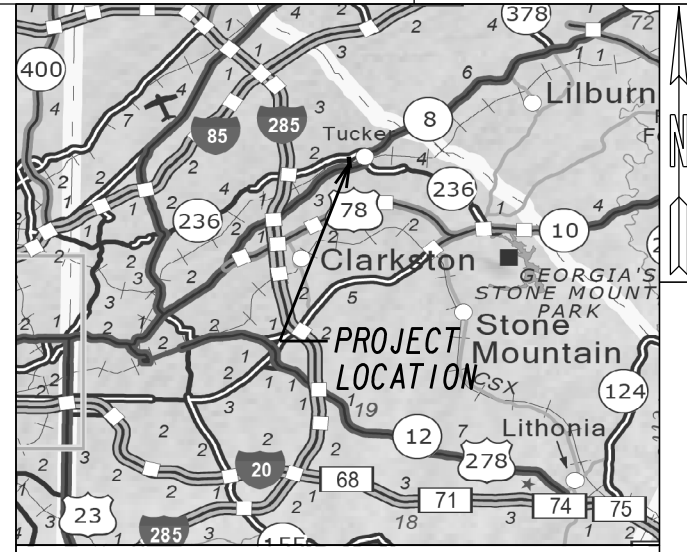

LOCATION SKETCH

DESIGN DATA:  
TRAFFIC A.D.T.: 23,800  
24 HR.TRUCKS %: 8%  
SPEED DESIGN: 35 MPH  
FUNCTIONAL CLASS: MAJOR COLLECTOR

THIS PROJECT HAS BEEN PREPARED WITHOUT A COORDINATE SYSTEM OR VERTICAL DATUM.

THESE PLANS HAVE BEEN PREPARED IN ACCORDANCE WITH THE 2024 CONSTRUCTION STANDARDS AND DETAILS BOOK AND ATTACHED APPLICABLE REVISIONS. THE 2024 CONSTRUCTION STANDARDS AND DETAILS BOOK IS AVAILABLE AT:  
[HTTP://MYDOCS.DOT.GA.GOV/INFO/GDOTPUBS/CONSTRUCT10NSTANDARDSANDETA1LS/FORMS/ALLITEMS.ASPX](http://mydocs.dot.ga.gov/info/gdotpubs/construct10nstandardsanddetails/forms/allitems.aspx)

THE DATA, TOGETHER WITH ALL OTHER INFORMATION SHOWN ON THESE PLANS OR IN ANYWAY INDICATED THEREBY, WHETHER BY DRAWINGS OR NOTES, OR IN ANY OTHER MANNER, ARE BASED UPON FIELD INVESTIGATIONS AND ARE BELIEVED TO BE INDICATIVE OF ACTUAL CONDITIONS. HOWEVER, THE SAME ARE SHOWN AS INFORMATION ONLY, ARE NOT GUARANTEED, AND DO NOT BIND THE DEPARTMENT OF TRANSPORTATION IN ANY WAY. THE ATTENTION OF BIDDER IS SPECIFICALLY DIRECTED TO SUBSECTIONS 102.04, 102.05, AND 104.03 OF THE SPECIFICATIONS.

# CITY OF TUCKER

## FELLOWSHIP ROAD SAFETY IMPROVEMENTS

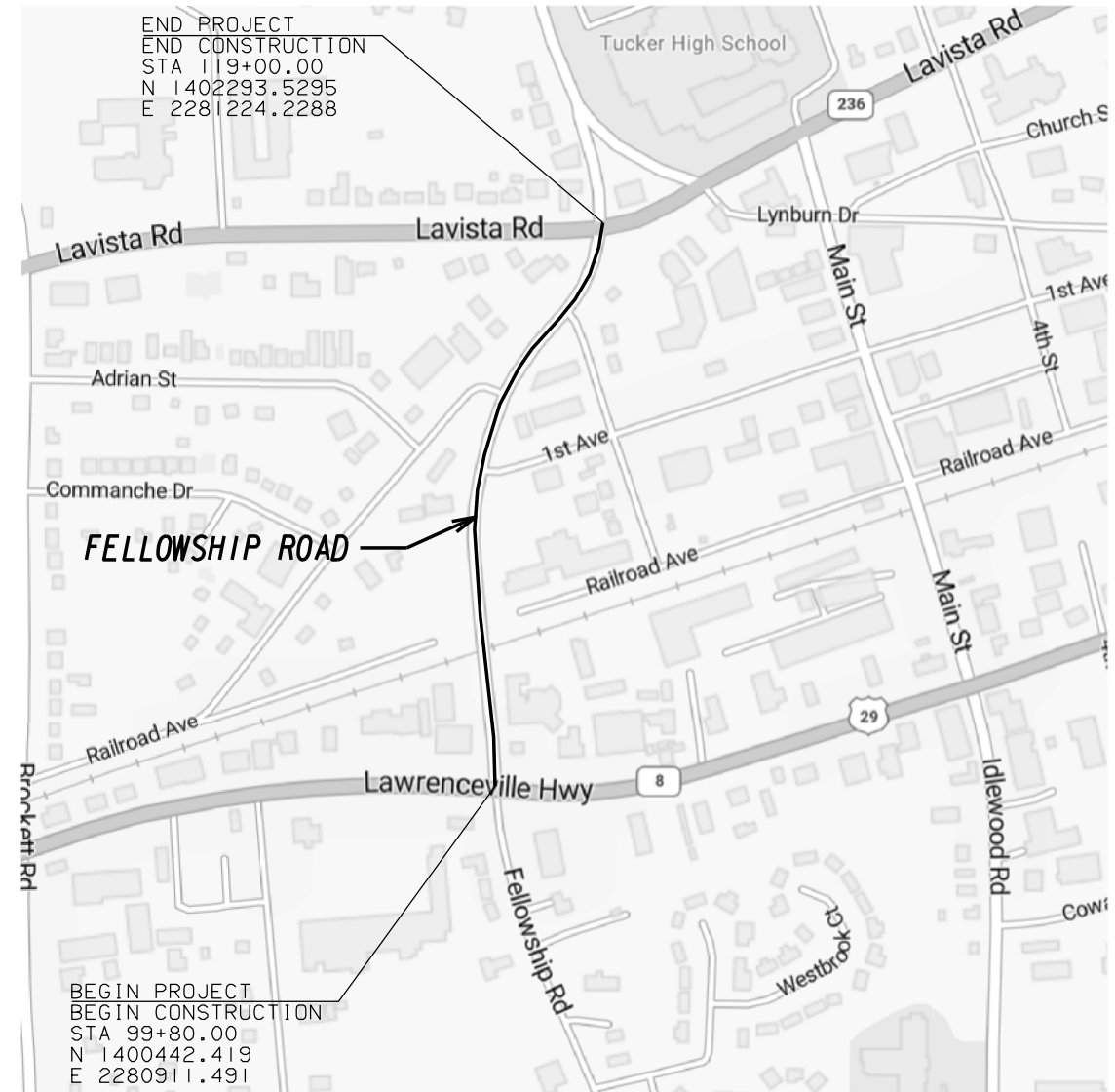

NOTE : ALL REFERENCES IN THIS DOCUMENT, WHICH INCLUDES ALL PAPERS, WRITINGS, DOCUMENTS, DRAWINGS, OR PHOTOGRAPHS USED, OR TO BE USED IN CONNECTION WITH THIS DOCUMENT, TO " STATE HIGHWAY DEPARTMENT OF GEORGIA ", " STATE HIGHWAY DEPARTMENT ", " GEORGIA STATE HIGHWAY DEPARTMENT ", " HIGHWAY DEPARTMENT ", OR " DEPARTMENT " WHEN THE CONTEXT THEREOF MEANS THE STATE HIGHWAY DEPARTMENT OF GEORGIA, AND SHALL BE DEEMED TO MEAN THE DEPARTMENT OF TRANSPORTATION.



04/30/2024



PLANS PREPARED BY  
**vhb**  
UNDER THE SUPERVISION OF  
BRITTANY M. TYSON, PE

PLANS COMPLETED	
REVISIONS	

LENGTH OF PROJECT	COUNTY No. 89 Project No. N/A
	MILES
NET LENGTH OF ROADWAY	0.364
NET LENGTH OF BRIDGES	0.000
NET LENGTH OF PROJECT	0.364
NET LENGTH OF EXCEPTIONS	0.000
GROSS LENGTH OF PROJECT	0.364

DRAWING No.  
**01-001**







### GENERAL NOTES

- |  |   |
|--|---|
| <ol style="list-style-type: none"> <li>1. THE LOCATIONS OF EXISTING UTILITIES ARE NOT SHOWN ON THE PLANS. UNDERGROUND UTILITY LOCATIONS SHALL BE VERIFIED BY THE CONTRACTOR PRIOR TO BEGINNING CONSTRUCTION. IF UTILITIES ARE ENCOUNTERED DURING EXCAVATION OPERATIONS, THE CONTRACTOR SHALL NOTIFY THE ENGINEER IMMEDIATELY FOR INSTRUCTIONS TO RESOLVE ANY CONFLICTS. ANY DAMAGE OR INTERRUPTION OF EXISTING UTILITIES SHALL BE THE SOLE RESPONSIBILITY OF THE CONTRACTOR AND SHALL BE REPAIRED PROMPTLY AT THE CONTRACTOR'S EXPENSE.</li> <li>2. UTILITY WORK COORDINATION WILL BE REQUIRED AS PART OF THIS CONTRACT. THE CONTRACTOR SHALL BE REQUIRED TO USE THE ONE-CALL CENTER TELEPHONE NUMBER (811) FOR THE PURPOSE OF COORDINATING THE MARKING OF UNDERGROUND UTILITIES.</li> <li>3. PROJECT TO BE CONSTRUCTED PER GEORGIA DEPARTMENT OF TRANSPORTATION (GDOT) STANDARD SPECIFICATIONS, 2021 EDITION, GDOT PUBLISHED SPECIAL PROVISIONS AND SUPPLEMENTAL SPECIFICATIONS TO THE STANDARD SPECIFICATIONS, AND AS MODIFIED BY THE PLANS AND CONTRACT DOCUMENTS.</li> <li>4. CONTRACTOR SHALL ESTABLISH SURVEY CONTROL POINTS IN THE FIELD BY SELECTING SUITABLE, VISIBLE POINTS IN AERIAL ORTHOGRAPHIC IMAGE FILES AND MICROSTATION CADD FILES PROVIDED BY THE CITY. COST FOR ESTABLISHMENT OF SURVEY CONTROL AND ALL SURVEY LAYOUT SHALL BE INCLUDED IN THE PRICE BID FOR GRADING COMPLETE.</li> <li>5. A NOTICE OF INTENT IS NOT REQUIRED FOR THIS PROJECT SINCE DISTURBED AREA IS LESS THAN ONE ACRE, AS PER GENERAL NPDES PERMICOSTT NO. GAR100002.</li> <li>6. ALL NON-PAVED DISTURBED AREAS SHALL BE GRASSED AND MULCHED IN ACCORDANCE WITH CURRENT GDOT SPECIFICATION SECTION 700-GRASSING. GRASSED AREAS SHALL BE MAINTAINED BY THE CONTRACTOR UNTIL GRASS IS ESTABLISHED AND ACCEPTED BY THE ENGINEER. THE COST FOR ALL GRASSING AND MULCH SHALL BE INCLUDED IN THE PRICE BID FOR GRADING COMPLETE.</li> <li>7. NO ADDITIONAL PAYMENT WILL BE MADE FOR REMOVAL OF ITEMS AS CALLED FOR IN THE PLANS OR AS NECESSARY TO CONSTRUCT ELEMENTS OF THE PROJECT. THE COST FOR ALL REMOVALS SHALL BE INCLUDED IN THE PRICE BID FOR GRADING COMPLETE. THIS INCLUDES BUT IS NOT LIMITED TO REMOVAL OF ASPHALT PAVEMENT, ASPHALT SHOULDER, AND CURB AND GUTTER.</li> <li>8. DETECTABLE WARNING SURFACES TO BE INSTALLED UNDER THIS CONTRACT SHALL BE THE SAME COLOR AS DETECTABLE WARNING SURFACES AT ADJACENT INTERSECTIONS.</li> <li>9. THERE IS NO KNOWN SUITABLE PLACE TO BURY EXISTING CONSTRUCTION DEBRIS WITHIN THE PROJECT'S LIMITS. DEMOLITION DEBRIS SHALL BECOME PROPERTY OF THE CONTRACTOR AND WASTE SOILS, VEGETATION, AND OTHER DELETERIOUS MATERIALS SHALL BE HAULED OFF-SITE AND BE DISPOSED OF AT AN APPROVED LOCATION IN ACCORDANCE WITH LOCAL, STATE, AND FEDERAL REGULATIONS.</li> <li>10. CONTRACTOR SHALL NOT WORK, STORE MATERIALS, SETUP EQUIPMENT, DISTURB PROPERTY OR MAKE IMPROVEMENTS OUTSIDE OF THE EXISTING RIGHT OF WAY LINES SHOWN ON THE SECTION 13 DRAWINGS.</li> <li>11. EQUIPMENT AND MATERIALS SHALL BE STORED OFF-SITE OR IN AREAS APPROVED BY THE ENGINEER. CONSTRUCTION AND STORAGE AREAS SHALL BE KEPT NEAT AND CLEAN. EQUIPMENT AND MATERIAL SHALL NOT BE STORED WITHIN THE DRIP LINE OF TREES.</li> <li>12. ALL EXISTING ELECTRICAL BOXES, WATER METER BOXES, VALVE BOXES AND ANY OTHER UTILITY STRUCTURES WHICH ARE TO REMAIN SHALL BE SET FLUSH WITH THE TOP OF THE PROPOSED GRADE OR CONCRETE SURFACE. ALL COSTS ASSOCIATED WITH THIS REQUIREMENT SHALL BE INCLUDED IN THE PRICE BID FOR GRADING COMPLETE.</li> <li>13. CONTRACTOR SHALL ENSURE POSITIVE DRAINAGE ACROSS DISTURBED AREAS AND INTO DRAINAGE FEATURES.</li> </ol> | <ol style="list-style-type: none"> <li>14. ALL CONCRETE TO BE USED FOR THE CONSTRUCTION OF CURB AND GUTTER TO BE CLASS 'A' CONCRETE. CONCRETE SHALL BE PREPARED AND INSTALLED IN ACCORDANCE WITH CURRENT GDOT SPECIFICATION SECTION 441-MISCELLANEOUS CONCRETE.</li> <li>15. THE CONTRACTOR SHALL MARK THE OUTLINE OF RAISED CONCRETE MEDIANS AND ISLANDS AND RECEIVE APPROVAL FROM THE ENGINEER BEFORE INSTALLING.</li> <li>16. THE PRICE BID FOR TRAFFIC SIGNAL INSTALLATION SHALL INCLUDE ALL ITEMS CALLED FOR ON THE SIGNAL PLANS WITH THE EXCEPTION OF LOOP DETECTORS. COST FOR LOOP DETECTOR INSTALLATION OR REPLACEMENT SHALL BE INCLUDED IN THE PRICE BID FOR LOOP DETECTOR.</li> </ol> |
|--|---|



#### MAINTENANCE OF TRAFFIC AND TRAFFIC CONTROL

17. THROUGHOUT CONSTRUCTION, THE CONTRACTOR SHALL PROVIDE AND MAINTAIN SUFFICIENT BARRICADES, LIGHTS, WARNING SIGNS, AND OTHER TRAFFIC CONTROL METHODS ADJACENT TO EXISTING ROADWAYS AND PARKING AREAS AS MAY BE REQUIRED FOR THE PROTECTION AND SAFETY OF THE PUBLIC. ALL TEMPORARY SIGNING AND PAVEMENT MARKING SHALL BE IN ACCORDANCE WITH THE MANUAL ON UNIFORM TRAFFIC CONTROL DEVICES (MUTCD), LATEST EDITION AND/OR AS DIRECTED BY THE ENGINEER.
18. ALL EXISTING PEDESTRIAN FACILITIES, INCLUDING ACCESS TO TRANSIT STOPS, SHALL BE MAINTAINED. WHERE PEDESTRIAN ROUTES ARE CLOSED TEMPORARILY, ALTERNATE ROUTES SHALL BE PROVIDED. CLOSURES OF EXISTING, INTERIM AND FINAL PEDESTRIAN FACILITIES SHALL BE KEPT TO A MINIMUM AND SHALL HAVE THE PRIOR WRITTEN APPROVAL OF THE ENGINEER.
19. ALL WORK ASSOCIATED WITH TRAFFIC CONTROL AND MAINTENANCE OF TRAFFIC, INCLUDING TEMPORARY MARKING, BARRICADES, CHANNELIZING DEVICES, WARNING SIGNS, TWO (2) PORTABLE CHANGEABLE MESSAGE SIGNS, AND OTHER TRAFFIC CONTROL METHODS, SHALL BE INCLUDED IN THE LUMP SUM PRICE BID FOR TRAFFIC CONTROL.
20. THE CONTRACTOR WILL PROVIDE, MAINTAIN, AND OPERATE TWO (2) PORTABLE CHANGEABLE MESSAGE SIGNS AND COORDINATE WITH THE ENGINEER ON THEIR PLACEMENT AND MESSAGES TO BE DISPLAYED CONTINUOUSLY FROM ONE MONTH PRIOR TO MEDIAN ISLAND CONSTRUCTION UNTIL TWO MONTHS AFTER COMPLETION OF FINAL MARKING.
21. THE CONTRACTOR SHALL MAINTAIN ONE LANE OF TRAFFIC IN EACH DIRECTION ALONG CHAMBLEE TUCKER ROAD AT ALL TIMES.
22. THE CONTRACTOR SHALL RESTRICT WORK HOURS TO THE PERIOD FROM 7:00 AM TO 7:00 PM MONDAY THROUGH SATURDAY.
23. THE CONTRACTOR SHALL NOT IMPEDE TRAFFIC BETWEEN THE HOURS OF 7:00 AM TO 9:00 AM AND 4:00 PM TO 7:00 PM MONDAY THROUGH FRIDAY.

11/05/2020  
 11/05/2020  
 11/05/2020  
 11/05/2020

11/05/2020  
 11/05/2020  
 11/05/2020  
 11/05/2020

11/05/2020  
 11/05/2020  
 11/05/2020  
 11/05/2020



REVISION DATES		GENERAL NOTES	
		FELLOWSHIP ROAD	
		SAFETY IMPROVEMENTS	
CHECKED:	DATE:	DRAWING No.	
BACKCHECKED:	DATE:	04-001	
CORRECTED:	DATE:		
VERIFIED:	DATE:		

## GENERAL NOTES

### SIGNING AND MARKING

24. ALL STANDARD HIGHWAY SIGNS SHALL BE FABRICATED AND ERECTED IN ACCORDANCE WITH THE DETAILS SHOWN IN THE PLANS, THE MANUAL ON UNIFORM TRAFFIC CONTROL DEVICES (MUTCD), CURRENT EDITION, AND THE GEORGIA SPECIFICATIONS, SUPPLEMENTAL SPECIFICATIONS, AND/OR SPECIAL PROVISIONS.
25. SIGN ERECTION LOCATIONS ARE APPROXIMATE AND MAY BE ADJUSTED TO MEET FIELD CONDITIONS WHERE NECESSARY BUT SHALL BE WITHIN THE LIMITATIONS SET FORTH IN THE MANUAL ON UNIFORM TRAFFIC CONTROL DEVICES, CURRENT EDITION. NO SIGN LOCATION SHALL BE CHANGED BY THE CONTRACTOR OR BY THE PROJECT ENGINEER WITHOUT PRIOR APPROVAL FROM THE ENGINEER.
26. ALL STANDARD HIGHWAY SIGNS SHALL BE ERECTED AT A HEIGHT OF 7 FEET ABOVE THE NORMAL EDGE OF PAVEMENT, CURB OR SIDEWALK TO THE BOTTOM OF THE SIGN OR ASSEMBLY.
27. THE HORIZONTAL CLEARANCE FOR STANDARD HIGHWAY SIGNS IN NON-MOUNTABLE CURB SECTIONS SHALL BE AT LEAST 2 FEET FROM THE CURB FACE TO THE NEARER EDGE OF THE SIGN(S).
28. EACH 42 OR 48 INCH WIDE x 18 OR 24 INCH HIGH SIGN REQUIRES ONE 2 INCH x 1/2 INCH x (WIDTH OF SIGN) ALUMINUM OR GALVANIZED STEEL STRAP LOCATED IN THE CENTER OF THE SIGN AND FLUSH WITH THE BACK OF THE SIGN.
29. SIGN ASSEMBLIES SHALL BE MOUNTED ON ALUMINUM OR GALVANIZED STEEL STRAP FRAMES, UNLESS OTHERWISE NOTED IN THE PLANS. FOR DETAILS AND STRAP SPECIFICATIONS REFER TO SIGN ASSEMBLY-TYPICAL FRAMING DETAILS.
30. TYPE 9 (VERY HIGH INTENSITY) REFLECTIVE SHEETING SHALL BE USED FOR ALL STANDARD HIGHWAY SIGNS REQUIRING REFLECTORIZED BACKGROUNDS EXCEPT AS SPECIFIED BELOW OR SPECIFIED OTHERWISE IN THE PLANS. EITHER CLASS 1 OR CLASS 2 ADHESIVE BACKING IS PERMISSIBLE.  
  
TYPE 11 (VERY HIGH INTENSITY) REFLECTIVE SHEETING SHALL BE USED FOR ALL RED SERIES SIGNS (R1-1, R1-2, R1-3P, R5-1, R5-1A, R5-1B).  
  
TYPE 11 (VERY HIGH INTENSITY) FLUORESCENT YELLOW REFLECTIVE SHEETING SHALL BE USED FOR ALL WARNING SIGNS.  
  
TYPE 11 (VERY HIGH INTENSITY) FLUORESCENT YELLOW GREEN REFLECTIVE SHEETING SHALL BE USED FOR SCHOOL ZONE (S1-1, S2-1, S3-1, S4-3, AND THE TOP PORTION OF THE S5-1) SIGNS. ALL REGULATORY SIGNS WITHIN THE SCHOOL ZONE SIGNING SHALL HAVE TYPE 9 (VERY HIGH INTENSITY) REFLECTIVE SHEETING.
31. A 1/2 INCH MINIMUM AIR SPACE SHALL BE REQUIRED BETWEEN ALL SIGN PLATES WITHIN AN ASSEMBLY.
32. WHERE SIGNS WITHIN AN ASSEMBLY EXTEND BELOW THE STANDARD MOUNTING HOLES ON THE POST(S), ADDITIONAL 3/8 INCH DIAMETER HOLE(S), DRILLED OR PUNCHED, SHALL BE REQUIRED TO PROPERLY MOUNT THE ASSEMBLY.
33. THE CONTRACTOR WILL, AS REQUESTED BY THE ENGINEER, BE REQUIRED TO REMOVE ANY EXISTING SIGNS THAT ARE DUPLICATED OR ARE CONTRARY TO THESE SIGN PLANS.
34. THE CONTRACTOR SHALL STAKE ALL SIGN LOCATIONS AND RECEIVE APPROVAL FROM THE ENGINEER BEFORE INSTALLATION.
35. ADJUST SPAN WIRE TENSION AS APPROPRIATE WHEN MOVING OR REPLACING OVERHEAD SIGNS.
36. REMOVAL, RELOCATION AND ADJUSTMENT OF SIGNS, ALONG WITH ADJUSTMENTS TO SIGN SUPPORTS AS CALLED FOR IN THE PLANS OR DIRECTED BY THE ENGINEER SHALL BE INCLUDED IN THE PRICE BID FOR OTHER SIGN ITEMS.
37. THE CONTRACTOR SHALL STAKE ALL RRFB LOCATIONS AND RECEIVE APPROVAL FROM THE ENGINEER BEFORE INSTALLATION.
38. RRFB ASSEMBLIES PROVIDED BY THE CONTRACTOR SHALL BE MANUFACTURED BY TAPCO, OR EQUAL APPROVED BY THE CITY, IN ACCORDANCE WITH CURRENT FHWA GUIDANCE. RRFB SHALL BE SOLAR POWERED, AND BULLDOG PUSH BUTTON ACTIVATED. WHERE A HIGH-CAPACITY SOLAR PANEL IS CALLED FOR IN THE PLANS, THE SOLAR PANEL SHALL HAVE A MINIMUM 30-WATT OUTPUT AND THE BATTERY SHALL HAVE A MINIMUM 35 AMP-HOUR CAPACITY. PRICE BID FOR INSTALLING THE CONTRACTOR PROVIDED RRFB ASSEMBLY SHALL INCLUDE THE FLASHING BEACON, MOUNTING POLE AND BASE, POLE FOUNDATION AND ANCHOR BOLTS, WIRELESS COMMUNICATIONS SYSTEM, SOLAR PANEL SYSTEM, PUSH BUTTON, SIGNS CALLED FOR IN THE PLANS TO BE ATTACHED TO THE ASSEMBLY, HARDWARE AND WIRING, INSTALLATION, TESTING, AND BURN-IN PERIOD WORK.
39. ALL RRFB ASSEMBLIES SHALL BE INSTALLED PER MANUFACTURER'S SPECIFICATIONS. SOLAR PANELS SHALL BE INSTALLED IN UNOBSTRUCTED SUNLIGHT. A SEPARATE POLE FOR MOUNTING THE SOLAR PANEL MAY BE REQUIRED TO ENSURE UNOBSTRUCTED SUNLIGHT.
40. CONTRACTOR SHALL PERFORM ACCEPTANCE TESTING FOR ALL EQUIPMENT, HARDWARE AND WORK PROVIDED UNDER THIS CONTRACT AT EACH RRFB ASSEMBLY FIELD INSTALLATION. OBTAIN ENGINEER'S APPROVAL FOR ALL TEST PROCEDURES PRIOR TO BEGINNING ACCEPTANCE TESTING. NOTIFY THE ENGINEER OF A DESIRED ACCEPTANCE TEST SCHEDULE NO LESS THAN FOURTEEN CALENDAR DAYS PRIOR TO BEGINNING TESTING. COMPLETE ALL WORK PRIOR TO THE BEGINNING OF ANY ACCEPTANCE TESTING AT A GIVEN RRFB ASSEMBLY SITE IN THE PRESENCE OF THE ENGINEER. TESTING SHALL BE INCLUDED IN THE PRICE BID FOR INSTALLING THE RRFB ASSEMBLY.
41. FOLLOWING THE SUCCESSFUL FIELD INSTALLATION TEST FOR ALL THE RRFB ASSEMBLIES, THE CONTRACTOR SHALL PROVIDE A BURN-IN PERIOD FOR ALL WORK AND EQUIPMENT INCLUDED IN THE CONTRACT CONSISTING OF THE FIELD OPERATION OF THE RRFB ASSEMBLY FOR 30 DAYS. SUCCESSFUL COMPLETION AND ACCEPTANCE OF THE BURN-IN PERIOD WILL BE GRANTED ON THE 30TH DAY UNLESS ANY EQUIPMENT HAS MALFUNCTIONED DURING THE 15TH THROUGH 30TH DAY OF THE BURN-IN PERIOD. IF ANY EQUIPMENT HAS FAILED DURING THE 15TH THROUGH 30TH DAY, FINAL ACCEPTANCE WILL BE WITHHELD UNTIL ALL THE EQUIPMENT IS FUNCTIONING PROPERLY FOR 15 DAYS AFTER REPAIR. BURN-IN PERIOD WORK SHALL BE INCLUDED IN THE PRICE BID FOR INSTALLING THE RRFB ASSEMBLY.

11/05/2020

11/05/2020

11/05/2020



#### REVISION DATES

#### GENERAL NOTES FELLOWSHIP ROAD SAFETY IMPROVEMENTS

CHECKED:	DATE:	DRAWING No.	
BACKCHECKED:	DATE:	04-002	
CORRECTED:	DATE:		
VERIFIED:	DATE:		

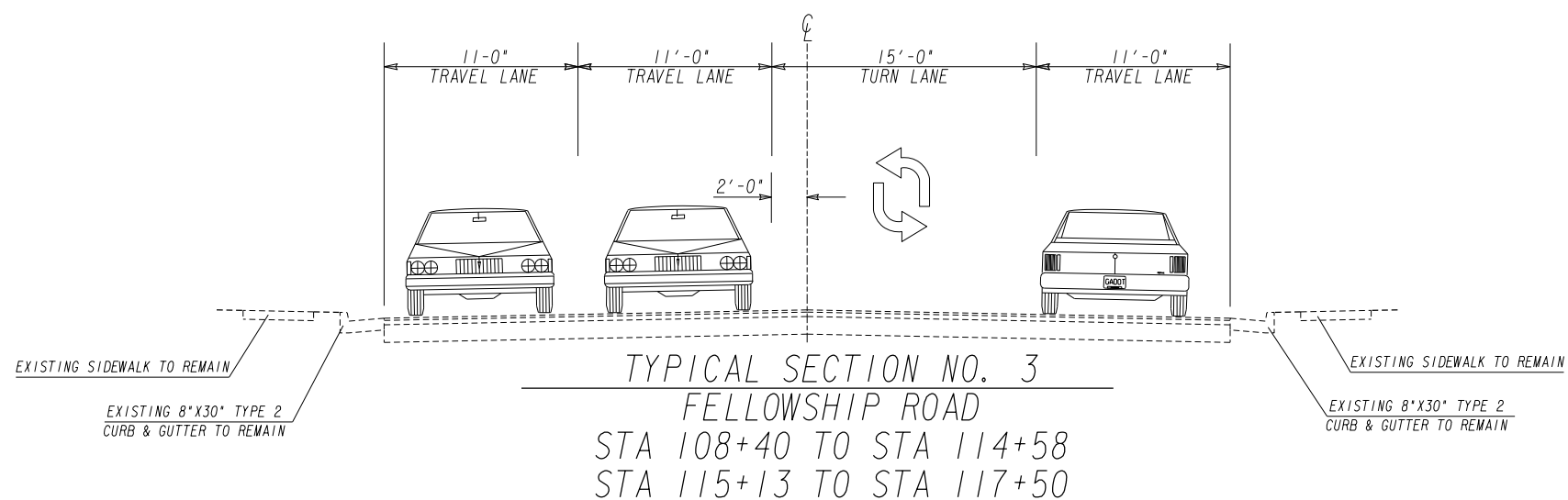
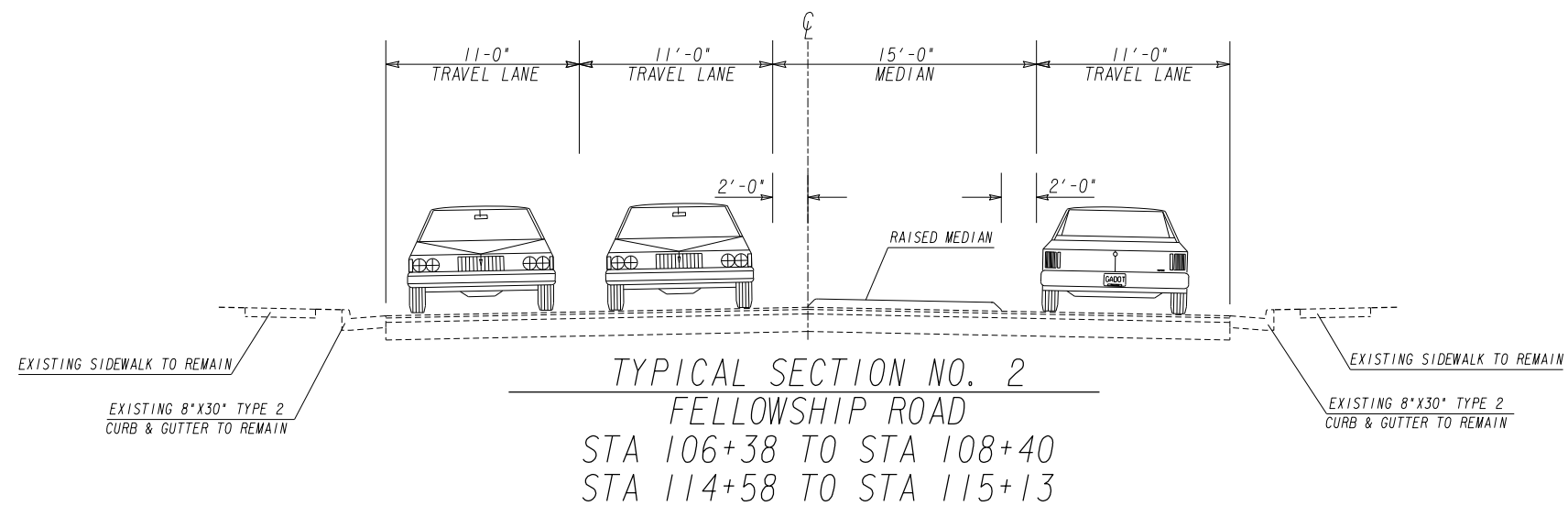
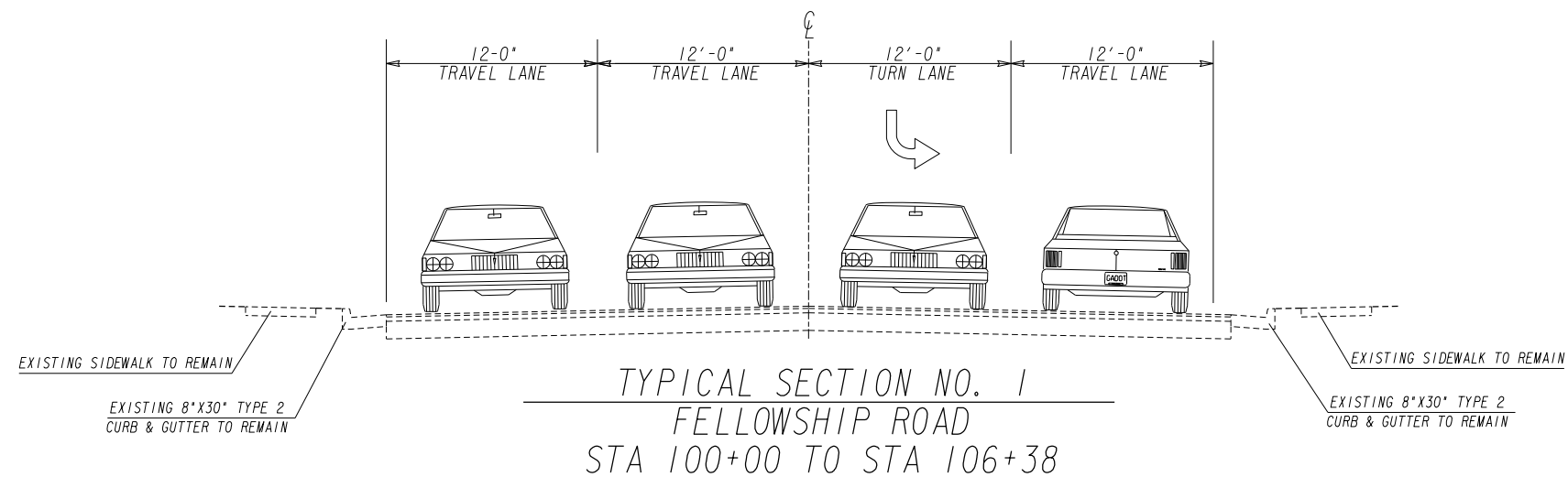

REVISION DATES

NO.	DATE	DESCRIPTION

TYPICAL SECTIONS  
FELLOWSHIP ROAD  
SAFETY IMPROVEMENTS

CHECKED:	DATE:	DRAWING No.
BACKCHECKED:	DATE:	05-001
CORRECTED:	DATE:	
VERIFIED:	DATE:	



SIGNALS				
LOCATION	INSTL NO	LS	HIGHWAY SIGNS, TP 1 MATL, REFL SHEETING, TP 9 SF	
FELLOWSHIP ROAD AT LAVISTA ROAD	1	1	5	
AS DIRECTED BY ENGINEER:				
PROJECT TOTAL			5	

CURB & GUTTER, MEDIAN AND SIDEWALK		
LOCATION	CONC SIDEWALK, 4 IN SY	CONCRETE MEDIAN, 6 IN SY
FELLOWSHIP ROAD	0	0
STA 99+50 TO 103+00	0	0
STA 103+00 TO 107+00	0	82
STA 107+00 TO 111+50	39	176
STA 111+50 TO 115+50	0	117
STA 115+50 TO 119+00	0	0
AS DIRECTED BY ENGINEER:		
PROJECT TOTAL	39	375

DRAINAGE				
STR NO.	LOCATION	STORM DRAIN PIPE	CATCH BASINS	RECONSTRUCT CATCH BASINS
			STD 1033 GROUP 1	STD 1033 GROUP 1
		18 INCH CLASS III LF	H=6' OR LESS EA	H=6' OR LESS EA
1	106+94.00, 2.67 RT	28.0	1	1
AS DIRECTED BY ENGINEER:				
PROJECT TOTAL		28	1	1

**TRAFFIC CONTROL - FELLOWSHIP ROAD**  
LUMP SUM

**GRADING COMPLETE - FELLOWSHIP ROAD**  
LUMP SUM

LANDSCAPING							
	CERCIS CANADENSIS X MERLOT	CEANOTHUS AMERICANA - 3 GAL	CLEATHERA ALNIFOLIA - 1 GAL	HYPERICUM PROLIFICUM 1 GAL	ILEX VOMITORIA SCHILLINGS 3 GAL	ITEA VIRGINICA - 1 GAL	VIBURNUM OBOVATUM - 3 GAL
	EA	EA	EA	EA	EA	EA	EA
PROJECT TOTAL	5	12	45	100	16	64	62

\*GRADING COMPLETE SHALL ALSO INCLUDE REMOVAL OF ITEMS AS CALLED FOR IN THE PLANS OR AS NECESSARY TO CONSTRUCT ELEMENTS OF THE PROJECT; ALL INCIDENTAL SAW CUTTING COSTS; REMOVAL AND DISPOSAL OF DEMOLITION DEBRIS, WASTE SOILS, VEGETATION AND OTHER DELETERIOUS MATERIAL; SETTING UTILITY STRUCTURES THAT ARE TO REMAIN FLUSH WITH PROPOSED GRADE OR CONCRETE SURFACE; EROSION, SEDEMENTATION AND POLLUTION CONTROL BEST MANAGEMENT PRACTICES; GRASSING AND MULCH; AND OBTAINING SUITABLE BORROW MATERIAL.

\*LANDSCAPING SHALL BE INSTALLED ACCORDING TO THE PROVIDED QUANTITIES AND SPECIES AS SHOWN ABOVE AND IN THE LANDSCAPE PLANS. COST FOR PLANTINGS WILL BE INCLUDED IN THE PRICE FOR CONCRETE MEDIAN, 6 IN.



REVISION DATES		SUMMARY QUANTITIES	
		FELLOWSHIP ROAD SAFETY IMPROVEMENTS	
CHECKED:	DATE:	DRAWING No.	
BACKCHECKED:	DATE:	06-001	
CORRECTED:	DATE:		
VERIFIED:	DATE:		











MATCH LINE STA. 103+00.00 DRAWING No. 0002

DATE: 11/05/2020  
TIME: 11:00 AM  
USER: GJL

DATE: 11/05/2020  
TIME: 11:00 AM  
USER: GJL

DATE: 11/05/2020  
TIME: 11:00 AM  
USER: GJL

PROPERTY AND EXISTING R/W LINE

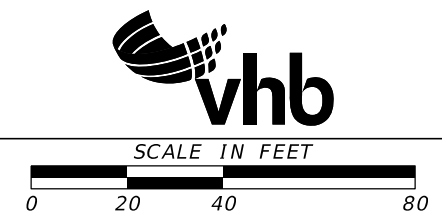

REVISION DATES

NO.	DATE	DESCRIPTION

CONSTRUCTION PLANS  
FELLOWSHIP ROAD  
SAFETY IMPROVEMENTS

CHECKED:	DATE:
BACKCHECKED:	DATE:
CORRECTED:	DATE:
VERIFIED:	DATE:

DRAWING No.  
**13-001**



MATCH LINE STA. 103+00.00 DRAWING No. 0001

MATCH LINE STA. 107+00.00 DRAWING No. 0003

DATE: 11/05/2020  
DRAWN BY: [REDACTED]  
CHECKED BY: [REDACTED]  
SCALE: AS SHOWN

PROPERTY AND EXISTING R/W LINE

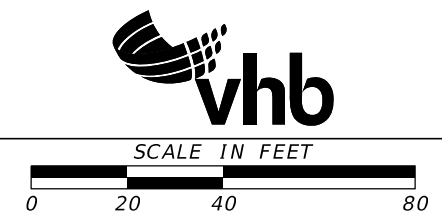

REVISION DATES	

CONSTRUCTION PLANS FELLOWSHIP ROAD SAFETY IMPROVEMENTS			
CHECKED:	DATE:	DRAWING No.	
BACKCHECKED:	DATE:	13-002	
CORRECTED:	DATE:		
VERIFIED:	DATE:		

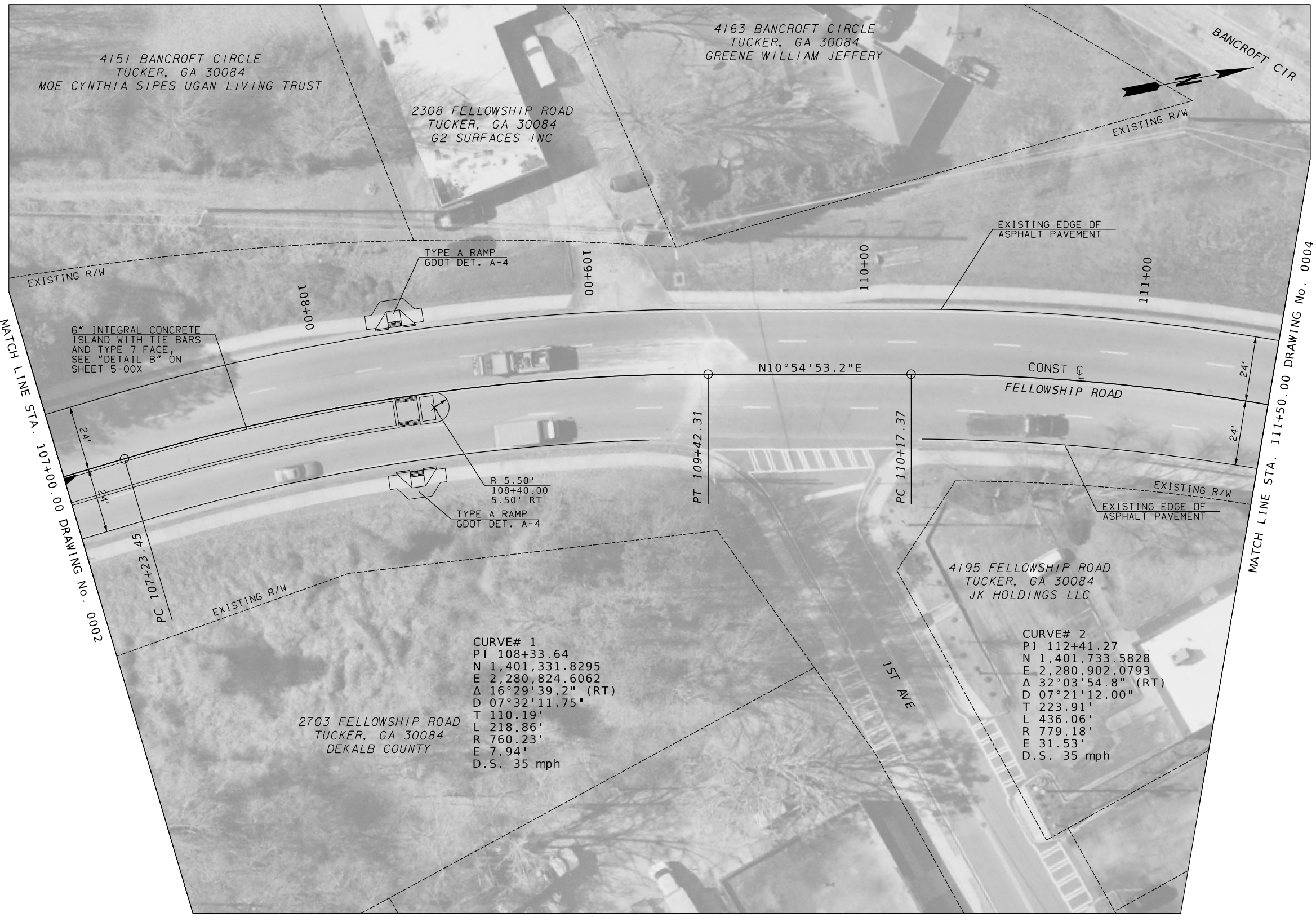

MATCH LINE STA. 107+00.00 DRAWING No. 0002

MATCH LINE STA. 111+50.00 DRAWING No. 0004

**CURVE# 1**  
 PI 108+33.64  
 N 1,401,331.8295  
 E 2,280,824.6062  
 $\Delta$  16°29'39.2" (RT)  
 D 07°32'11.75"  
 T 110.19'  
 L 218.86'  
 R 760.23'  
 E 7.94'  
 D.S. 35 mph

**CURVE# 2**  
 PI 112+41.27  
 N 1,401,733.5828  
 E 2,280,902.0793  
 $\Delta$  32°03'54.8" (RT)  
 D 07°21'12.00"  
 T 223.91'  
 L 436.06'  
 R 779.18'  
 E 31.53'  
 D.S. 35 mph

PROPERTY AND EXISTING R/W LINE

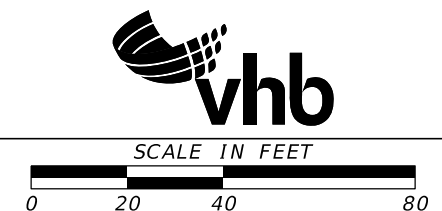

REVISION DATES	

CONSTRUCTION PLANS FELLOWSHIP ROAD SAFETY IMPROVEMENTS			
CHECKED:		DATE:	
BACKCHECKED:		DATE:	
CORRECTED:		DATE:	
VERIFIED:		DATE:	
DRAWING No.			13-003





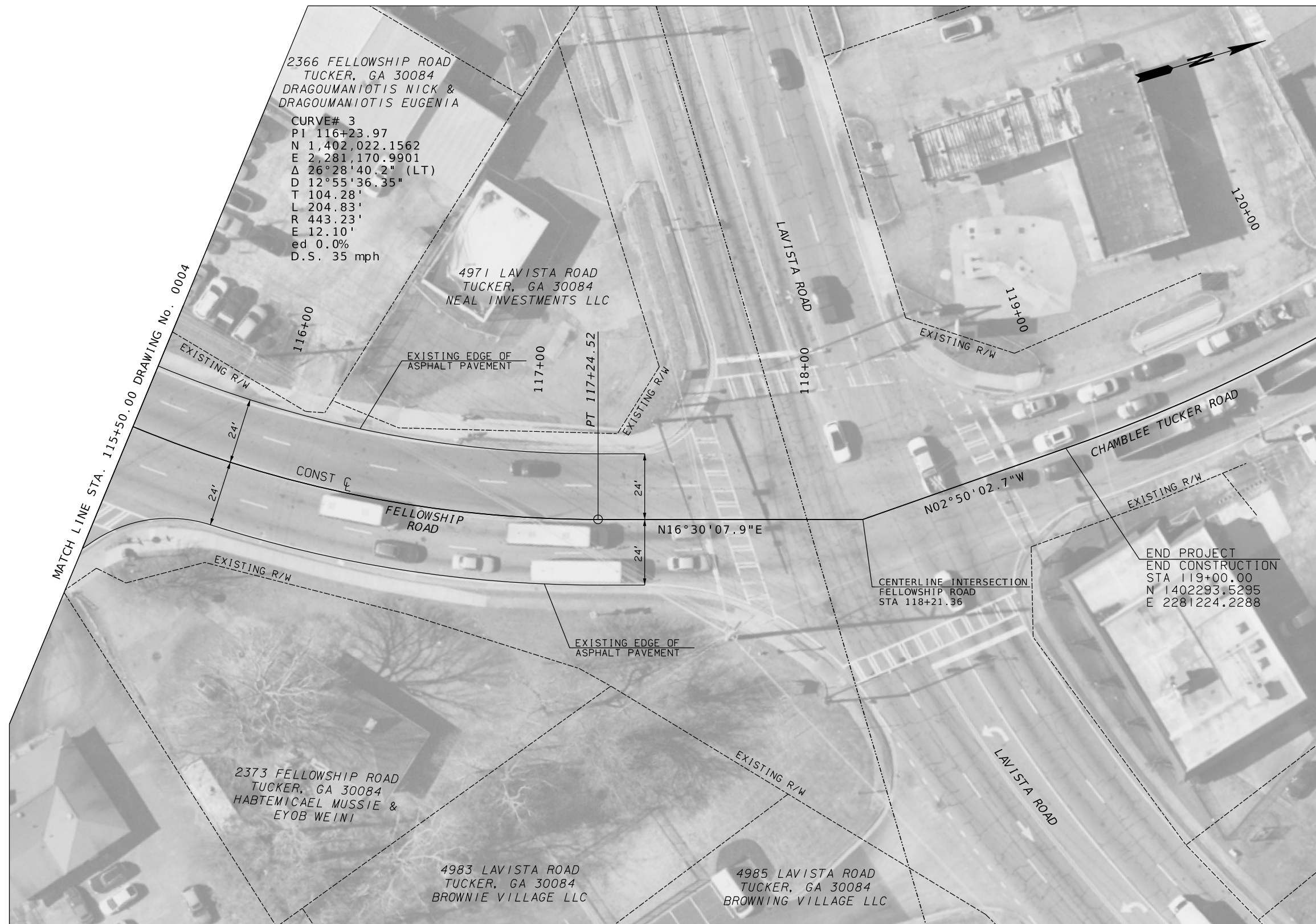

11/05/2020  
11/05/2020  
11/05/2020

11/05/2020  
11/05/2020  
11/05/2020

PROPERTY AND EXISTING R/W LINE

---	---
-----	-----

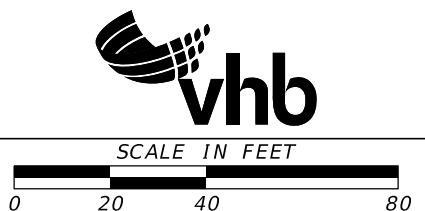

REVISION DATES	

CONSTRUCTION PLANS  
FELLOWSHIP ROAD  
SAFETY IMPROVEMENTS

CHECKED:	DATE:
BACKCHECKED:	DATE:
CORRECTED:	DATE:
VERIFIED:	DATE:

DRAWING No.  
**13-005**

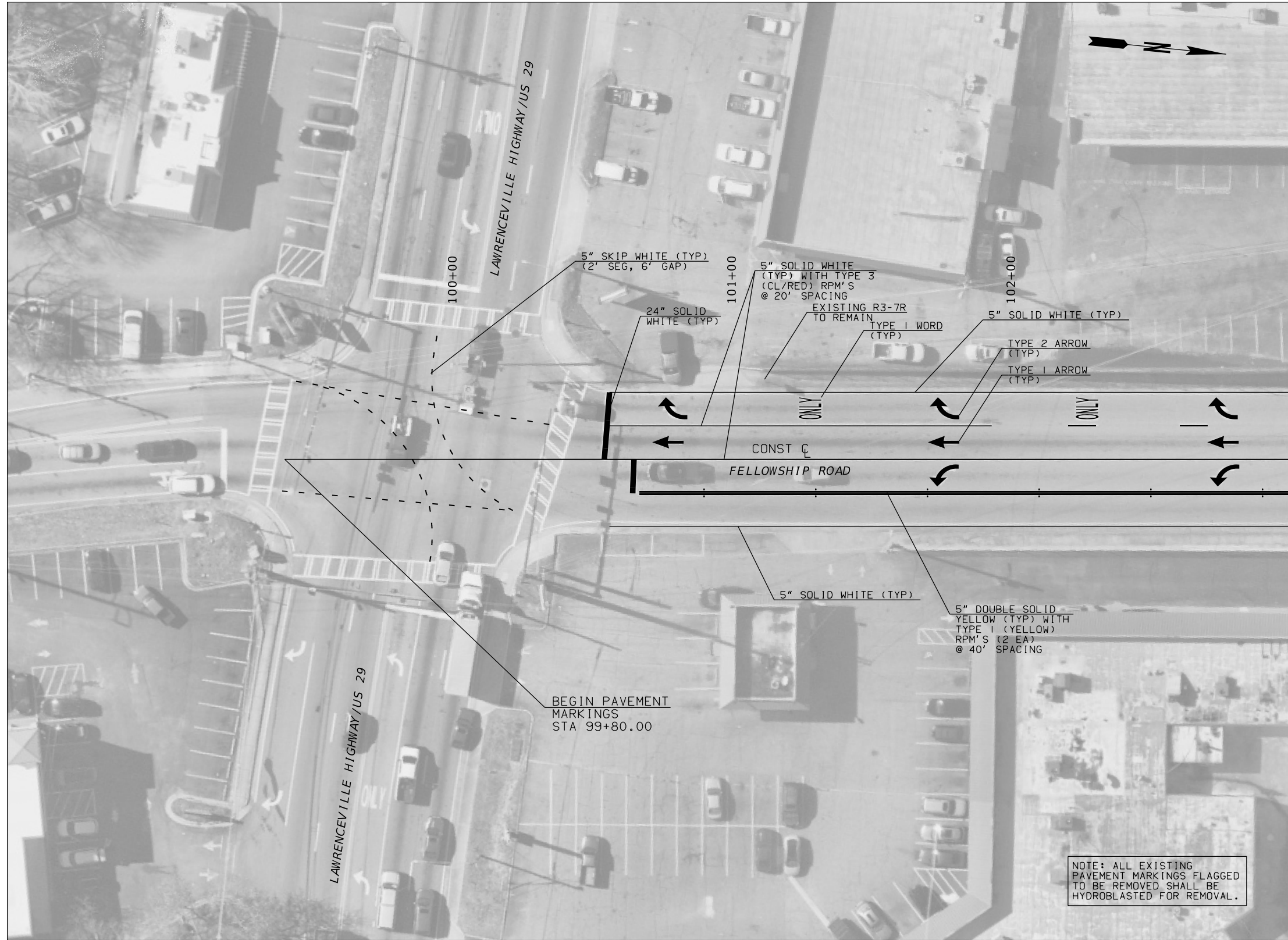

MATCH LINE STA. 103+00.00 DRAWING No. 26-0002

NOTE: ALL EXISTING PAVEMENT MARKINGS FLAGGED TO BE REMOVED SHALL BE HYDROBLASTED FOR REMOVAL.

PROPERTY AND EXISTING R/W LINE -----#-----

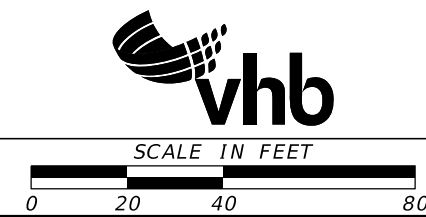

REVISION DATES

NO.	DATE	DESCRIPTION

SIGNING AND MARKING PLANS  
FELLOWSHIP ROAD  
SAFETY IMPROVEMENTS

CHECKED:	DATE:	DRAWING No. <b>26-001</b>
BACKCHECKED:	DATE:	
CORRECTED:	DATE:	
VERIFIED:	DATE:	

REVISIONS  
NO. DATE DESCRIPTION  
1 11/05/2020  
2 11/05/2020  
3 11/05/2020  
4 11/05/2020



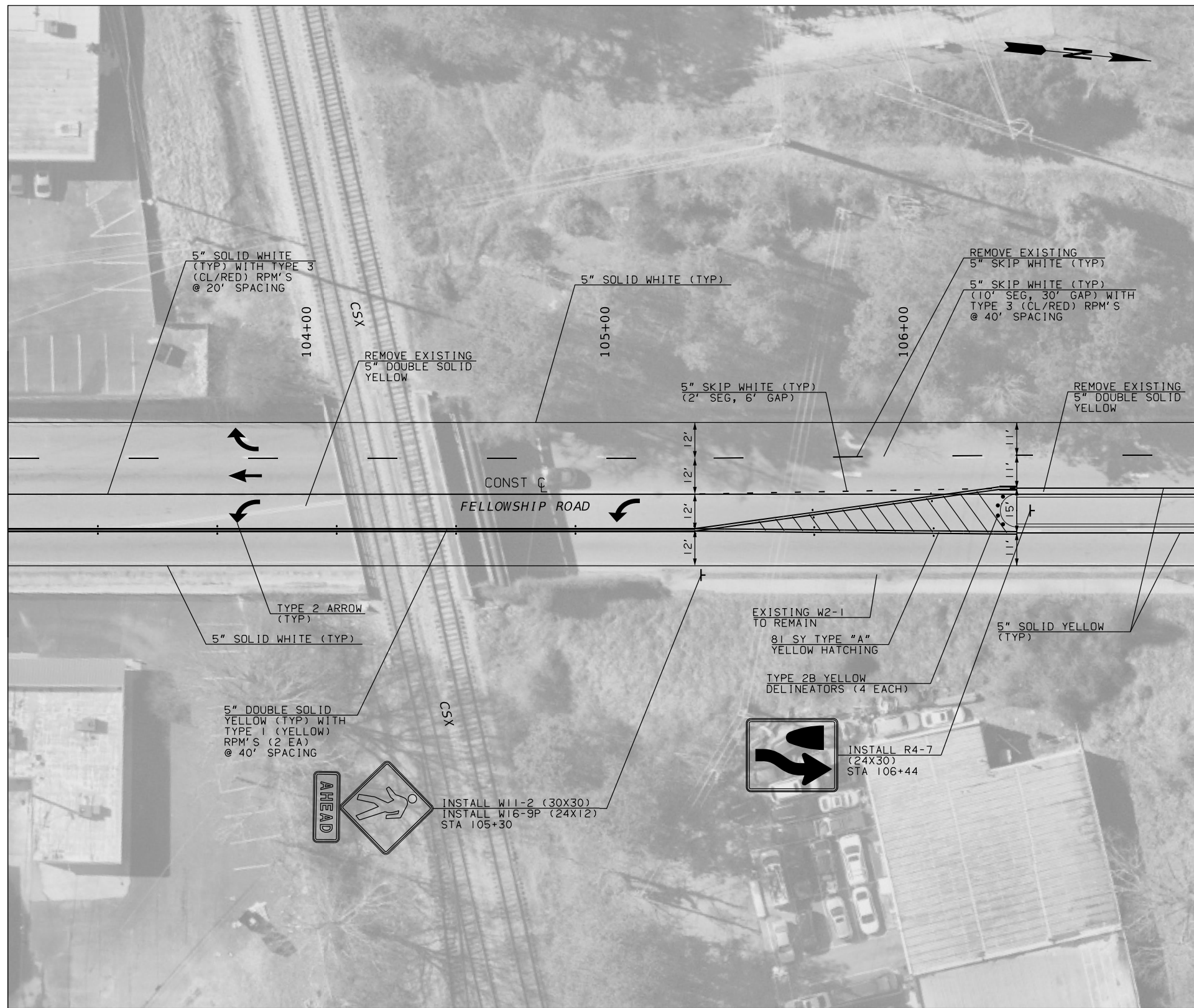

MATCH LINE STA. 103+00.00 DRAWING No. 26-0001

MATCH LINE STA. 107+00.00 DRAWING No. 26-0003

DATE: 11/05/2020  
DRAWN BY: [Name]  
CHECKED BY: [Name]  
SCALE: AS SHOWN

DATE: 11/05/2020  
DRAWN BY: [Name]  
CHECKED BY: [Name]  
SCALE: AS SHOWN

PROPERTY AND EXISTING R/W LINE -----#-----

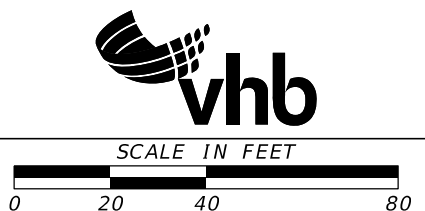

REVISION DATES	

SIGNING AND MARKING PLANS  
FELLOWSHIP ROAD  
SAFETY IMPROVEMENTS

CHECKED:	DATE:
BACKCHECKED:	DATE:
CORRECTED:	DATE:
VERIFIED:	DATE:

DRAWING No.  
**26-002**



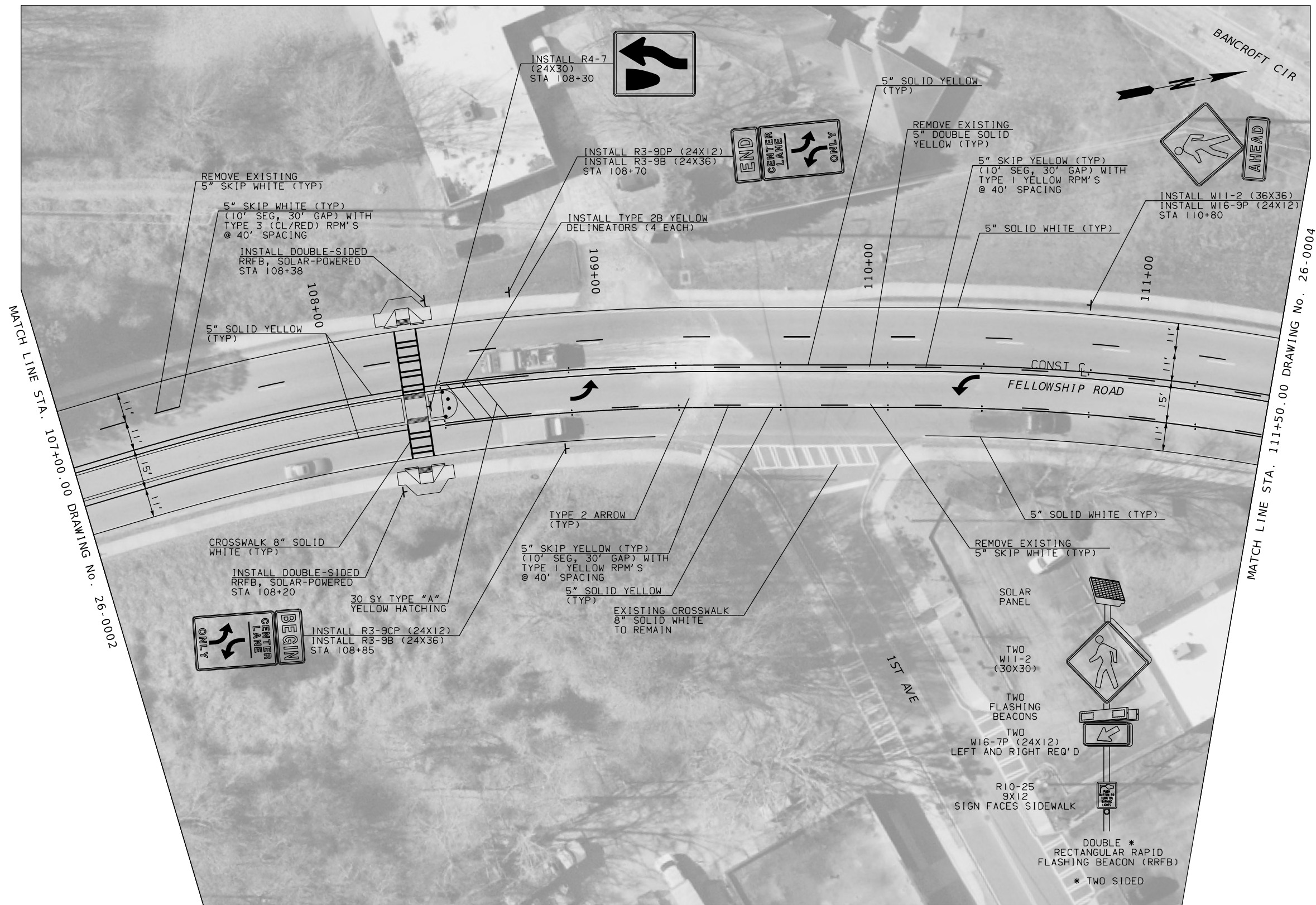

MATCH LINE STA. 107+00.00 DRAWING No. 26-0002

MATCH LINE STA. 111+50.00 DRAWING No. 26-0004

PROPERTY AND EXISTING R/W LINE

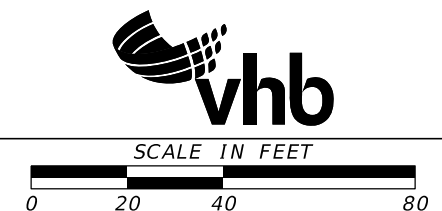

REVISION DATES	

SIGNING AND MARKING PLANS  
FELLOWSHIP ROAD  
SAFETY IMPROVEMENTS

CHECKED:	DATE:	DRAWING No.
BACKCHECKED:	DATE:	26-003
CORRECTED:	DATE:	
VERIFIED:	DATE:	

11/05/2020  
11/05/2020  
11/05/2020  
11/05/2020





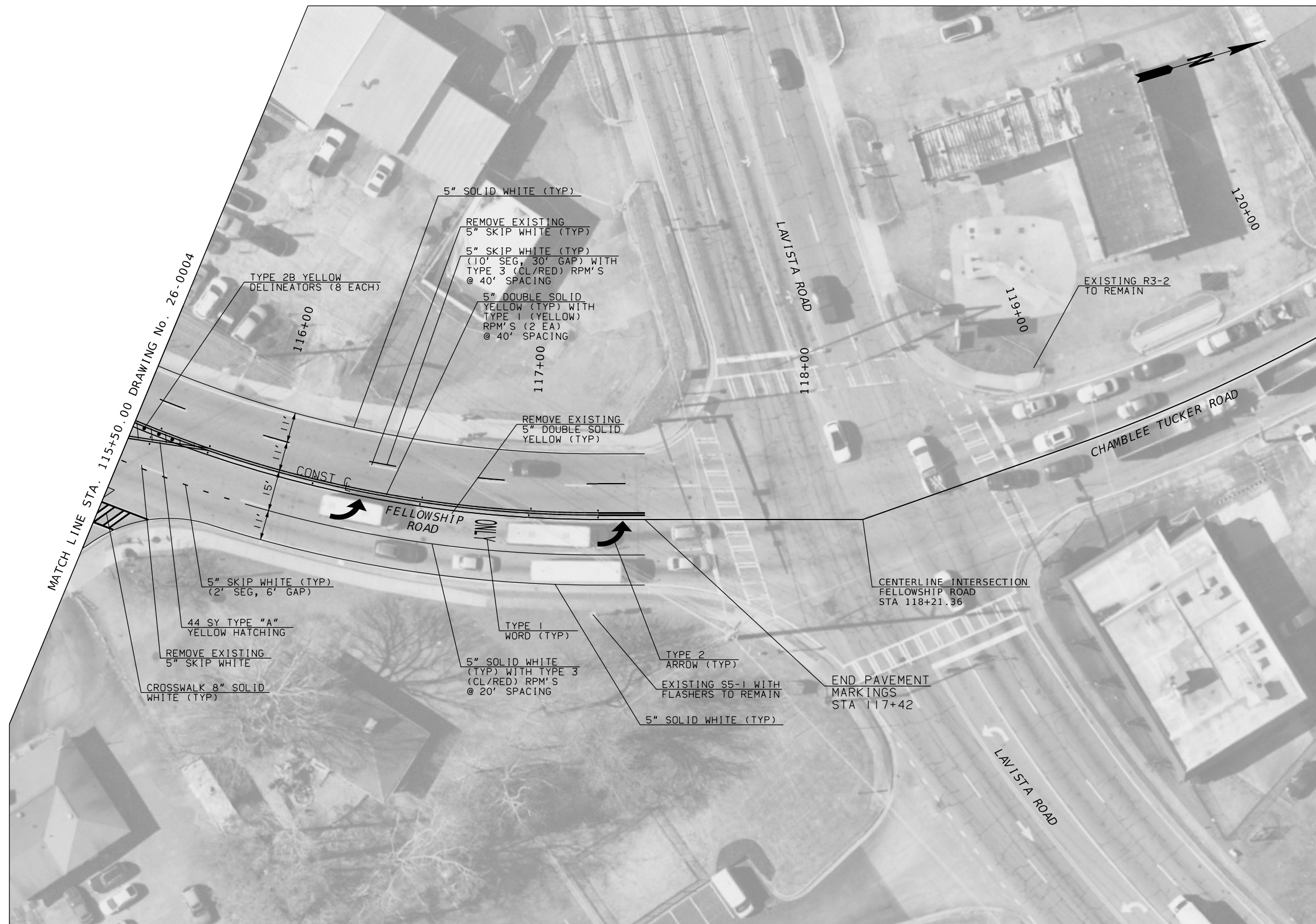

MATCH LINE STA. 115+50.00 DRAWING No. 26-0004

PROPERTY AND EXISTING R/W LINE -----#-----

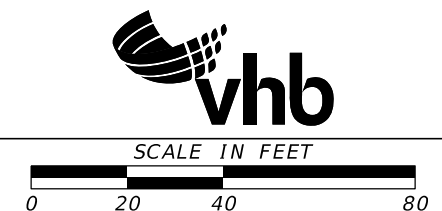

REVISION DATES		

SIGNING AND MARKING PLANS FELLOWSHIP ROAD SAFETY IMPROVEMENTS			
CHECKED:		DATE:	
BACKCHECKED:		DATE:	
CORRECTED:		DATE:	
VERIFIED:		DATE:	
DRAWING No.			26-005

SHEET NO. 11/05/2020  
 SHEET NO. 11/05/2020  
 SHEET NO. 11/05/2020  
 SHEET NO. 11/05/2020

PHASING DIAGRAM

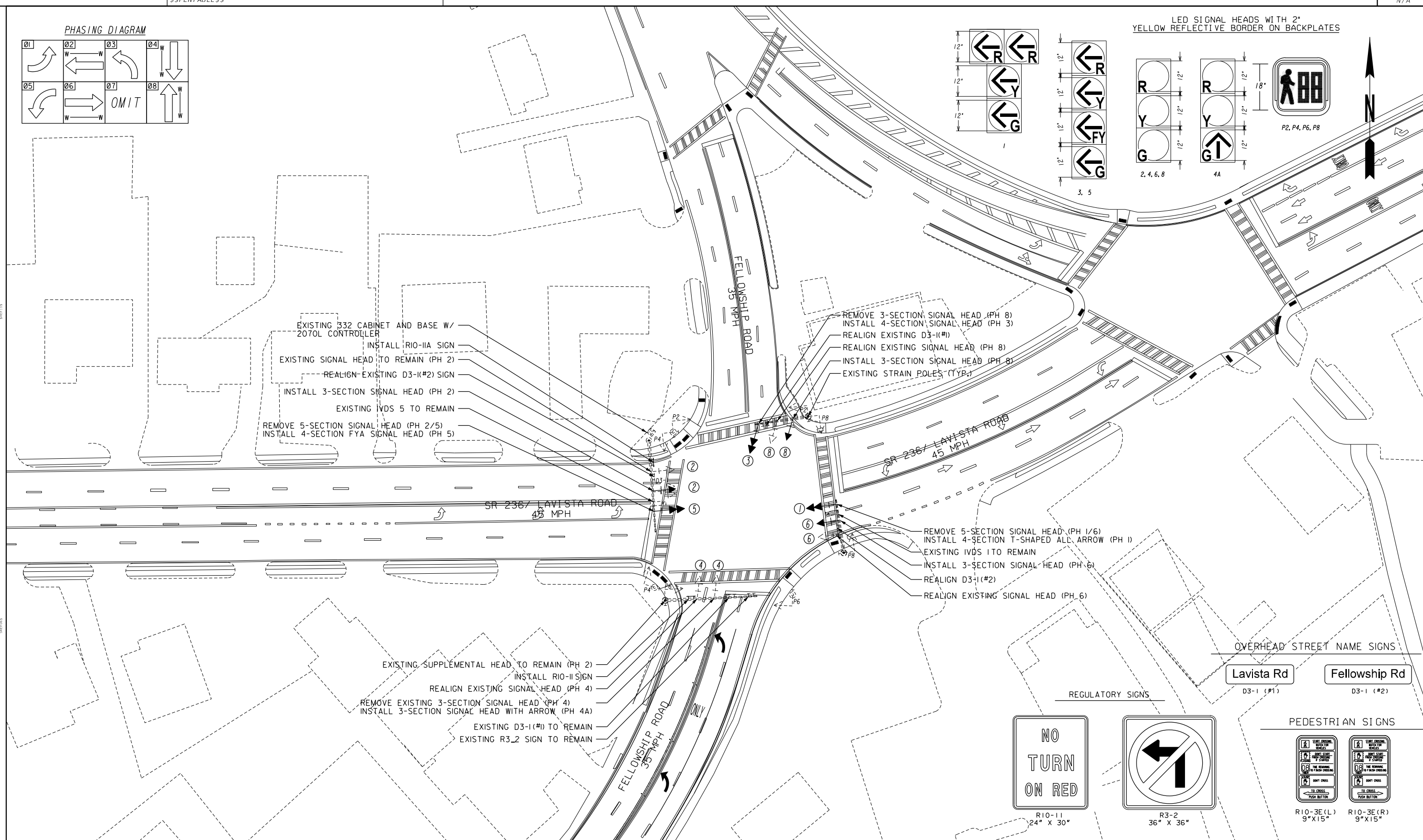
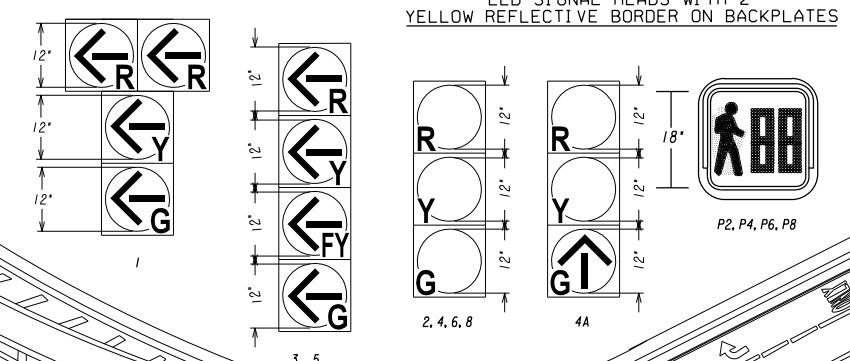
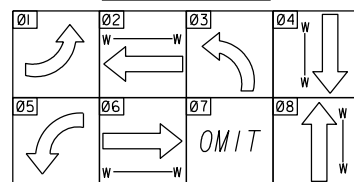

SIGNAL LEGEND

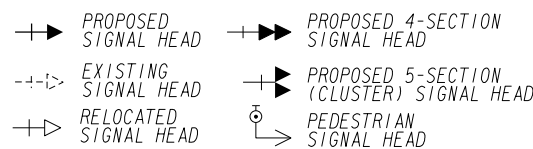

DETECTION LEGEND

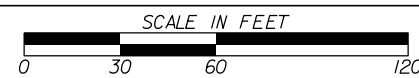
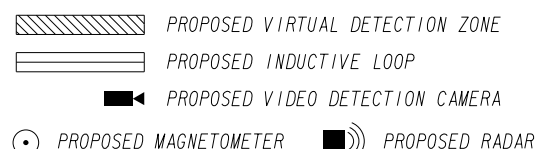

REVISION DATES

NO.	DATE	DESCRIPTION

SIGNAL PLANS  
FELLOWSHIP ROAD  
SAFETY IMPROVEMENTS

CHECKED:	DATE:	DRAWING No.
BACKCHECKED:	DATE:	27-001
CORRECTED:	DATE:	
VERIFIED:	DATE:	

DATE PLOTTED: 11/05/2020 10:00 AM  
PLOTTER: HP PLOTTER  
SCALE: 1" = 100'



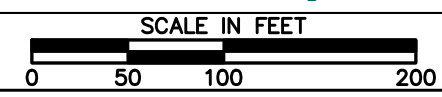
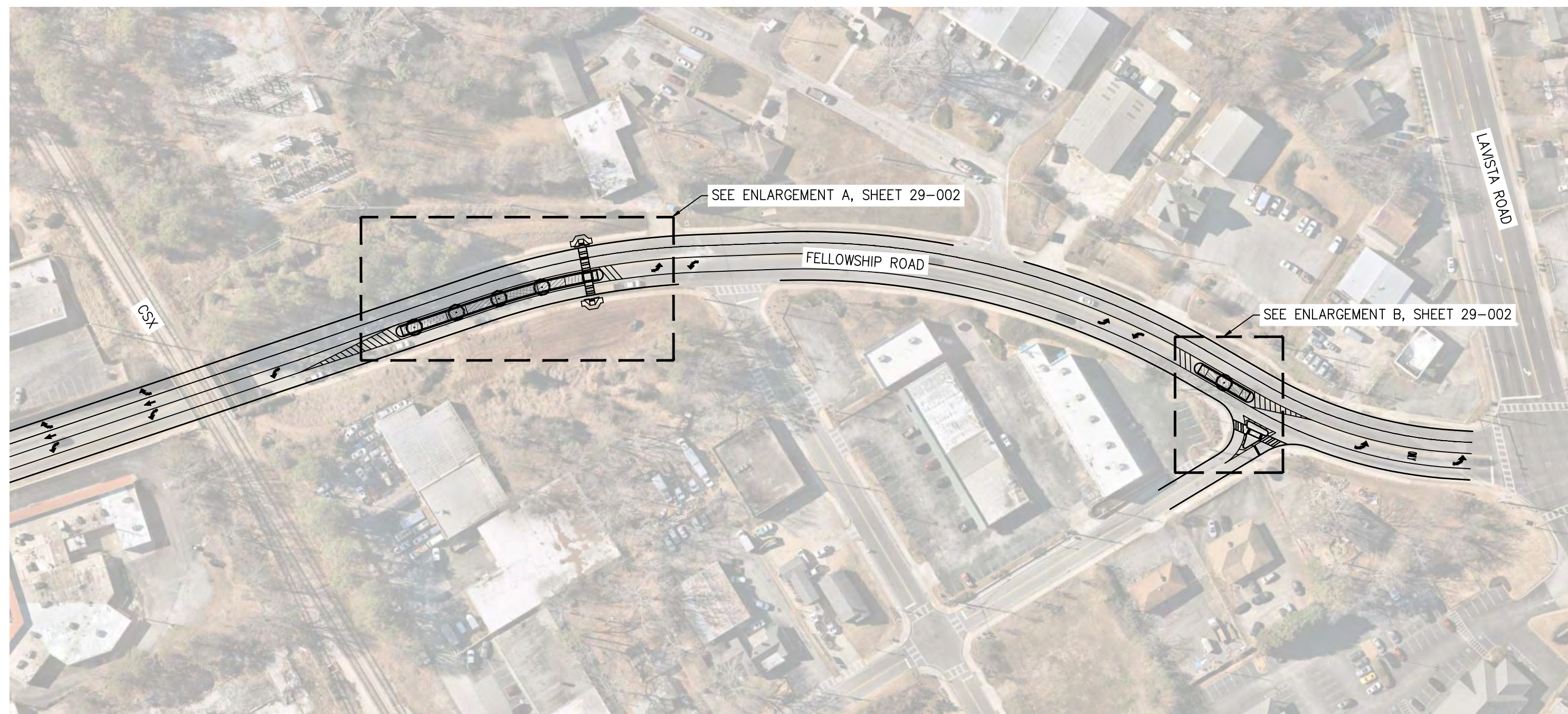

REVISION DATES		

OVERALL LANDSCAPE PLAN  
FELLOWSHIP ROAD  
SAFETY IMPROVEMENTS

CHECKED:		DATE:		DRAWING No. <b>29-001</b>
BACKCHECKED:		DATE:		
CORRECTED:		DATE:		
VERIFIED:		DATE:		



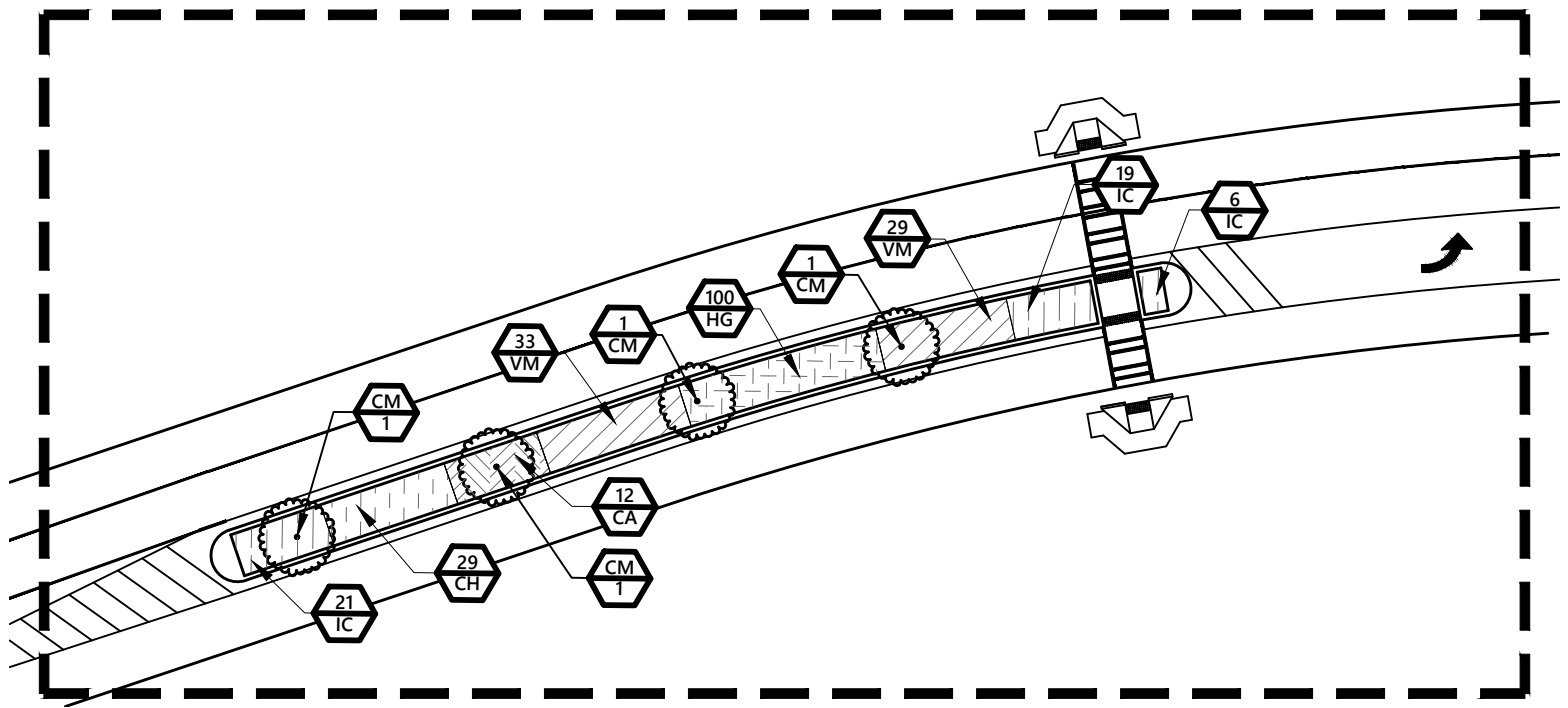

**PLANT LEGEND**

SYMBOL   CODE   COMMON NAME

**TREES**



CM   Merlot Redbud

**SHRUB AREAS**



CH   Hummingbird Summersweet



IC   Little Henry Sweetspire



VM   Mrs. Schillers Delight Viburnum



CA   New Jersey Tea



IS   Schillings Yaupon Holly



HG   Shrubby St. Johns Wort

**A** LANDSCAPE PLAN ENLARGEMENT

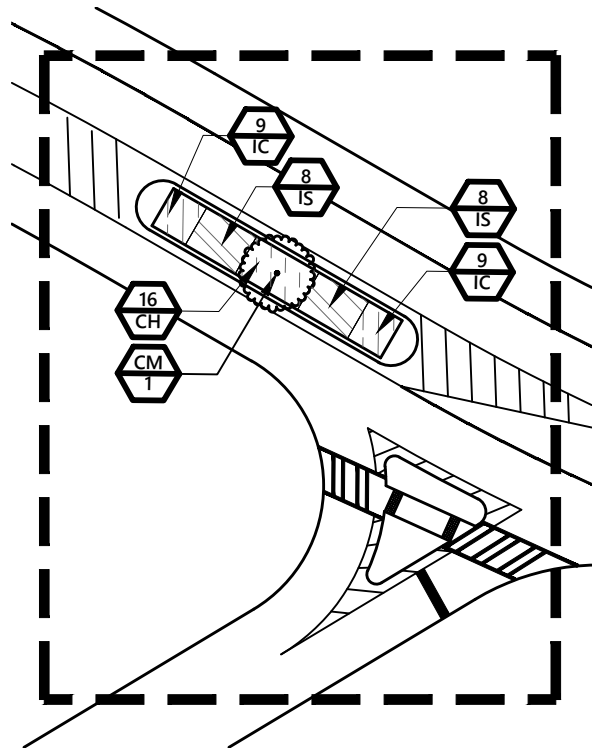

**B** LANDSCAPE PLAN ENLARGEMENT

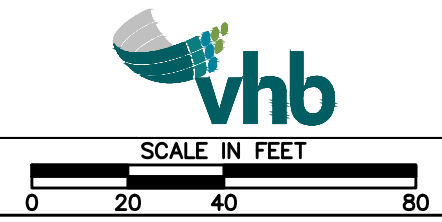





REVISION DATES		

LANDSCAPE PLAN ENLARGEMENTS  
FELLOWSHIP ROAD  
SAFETY IMPROVEMENTS

CHECKED:	DATE:	DRAWING No. <b>29-002</b>
BACKCHECKED:	DATE:	
CORRECTED:	DATE:	
VERIFIED:	DATE:	

### PLANT SCHEDULE

<u>SYMBOL</u>	<u>CODE</u>	<u>COMMON NAME</u>	<u>BOTANICAL NAME</u>	<u>QTY</u>	<u>REMARKS</u>
<b>TREES</b>					
	CM	Merlot Redbud	Cercis x 'Merlot'	5	2.5" cal. Multi-trunk, 2 min., Full and Well branched

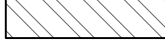
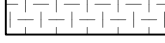
<u>SYMBOL</u>	<u>CODE</u>	<u>COMMON NAME</u>	<u>BOTANICAL NAME</u>	<u>SPACING</u>	<u>QTY</u>	<u>REMARKS</u>
<b>SHRUB AREAS</b>						
	CH	Hummingbird Summersweet	Clethra alnifolia 'Hummingbird'	36" o.c.	45	1 gal. Full and Vigorous
	IC	Little Henry Sweetspire	Itea virginica 'Little Henry'	36" o.c.	64	1 gal. Full and Vigorous
	VM	Mrs. Schillers Delight Viburnum	Viburnum obovatum	36" o.c.	62	3 gal. Full and Vigorous
	CA	New Jersey Tea	Ceanothus americanus	48" o.c.	12	3 gal. Upright, Full and Vigorous
	IS	Schillings Yaupon Holly	Ilex vomitoria 'Schillings'	48" o.c.	16	3 gal. Full and Vigorous
	HG	Shrubby St. Johns Wort	Hypericum frondosum	24" o.c.	100	1 gal. Full and Vigorous



REVISION DATES		

PLANT SCHEDULE  
FELLOWSHIP ROAD  
SAFETY IMPROVEMENTS

CHECKED:	DATE:	DRAWING No.
BACKCHECKED:	DATE:	29-003
CORRECTED:	DATE:	
VERIFIED:	DATE:	

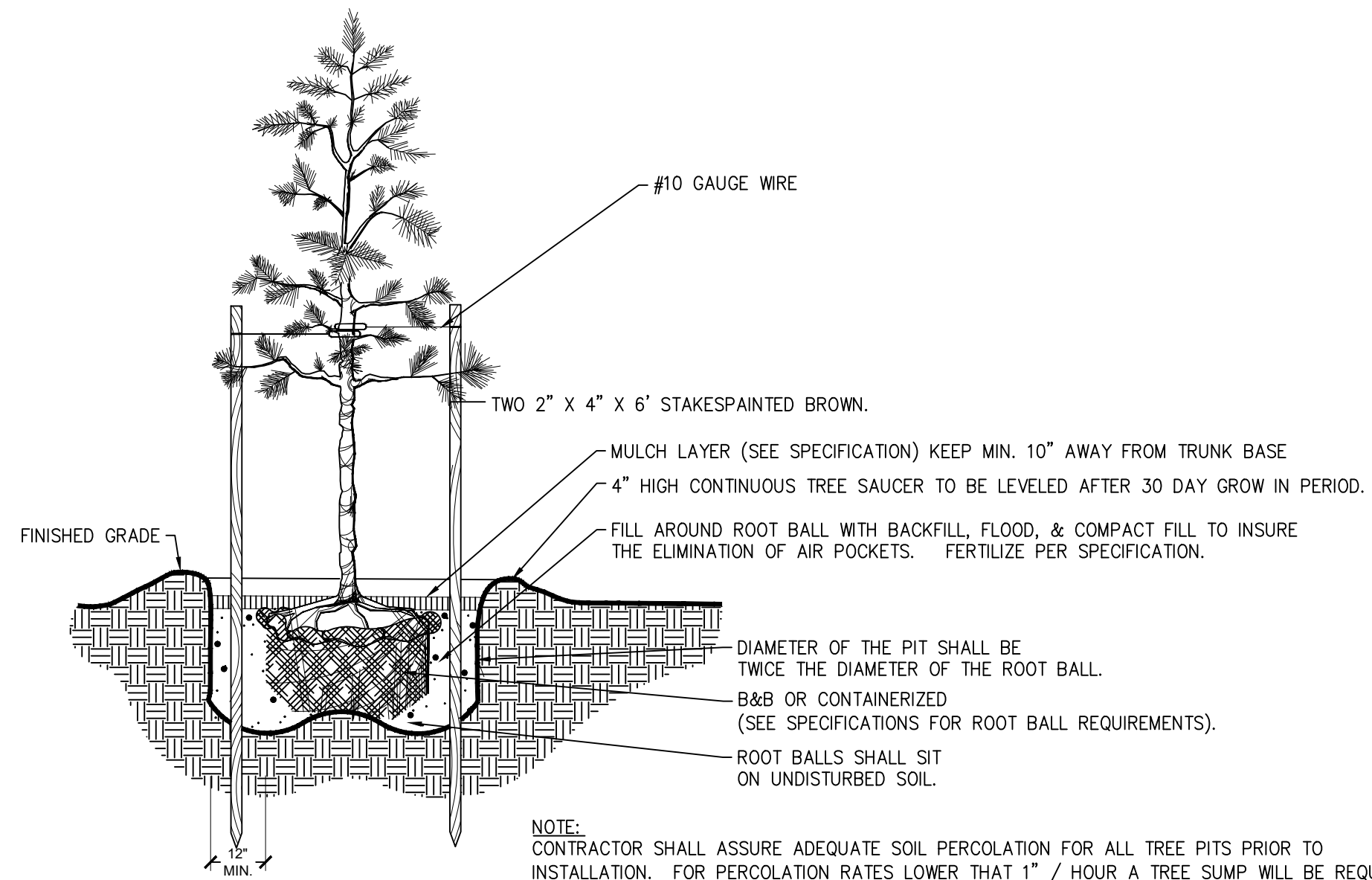

A SMALL TREE INSTALLATION DETAIL  
SCALE: NTS



REVISION DATES		

PLANTING DETAILS  
FELLOWSHIP ROAD  
SAFETY IMPROVEMENTS

CHECKED:	DATE:	DRAWING No. 29-004
BACKCHECKED:	DATE:	
CORRECTED:	DATE:	
VERIFIED:	DATE:	



**NOTES:**

1. CONTRACTOR SHALL ASSURE FREE DRAINAGE/PERCOLATION OF ALL PLANTING PITS/BEDS PRIOR TO INSTALLATION.
2. PLANT MATERIAL SHALL BE PLANTED 2" HIGH WITH SOIL MOUNDING UP TO THE TOP OF ROOT BALL.
3. WHEN GROUNDCOVERS AND SHRUBS USED IN MASSES, ENTIRE BED TO BE EXCAVATED TO RECEIVE PLANTING SOIL AND PLANT MATERIAL - EXCEPT WHERE SPECIFIED.

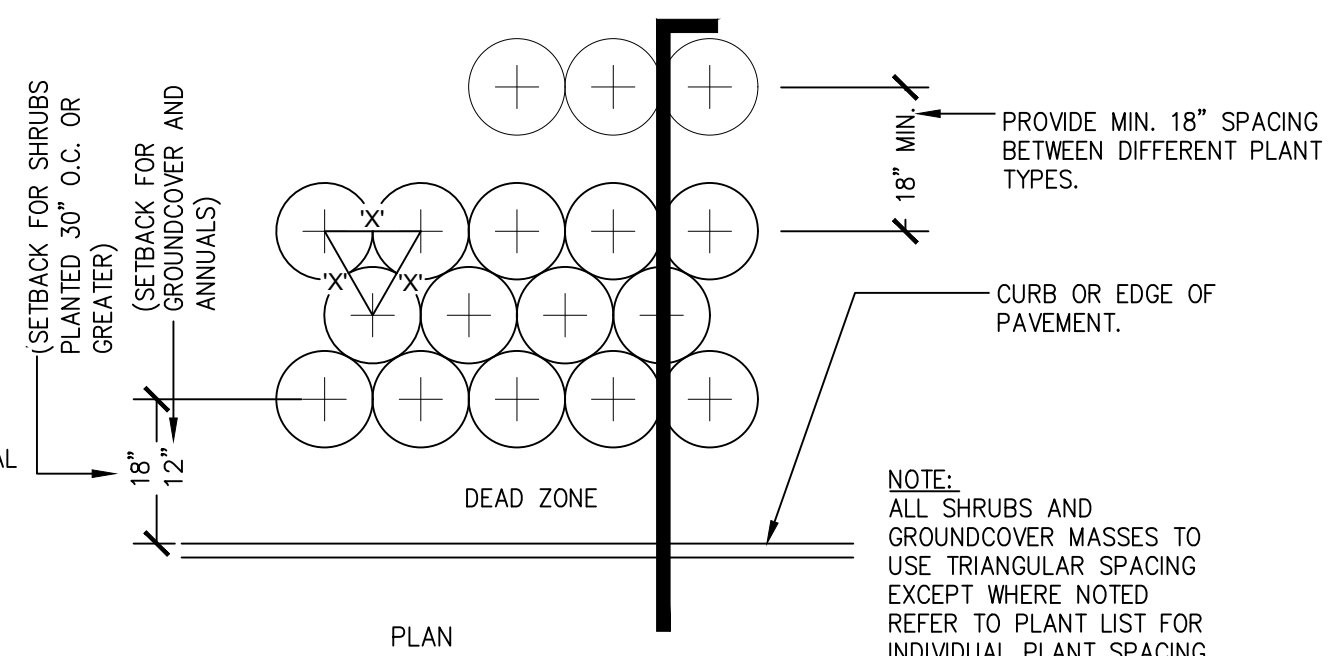
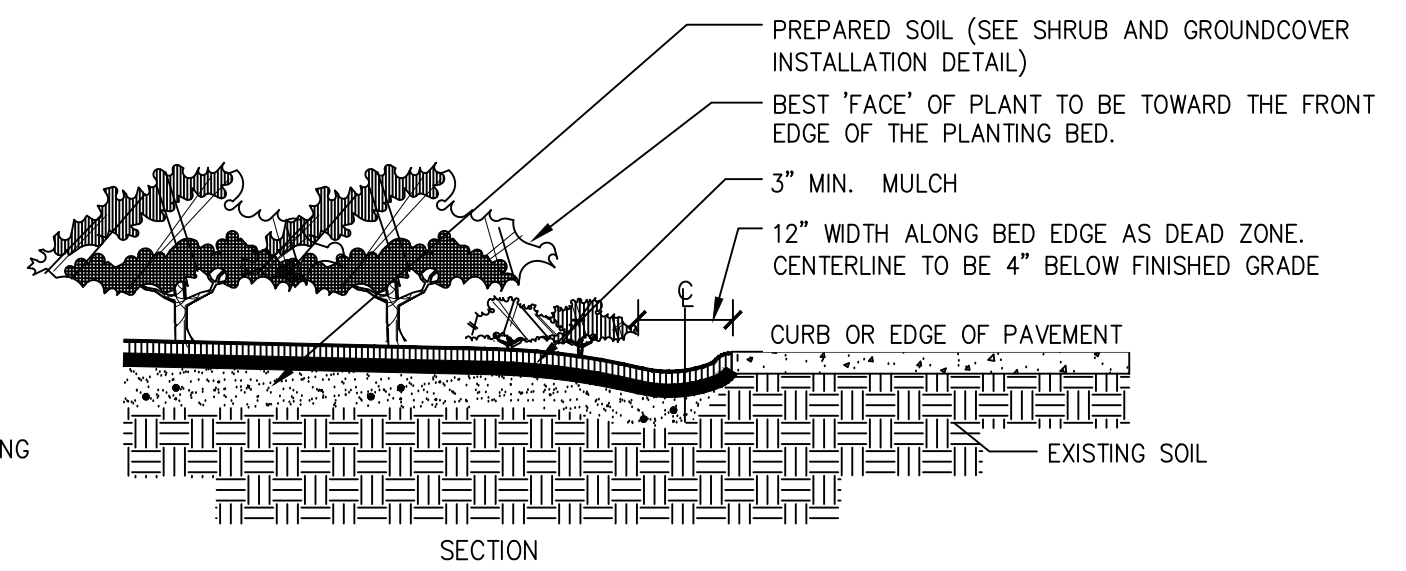
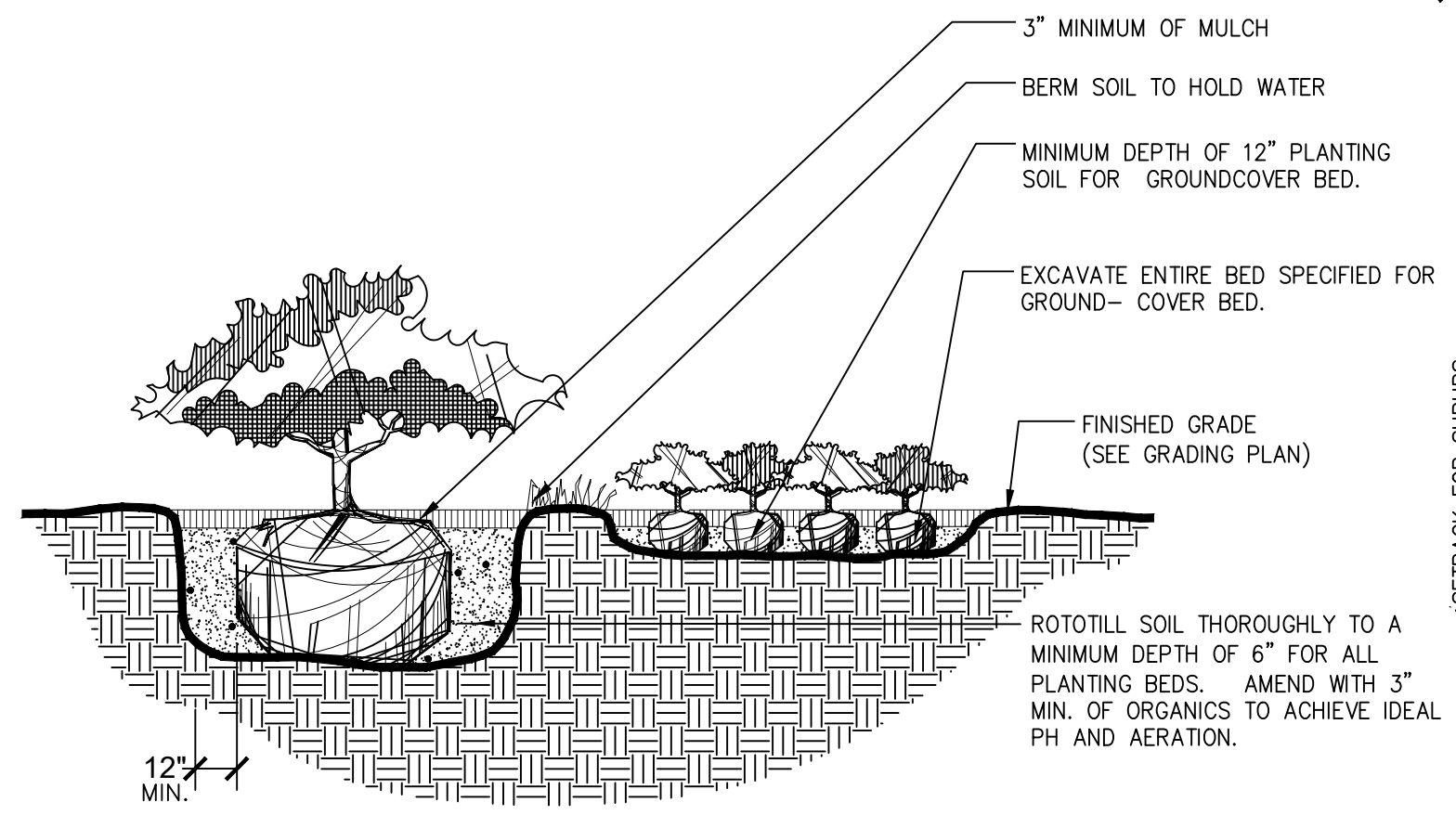

**NOTE:**  
ALL SHRUBS AND GROUND COVER MASSES TO USE TRIANGULAR SPACING EXCEPT WHERE NOTED REFER TO PLANT LIST FOR INDIVIDUAL PLANT SPACING 'X'.

**A** SHRUB AND GROUND COVER INSTALLATION DETAIL  
SCALE: NTS



REVISION DATES		

PLANTING DETAILS  
FELLOWSHIP ROAD  
SAFETY IMPROVEMENTS

CHECKED:		DATE:		DRAWING No. <b>29-005</b>
BACKCHECKED:		DATE:		
CORRECTED:		DATE:		
VERIFIED:		DATE:		

GENERAL LANDSCAPE NOTES

- 1) All on-site existing conditions including surface and subsurface utilities, grades, dimensions and soil conditions shall be verified by the contractor before construction begins. The contractor shall become familiar with all plans prepared by others that affect the landscape and irrigation work. Any discrepancies shall be brought to the attention of the owner's representative.
- 2) Every possible safeguard shall be taken to protect building surfaces, equipment, furnishings, curbs, utilities and existing planting areas to remain including lawn. The contractor is responsible for any damage or injury to person or property that may occur as a result of negligence in the execution of the contractor's work.
- 3) The contractor shall interface with other work being performed by other contractors. It will be necessary for the contractor to coordinate and schedule activities, where necessary, with other contractors and their subcontractors. The landscape contractor shall insure that their work does not impact established or projected drainage patterns.
- 4) Prior to planting installation, the contractor shall confirm the availability of all the specified plant materials and make arrangements with the owner's representative and owner's representative to review and mutually field tag agreed upon plant materials at least one (1) week prior to delivery to site.
- 5) All plant material sizes specified are minimum sizes. All container and tree caliper sizes are minimum. Container or caliper size may be increased if necessary to provide overall plant size specified.
- 6) The contractor shall be responsible for removing existing vegetation as required and preparing planting areas prior to installation of plant materials.
- 7) The landscape contractor shall test project soils to verify that the soils on-site are acceptable for proper growth of plant materials and adequate drainage in plant beds and planters. The landscape contractor shall coordinate the location, and procurement of existing on-site soil samples with the owner's representative. Representative samples shall be submitted to a certified testing laboratory for analysis. The findings, together with recommendations for amending the soils shall be reviewed and approved by the owner, landscape architect, and owner's representative prior to delivery and installation of plant materials at the job.
- 8) The landscape contractor shall insure adequate vertical soil depth and drainage in all plant beds and planters. Excavation of compacted fill shall be accomplished to insure proper soil depth and drainage.
- 9) All planting beds shall be staked in accordance with the plans and approved by the owner's representative prior to planting. The landscape contractor shall provide stakes or irrigation flags to locate the edges of all shrub and groundcover plant beds and individual trees and palms. If existing conditions do not allow the design to be laid out as shown, notify the owner's representative immediately.
- 10) All proposed trees shall be installed either entirely in or entirely out of planting beds. Planting bed outlines shall not be obstructed and shall be smooth and flowing. If trees are located outside planting beds in grass areas, maintain a minimum three feet 3' wide offset to allow for mowers to maneuver.
- 11) The plant quantities shown on the landscape contract documents are for the convenience of the landscape contractor. The landscape contractor is responsible for verifying all quantities and reporting any discrepancies to the owner's representative for clarification prior to contract award and commencement of work.
- 12) The landscape contractor shall verify the extent of sod work in the field, including grass areas damaged during construction. The contractor shall be responsible for providing sod in the areas shown on the plan, in sufficient quantity to provide full coverage. Additional grass required will be adjusted based on a square footage unit price. Areas to be grassed shall be amended per soils report to provide required nutrients and soil ph of between 6.0 and 7.0.
- 13) The landscape contractor shall be responsible for providing plants, spaced as specified on the plant list. When installing shrubs in planting beds, spacing of material shall take precedence over quantity of materials indicated for planting areas. Notify owner's representative immediately if such situations arise. Shrub and groundcover spacing is generally indicated on the plant list for all 'mass plantings'. Accent shrubs and trees that are not part of mass plantings shall be spaced as shown on the plans.
- 14) The landscape contractor shall be responsible for the stability and plumb condition of all installed plant materials. The contractor shall remove all staking materials the end of the grow-in period and dispose offsite.
- 15) All planting beds shall be top-dressed with a 3" layer of mulch as specified. All trees shall have a 3" thick mulch ring placed around the base of the trunk. The landscape scope of work includes mulching as an integral part the project.
- 16) All plant materials shall receive adequate watering by the landscape contractor as required until the landscape irrigation system is fully operational and until final acceptance by owner.
- 17) All existing plant beds to remain within the construction limit line shall be left undisturbed. Existing trees to remain, as noted on the drawings, shall be left undisturbed and protected by wooden barricades erected at the perimeter of the tree drip-line(s). No vehicle shall traverse this area nor shall any storage of materials or equipment be permitted within the area of the tree drip-line(s). Any existing plant beds or trees damaged by construction activity shall be replaced by the responsible party at their own expense.
- 18) No trees shall be planted within designated utility corridors, public right of way nor any plants located within four feet (4') of any swale centerline identified on the drawings. Field adjust as necessary and review adjustments with the owner's representative prior to installation.
- 19) The contractor shall be responsible for removal of all debris and excavated backfill off-site on a daily basis at no additional cost to the owner.
- 20) See landscape specifications for further requirements.

SOIL PREPARATION FOR ALL PLANTED AREAS

- 1) Areas to be planted that are densely compacted, 85% to 90%, shall be cross-ripped to 12 in. depth. Areas over 90% compacted shall be cross-ripped to 24 in. depth, and, over 85% shall be cultivated to achieve 80% or less compaction to a depth of 18". All unacceptable materials shall be removed.
- 2) Soil for planting shall be free of rocks over 1/2 in. in diameter, and free of foreign debris, refuse, plants or roots, clods, weeds, sticks, solvents, petroleum products, concrete, base rock, or other deleterious or undesirable and unwanted materials. Soil shall be free of soil-borne diseases and capable of sustaining healthy plant life. Materials not meeting such requirements shall be removed, including all temporary road bases or pavement already in place.
- 3) In area which will receive import soil, scarify the existing soil 12 in. deep if the soil has been compacted prior to backfilling.
- 4) Backfill planting media for all shrub areas shall be provided at a min. depth of 18" and shall be comprised of the following mixture:
  - 1/3 coarse grain sand
  - 1/3 peat
  - 1/3 native class A soil



REVISION DATES

PLANTING NOTES  
FELLOWSHIP ROAD  
SAFETY IMPROVEMENTS

CHECKED:	DATE:	DRAWING No.
BACKCHECKED:	DATE:	29-006
CORRECTED:	DATE:	
VERIFIED:	DATE:	

LANDSCAPE SPECIFICATIONS

GENERAL:

- G1) Take responsibility for adhering to all requirements stated as outlined herein and on the landscape drawings.
- G2) The scope of work for the landscape contractor for this project shall include the provision of all labor, materials and equipment required to complete all tasks associated with the landscape and irrigation installation as shown on the drawings or noted herein. Take responsibility for coordinating with the general contractor reasonable access to power and potable water sources as required.
- G3) Take responsibility to assign a qualified project manager and field supervisor to work directly with the owner's representative and supervise the work at all times through final owner acceptance. It is the contractor's responsibility to ensure that project manager has a complete current set of documents on-site at all times.
- G4) The landscape contractor for this project must be able to document a minimum of five (5) years of comparable experience in the installation of plant material for projects of similar scale, intensity and quality. General contractor must submit documentation to owner's representative for approval prior to bid award.
- G5) Take responsibility for familiarizing themselves with existing site conditions and notifying the owner's representative in writing of any concerns prior to commencement of work. This evaluation should include, but is not limited to, verification of surface and subsurface utilities, grades, dimensions and soil conditions.
- G6) Take responsibility for familiarizing themselves with project plans and scopes of work related to associated trades to be performed by others in order to identify key coordination items including, but not limited to, site access, material storage, scheduling and sequencing of work. Take responsibility for coordinating all site issues with the general contractor.
- G7) Take responsibility for the protection of all adjacent work, materials and equipment from damage due to their activities. The landscape contractor shall be solely responsible for any damage or injury to person or property that may occur as a result of the execution of their work.
- G8) Take responsibility for the agronomic evaluation of soil characteristics. Evaluation must include chemical analysis by a qualified agricultural soils testing laboratory. Soils sample should be taken immediately following completion of rough grading activities and should be collected at a rate of one sample for each 10,000 square feet of impacted area, or a total of six, whichever is greater. At a minimum the chemical analysis of the soil should consider the following:
  - A. Percentage of organic matter
  - B. Salinity
  - C. ph
  - D. Lime content
  - E. Mineral nutrients including concentrations of nitrogen, phosphorous, potassium. Calcium, magnesium, iron, zinc, manganese, copper, sulfur and molybdenum.
  - F. Potential hazards or impediments for plant growth including salinity, sodium chloride, boron, impaired soil structure or drainage.
  - G. Sand fraction analysis as a percent passing through 1", 1-1/4" and no. 200 sieves.
  - H. Percolation rate in inches per hour. The analysis should also include specific recommendations to the owner's representative for any amendments and backfill mixes for optimal plant growth to be made to the soils prior to planting. The contractor should include the cost of this soil testing in their base bid as well as the basic backfill mixes specified herein but should include any anticipated cost for soil amendment. The contractor is to provide the owner's representative with copies of all soil testing results. Submittal documentation must also contain a graphic site plan depicting locations and depth from which each sample was drawn.
- G9) Take responsibility for confirming the quantities of each plant material required to adequately cover the area shown on the landscape plans at the prescribed spacing and notifying the owner's representative immediately of any perceived discrepancies for two (2) days prior to planting.
- G10) Take responsibility to refer to the following references in determining compliance with best practices:
  - A. "Cabling, Bracing and Guying Standards for Shade Trees" as published by the national arborist association (NAA).
  - B. ANSI A300 1995 Standards as established by the Tree, Shrub and Other Woody Plant Maintenance Standard Practice.
  - C. ANSI, Z60.1-American Standard For Nursery Stock.
  - D. "Standard Plant Names" as established by Hortus III.
- G11) The owner's representative reserves the right to defer any and all review responsibilities related to landscape to the project Landscape Architect or other authorized agent.
- G12) Take responsibility to grant the owner the following warranty for a period of one year (365 days) from the date of final acceptance for all trees, shrubs and groundcovers. The warranty period for sod shall be six months (180 days). It is understood that the warranty is to be inclusive of all labor, materials and equipment necessary for the replacement of any defective plant materials. Warranty is intended to cover defects and unsatisfactory growth caused by no fault of the owner. During the warranty period the landscape contractor shall make every reasonable effort to replace any dead, dying or diseased material within a period of 15 working days

- G13) The plant quantities shown on the landscape contract documents are for the convenience of the landscape contractor. Take responsibility for verifying all quantities and reporting any discrepancies to the landscape architect for clarification prior to contract award and at commencement of work.
- G14) Take responsibility to verify the extent of grassing work in the field. The contractor shall be responsible for providing grass in the areas shown on the plan in sufficient quantity to provide full coverage. Additional grass required will be adjusted based on a square footage unit price. Areas to be grassed shall be amended per soils report to provide required nutrients and soil ph of between 6.0 and 7.0.
- G15) Take responsibility for providing plants, spaced as specified on the plant list. When installing shrubs in planting beds, spacing of material shall take precedence over quantity of materials indicated for planting areas. Notify landscape architect immediately if such situations arise. Shrub and groundcover spacing is generally indicated on the plant list for all 'mass plantings'. Accent shrubs and trees that are not part of mass plantings shall be spaced as shown on the plans.

PRODUCT:

- P1) Take responsibility for confirming the availability of all the specified plant materials within two (2) weeks of project award. All requests for substitution due to lack of availability must be made to the owner's representative in writing within this period. No substitution shall be permitted without prior written approval from the owner's representative. Take responsibility for exhausting all means possible to obtain the materials as specified prior to requesting substitution. In order to be considered by the owner's representative as viable alternates plants must share the same general appearance/ form, installation size, mature size, color, quality and growth habit. Materials must be offered at no additional costs to the owner.
- P2) The owner's representative reserves the right to review and approve all plant materials, including sod, at their source nursery with the landscape contractor prior to delivery to the job site. It is the responsibility of the landscape contractor to coordinate and schedule all nursery trips with the landscape architect or owner's representative a minimum of two weeks prior to the schedule date for material delivery for shipping. The landscape contractor is to provide a minimum of one week to the owner's representative for all trips. The owner also reserves the rights to have the nursery review of material or to provide approval through review of photographs or representative samples.
- P3) All plant material suppliers, including sod, for this project must be able to document a minimum of five (5) years of experience in the specialization of growing and cultivation of comparable materials as specified for this project. Take responsibility to provide documentation to the owner's representative for approval prior to procuring material.
- P4) In preparation for the delivery to the site the landscape contractor shall only prune branches or roots after notifying owner's representative. Pruning should only be performed as required to assure safe loading, shipping and job site handling. In no case can any tree be topped. Prior to shipping all trees should be sprayed for insects and fungus as well as a foliar anti-dessicant.
- P5) Balled and burlap trees should be dug and prepared for shipment in a manner that will not damage roots, branches, shape and future development after planting. Trees should be root pruned 30 days prior to digging and hardened off at the nursery for a minimum of 30 days prior to shipping. In addition to rootball irrigation the nursery should provide overhead mist irrigation for the duration of this period. The product received on-site should have a firm ball with natural soils. Dried, cracked or broken rootballs will not be accepted. Rootballs should be sized at a minimum dia. ratio of 12" of rootball for each 1" of tree caliper.
- P6) Take responsibility for the preparation of soils within all planting areas inclusive of providing all imported soil materials, soil amendments, soil conditioners and fertilizers as required.
- P7) Soil preparation is to include the following fertilizer with the understanding that soil mix design may need to be adjusted based on outcome of agronomic testing:
  - A. Trees, 100% site soil with 5 lb. Milorganite per cu. yd.
  - B. Shrubs, 100% site soil with Osmocote controlled release fertilizer (17-11-10) per manufacturer's recommendation.
- P8) Should owner's representative and contractor agree with the recommendation of the testing agency to further amend the soils the contractor's contract will be adjusted accordingly. The contractor shall be required to submit samples of amended soils to be re-tested to confirm compliance with recommendations following the same procedures as the original tests.
- P9) Take responsibility to provide the owner's representative with one quart, sealed and labeled bag of soil from same location that test samples here drawn. The owner reserves the right to obtain secondary analysis to confirm test results at their expense.
- P10) Take responsibility to provide the owner's representative with one quart sealed and labeled bag of any imported soil material amendment or conditioner used in the preparation of the planting areas.
- P11) The owner's representative reserves the right to review and approve all plant material at the job site prior to installation to ensure that the delivered state of the materials is in compliance with the material specifications contained herein. In the advent that delivered material does not comply with the project requirements the owner reserves the right to reject such materials and require the landscape contractor to remove and replace rejected materials at no additional cost to the owner. The landscape contractor shall remove rejected plants and materials from the project area and replace with acceptable materials.



REVISION DATES

LANDSCAPE SPECIFICATIONS  
FELLOWSHIP ROAD  
SAFETY IMPROVEMENTS

CHECKED:	DATE:	DRAWING No. 29-007
BACKCHECKED:	DATE:	
CORRECTED:	DATE:	
VERIFIED:	DATE:	



- P12) All plant material shall meet or exceed the requirements for Georgia No. 1 quality in accordance with the grades and standards for nursery plants published by the state of Georgia, department of agriculture, current edition. All plant material is to be sourced from a nursery unless specifically noted to be collected.
- P13) All plant material sizes specified are minimum sizes at time of installation. All container and tree caliper sizes are minimum. Container or caliper size may be increased if necessary to provide overall plant size specified. Material height and width specified in landscape schedule is based on branches in their normal position. Specified caliper is to be measured at a point 12" above the ground.
- P14) All plant material must be delivered to the project site and installed in good health, free of pest, pest eggs, fungus and disease. Root systems shall be vigorous and fibrous, filling the container but shall not be root bound or exhibit spiraling roots. Verification of the health and vigor of all plant material is the sole responsibility of the landscape contractor.

**EXECUTION:**

- E1) Take responsibility for ensuring all work (including delivery, storage and disposal of their materials) is performed in compliance with applicable jurisdictional codes.
- E2) Take responsibility for maintaining the area, materials and equipment within the limits of work in a safe, neat and orderly manner. Excess materials and debris are to be removed from the work area no less than daily or as directed by the general contractor.
- E3) Take responsibility for maintaining work activities within the limits of work and performing work at times, and in a manner, as prescribed by the general contractor.
- E4) Take responsibility for any excavation in the vicinity of pre-existing or newly installed utilities with the general contractor. It is the responsibility of the landscape contractor to notify the owner's representative a minimum of 48 hours prior to digging for field verification of all underground utilities and other elements. Take responsibility for prior to initiating operations emergency repair plans and any possible service interruption(s) on-site and off. The landscape contractor shall bear the sole responsibility of any damage to subsurface utilities caused by their work. Return of services to off-site areas (if any) must be immediate.
- E5) Take responsibility to take precautions to protect all existing site roads, parking lots, curbs and utilities from damage. This applies not only to the area within the limits of work but also along any local access roads or roadways internal to the project.
- E6) Take responsibility for all necessary safety measures during construction operations to protect the public according to all applicable codes and recognized local practices.
- E7) Take responsibility for with general contractor to ensure that temporary erosion and sedimentation control measures (silt fence, geo fence and/or other measures) are installed prior to beginning excavation.
- E8) Take responsibility for the maintenance of all plant materials and the planting areas until final acceptance by the owner's representative
- E9) The owner's representative will not review any change order requests from the landscape contractor related to 'extra' work performed without prior written authorization from the owner's representative.
- E10) Take responsibility for scheduling deliveries of sod so that all deliveries to site will be installed no more than 24 hours from the time it arrives on site. The amount of sod delivered to the site at any one time should not exceed the amount that can be laid under these time constraints.
- E11) Take responsibility to exercise care in the placement of sod. Sod should be laid with staggered rows running parallel to slope contours. In slope situations, begin sod at base of slope and work uphill, all sod should be rolled and fertilized with a granular 16-4-8 fertilizer five days after planting. Newly sodded areas shall be kept moist for the first week after planting after which a watering rate of 2" per week, including rainfall, should be sufficient.
- E12) Take responsibility for eradicating weeds within the limits of all planting areas prior to beginning landscape installation. Perennial weeds and grasses to be removed include, but are not limited to, nut grass, puncture vine, morning glory, dog fennel, torpedo grass, Bermuda grass, Bahia grass, kikuyu grass, crab grass, carpet grass, sedge and other noxious and/or invasive weeds. The site is to be maintained weed free throughout planting operations.
- E13) Take responsibility for pre-tillage to scarify soils in all planting areas to a minimum depth of 4". Densely compacted areas between 85% and 90% are to be cross ripped to a minimum 8" depth. In the process of tilling are unacceptable materials including, but not limited to, foreign debris, construction waste, roots, concrete, asphalt and rocks greater than 1/2" diameter on average. In areas to receive sod till in fertilizer to a depth of 2" at a rate of 12 pounds per cubic ft.
- E14) Take responsibility for the owner's representative with record copies of all shipping receipts for all materials, including plants and sod, delivered to the project site. Delivery of all fertilizer and soil amendment materials must be in original, unopened container's bearing manufacturer's guaranteed chemical analysis, name, trade mark and conformance with state law.
- E15) Take responsibility to store all materials in an area to be determined by the owner's representative. All excess stored materials must be removed prior to final acceptance from the owner.
- E16) Take responsibility for staking all plant materials in the field in accordance with the landscape plans for approval by the owner's representative prior to excavation and installation. Take responsibility for stakes or flags to indicate locations of individual trees whereas all shrub and groundcover materials must be laid out in their containers with the appropriate spacing for owner's representative review and approval. The owner reserves the right to make field adjustments to plant layout as part of this review. Failure by the landscape contractor to obtain layout approval from the owner's representative prior to installation may result in the removal and reinstallation of materials by the contractor at no additional costs to the owner.
- E18) Take responsibility for protecting and maintaining all plant material to remain within the limits of construction as indicated on the plans. Existing trees to remain shall be undisturbed and protected by barricades erected at the perimeter of the tree drip line. No vehicle shall traverse this area nor shall any storage of

- materials or equipment be permitted within this protected area. Bear the sole responsibility of replacement for any damage to protected materials caused by construction activity without additional costs to the owner.
- E19) Take responsibility for establishing and maintaining the stability and plumb condition of all installed plant materials until receiving final acceptance from the owner's representative. The contractor shall be responsible for replacing any plant material which is damaged due to inadequate guying or staking, at no additional cost to the owner. The contractor shall remove all staking materials the end of the warranty period and dispose of properly offsite.
- E20) Should the landscape contractor be required to replace any damaged, diseased, dying or dead plant material it is understood that the replacement material is to be of the same species, size and quality as that originally specified and approved by the owner's representative. Replacement with alternate materials will be permitted only with prior written approval from the owner's representative. The contractor will be responsible for the removal of all materials and leaving the impacted area clean following any remedial action.
- E21) At the end of the warranty period the owner reserves the right to have the contractor replace any declining material or request an extension of up to ninety (90) days on any specific material.
- E22) Take responsibility to install plant materials using the best horticultural practices:
  - A. Protect plant material from damage during delivery, staging and installation.
  - B. Do not begin installation of shrub and groundcover materials prior to completion of irrigation installation and finish grading.
  - C. Do not install plant materials in winds in excess of 30 miles per hour.
  - D. Do not install plant material if deemed site conditions will impede the ability of plant material to thrive without notifying owner's representative of concerns prior to installation.
  - E. Perform all work in accord with all applicable laws, codes and regulations inclusive of all permits and inspections required by federal, state and local jurisdictions.
  - F. The use of cables and chains for the lifting of trees is prohibited. Trees are to be lifted using nylon straps a minimum of 4" in width. Wrap trunks to protect from scraping and scarring.
  - G. The 'choke' strapping method for lifting trees is prohibited.
  - H. Do not drop plant material.
  - I. Limit the amount of plants to be installed per day to those that can adequately be watered in the same day.
  - J. Carefully remove containerized plants from their cans to avoid breaking the rootball. Containers should only be removed immediately prior to installation and plants should be immediately watered after placement.
  - K. Remove burlap and cut steel baskets from at least the top third of the rootball for all B&B material. Remove wire baskets to a minimum depth of 18'.
  - L. Plant material must be installed at correct elevation in relation to finish grade as indicated on the planting details after settling. Plants set at incorrect elevations will need to be raised or lowered accordingly at no additional cost to the owner.
  - M. Set fertilizer tablets on top of rootball for all trees laid out for planting to allow owner's representative to confirm correct amount.
  - N. Planting pits for trees and shrubs must be excavated to the dimensions specified on the planting details. Following planting area immediately surrounding plant is to be tamped firm and use water jet technique to remove all air pockets repeating as required.
  - O. Apply re-wetting agent to the surface of all plant pits for trees and shrubs per manufacturer's recommendations.
  - P. Apply mulch in even layer to depth shown on detail. Do not place mulch without the approval of the owner's representative that weed removal and fine grading requirements have been met.
  - Q. Continuously monitor status of installed materials and make modifications, clean-ups and replacements as required.



REVISION DATES

LANDSCAPE SPECIFICATIONS  
FELLOWSHIP ROAD  
SAFETY IMPROVEMENTS

CHECKED:		DATE:		DRAWING No. <b>29-008</b>
BACKCHECKED:		DATE:		
CORRECTED:		DATE:		
VERIFIED:		DATE:		





## GEORGIA SECURITY AND IMMIGRATION COMPLIANCE ACT AFFIDAVIT

**GEORGIA E-Verify and Public Contracts: The Georgia E-Verify law requires contractors and all sub-contractors on Georgia public contract (contracts with a government agency) for the physical performance of services over \$2,499 in value to enroll in E-Verify, regardless of the number of employees.**

<b>Contractor Name:</b>	
<b>Solicitation/Bid number or Project Description:</b>	

By executing this affidavit, the undersigned contractor verifies its compliance with O.C.G.A. § 13-10-91, stating affirmatively that the individual, entity or corporation which is engaged in the physical performance of services under a contract on behalf of the City of Tucker, Georgia has registered with, is authorized to use and uses the federal work authorization program commonly known as E-Verify, or any subsequent replacement program, in accordance with the applicable provisions and deadlines established in O.C.G.A. § 13-10-91.

Furthermore, the undersigned contractor will continue to use the federal work authorization program throughout the contract period as required by O.C.G.A. § 13-10-91(b) and the undersigned contractor will contract for the physical performance of services in satisfaction of such contract only with subcontractors who present and affidavit to the contractor with the information required by O.C.G.A. § 13-10-91(b). Contractor hereby attests that its federal work authorization user identification number and date of authorization are as follows:

\_\_\_\_\_  
Federal Work Authorization User Identification Number  
(EEV/E-Verify Company Identification Number)

\_\_\_\_\_  
Date of Authorization

\_\_\_\_\_  
Name of Contractor

**I hereby declare under penalty of perjury that the foregoing is true and correct**

\_\_\_\_\_  
Printed Name (of Authorized Officer or Agent of Contractor)

\_\_\_\_\_  
Title (of Authorized Officer or Agent of Contractor)

\_\_\_\_\_  
Signature (of Authorized Officer or Agent)

\_\_\_\_\_  
Date Signed

SUBSCRIBED AND SWORN BEFORE ME ON THIS THE

\_\_\_\_ DAY OF \_\_\_\_\_, 20\_\_\_\_

[NOTARY SEAL]

\_\_\_\_\_  
Notary Public

My Commission Expires: \_\_\_\_\_



## GEORGIA SECURITY AND IMMIGRATION COMPLIANCE ACT AFFIDAVIT

**GEORGIA E-Verify and Public Contracts: The Georgia E-Verify law requires contractors and all sub-contractors on Georgia public contract (contracts with a government agency) for the physical performance of services over \$2,499 in value to enroll in E-Verify, regardless of the number of employees.**

<b>Contractor Name:</b>	
<b>Subcontractor's (Your) Name</b>	
<b>Solicitation/Bid number or Project Description:</b>	

By executing this affidavit, the undersigned subcontractor verifies its compliance with O.C.G.A. § 13-10-91, stating affirmatively that the individual, entity or corporation which is engaged in the physical performance of services under a contract on behalf of the City of Tucker, Georgia has registered with, is authorized to use and uses the federal work authorization program commonly known as E-Verify, or any subsequent replacement program, in accordance with the applicable provisions and deadlines established in O.C.G.A. § 13-10-91.

Furthermore, the undersigned subcontractor will continue to use the federal work authorization program throughout the contract period as required by O.C.G.A. § 13-10-91(b) and the undersigned subcontractor will contract for the physical performance of services in satisfaction of such contract only with sub-subcontractors who present and affidavit to the contractor with the information required by O.C.G.A. § 13-10-91(b). Subcontractor hereby attests that its federal work authorization user identification number and date of authorization are as follows:

\_\_\_\_\_  
Federal Work Authorization User Identification Number  
(EEV/E-Verify Company Identification Number)

\_\_\_\_\_  
Date of Authorization

\_\_\_\_\_  
Name of Subcontractor

**I hereby declare under penalty of perjury that the foregoing is true and correct**

\_\_\_\_\_  
Printed Name (of Authorized Officer or Agent of Contractor)

\_\_\_\_\_  
Title (of Authorized Officer or Agent of Contractor)

\_\_\_\_\_  
Signature (of Authorized Officer or Agent)

\_\_\_\_\_  
Date Signed

SUBSCRIBED AND SWORN BEFORE ME ON THIS THE

\_\_\_\_ DAY OF \_\_\_\_\_, 20\_\_\_\_

\_\_\_\_\_  
Notary Public

[NOTARY SEAL]

My Commission Expires: \_\_\_\_\_

**BID BOND**

KNOW ALL MEN BY THESE PRESENTS, THAT

(Name of Contractor) \_\_\_\_\_ at

(Address of Contractor) \_\_\_\_\_

(Corporation, Partnership and / or Individual) hereinafter called Principal, and

(Name of Surety) \_\_\_\_\_

(Address of Surety) \_\_\_\_\_

A corporation of the State of \_\_\_\_\_, and a surety authorized by law to do business in the State of Georgia, hereinafter called Surety, are held, and firmly bound unto

(Name of Obligee) City of Tucker Georgia

(Address of Obligee) 1975 Lakeside Parkway, Suite 350, Tucker, Georgia 30084

Hereinafter referred to as Obligee, in the penal sum of \_\_\_\_\_ Dollars (\$ \_\_\_\_\_) in lawful money of the United States, for the payment of which sum well and truly to be made, we bind ourselves, our heirs, executors, administrators and successors, jointly and severally, firmly by these presents.

WHEREAS, the Principal is about to submit, or has submitted, to the City of Tucker, Georgia, a proposal for furnishing materials, labor, and equipment for:

**ITB # 2024-011  
FELLOWSHIP ROAD SAFETY IMPROVEMENTS**

WHEREAS, the Principal desires to file this Bond in accordance with law in lieu of a certified Bidder's check otherwise required to accompany this Proposal.

NOW, THEREFORE, the conditions of this obligation are such that if the bid is accepted, the Principal shall within ten days after receipt of notification of the acceptance execute a Contract in accordance with the Bid and upon the terms, conditions, and prices set forth in the form and manner required by the City of Tucker, Georgia, and execute a sufficient and satisfactory Performance Bond and Payment Bond payable to the City of Tucker, Georgia, each in an amount of 100% of the total Contract Price, in form and with security satisfactory to said the City of Tucker, Georgia, and otherwise, to be and remain in full force and virtue in law; and the Surety shall, upon failure of the Principal to comply with any or all of the foregoing requirements within the time specified above, immediately pay to the City of Tucker, Georgia,



upon demand, the amount hereof in good and lawful money of the United States of America, not as a penalty, but as liquidated damages.

PROVIDED, FURTHER, that Principal and Surety agree and represent that this bond is executed pursuant, to and in accordance with the applicable provisions of the Official Code of Georgia Annotated, as Amended, including, but not limited to, O.C.G.A. § 13-10-20, et. Seg. And § 36- 91-50, et. Seg. and is intended to be and shall be constructed as a bond in compliance with the requirements thereof.

Signed, sealed, and dated this \_\_\_\_\_ day of \_\_\_\_\_ A.D., 20 \_\_\_\_.

ATTEST:

\_\_\_\_\_  
(Principal Secretary)

\_\_\_\_\_  
(Principal)

(SEAL)

BY: \_\_\_\_\_

\_\_\_\_\_  
(Witness to Principal)

\_\_\_\_\_  
(Address)

\_\_\_\_\_  
(Address)

\_\_\_\_\_  
(Surety)

ATTEST:

BY: \_\_\_\_\_  
(Attorney-in-Fact) and Resident Agent

\_\_\_\_\_  
(Attorney-in-Fact)

(SEAL)

\_\_\_\_\_  
(Address)

\_\_\_\_\_  
(Witness as to Surety)

\_\_\_\_\_



REFERENCES FORM: ITB #2024-011

BIDDERS MUST RETURN THIS FORM WHICH WILL BE ADDED TO SUBMITTED PROPOSAL  
Please complete this form and return as part of your bid package when it is submitted.

Name of Bidder \_\_\_\_\_

**REFERENCE #1**

Contact Name: \_\_\_\_\_

Contact Number: \_\_\_\_\_

Brief Description of work provided: \_\_\_\_\_

\_\_\_\_\_  
\_\_\_\_\_

**REFERENCE #2**

Contact Name: \_\_\_\_\_

Contact Number: \_\_\_\_\_

Brief Description of work provided: \_\_\_\_\_

\_\_\_\_\_  
\_\_\_\_\_

**REFERENCE #3**

Contact Name: \_\_\_\_\_

Contact Number: \_\_\_\_\_

Brief Description of work provided: \_\_\_\_\_

\_\_\_\_\_  
\_\_\_\_\_

**Please complete and submit in bid package**

# Contact Information Form

Please fill out this form with the appropriate contact information for your company.

Full Legal Name of Company: \_\_\_\_\_

Date: \_\_\_\_\_

Contractor Information:

Primary Contact Person: \_\_\_\_\_

Title: \_\_\_\_\_ Telephone Number: \_\_\_\_\_

E-mail Address: \_\_\_\_\_

Secondary Contact Person: \_\_\_\_\_

Title: \_\_\_\_\_ Telephone Number: \_\_\_\_\_

E-mail Address: \_\_\_\_\_

Preferred Contact for Administration: (i.e. Document Processing) (Choose one)

Primary Contact

Secondary Contact

Address: \_\_\_\_\_

City / State / Zip: \_\_\_\_\_

Mailing Address (If different than above): \_\_\_\_\_

City / State / Zip: \_\_\_\_\_

Federal Employee ID Number (FEIN): \_\_\_\_\_